

# WOODBIDGE<sup>®</sup>

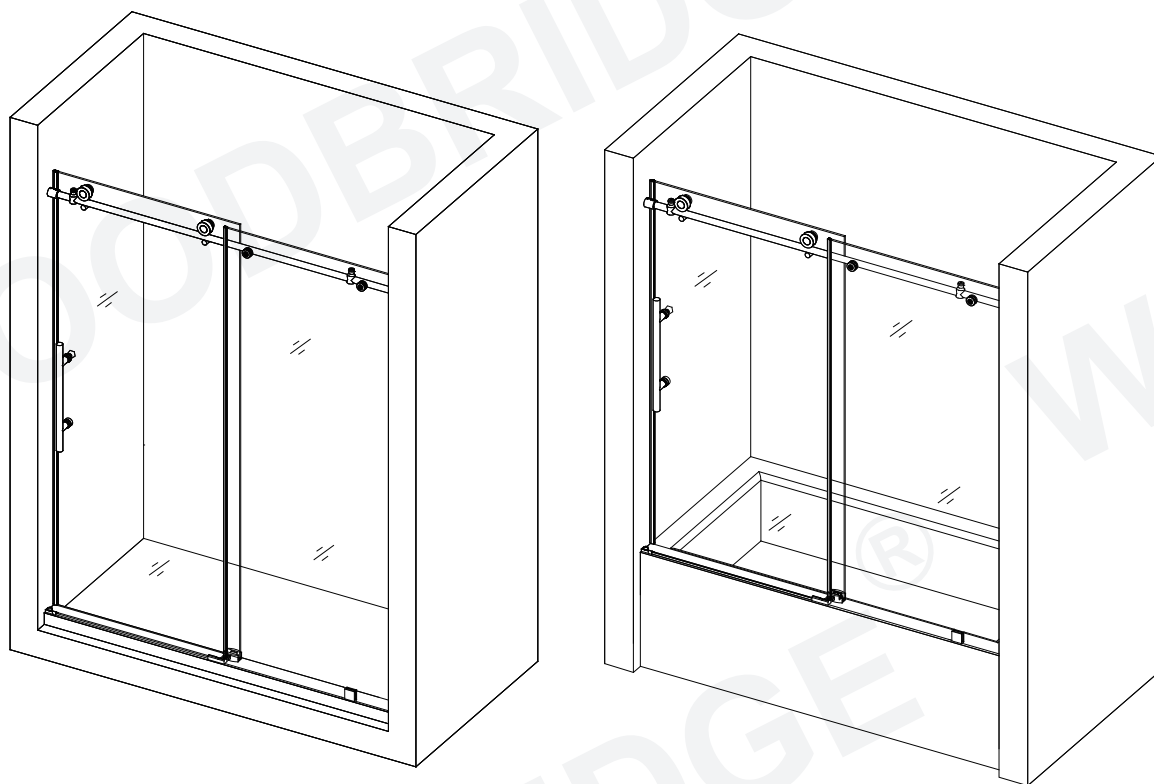

## INSTALLATION INSTRUCTIONS

SHOWER DOORS • TUB DOORS

### MODELS:

SHOWER DOORS: MBSDC4876  
MBSDC6076

TUB DOORS: MBTDC6062

Customer Service Phone: 562-774-2284. (Monday - Friday 9 AM - 5 PM Pacific Time)

Or Email: [help.woodbridge@gmail.com](mailto:help.woodbridge@gmail.com)

0100718 REV. 1

## PREPARATION

1. WE STRONGLY RECOMMEND THAT A LICENSED AND INSURED PROFESSIONAL CONTRACTOR TO INSTALL THIS PRODUCT INCLUDING THE ASSISTANCE OF A SECOND PERSON DURING INSTALLATION.
2. After opening all boxes and packages, read this introduction carefully. Check that all of the needed parts are included in the package by marking all the components on the "Detailed Diagram of Shower Door Components". Examine boxes and packages for shipping damage. If the unit has been damaged, has a finishing defect, or is missing parts, please contact our customer support department to be served immediately. Please note that Woodbridge will not replace any damaged products or missing parts free of charge after 5 business days or if the product has been installed. Feel free to contact Woodbridge if you have any questions.  
VERY IMPORTANT: Please double check the glass corner and four edges of the glass door and fixed panel to make sure that all the glass are in perfect condition and without any breakage. Please do not try to install the shower door, if there is breakage to the glass corner.
3. Please note that you should consult your local building codes with questions on installation compliance standards. Building and plumbing codes may vary by location, and Woodbridge is not responsible for code compliance standards for your project and will not accept any returns.
4. Prior to installation, ensure that the installation surface is leveled and solid and will be able to support the total weight of the unit. Also, make sure the walls are at the right angles. Irregular installation surface level or improper angle of side walls will result in serious problems during installation. Please, note that some adjustments and drilling might be necessary during the installation process.
5. **NOTE!** This door does not have out-of-plumb adjustment. Make sure your walls are at right angles.
6. This door requires a minimum 2 3/4" wide threshold, base or installation space. Please note that Step 6 calls for installation of the door to the wall using anchors. However, the manufacturer strongly recommends installing these heavy doors to the studs or to preinstalled 2" x 4" wood reinforcements behind the wall and attach the Wall brackets to it.

**ATTENTION: THIS DOOR IS EXTREMELY HEAVY AND REQUIRES PROFESSIONAL INSTALLATION. INSTRUCTIONS ARE GIVEN FOR THE SHOWER DOOR INSTALLATION. PLEASE, FOLLOW THE SAME INSTRUCTIONS TO INSTALL THE TUB DOOR. INSTRUCTIONS THAT, IF IGNORED, COULD RESULT IN DEATH OR SERIOUS PERSONAL INJURY CAUSED BY INCORRECT HANDLING OR INSTALLATION OF THE PRODUCT. THESE INSTRUCTIONS MUST BE OBSERVED FOR SAFE INSTALLATION.**

## TOOLS REQUIRED



Soft Cloth  
or Blanket

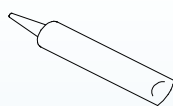

Caulk

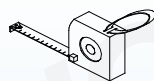

Tape  
Measure

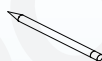

Pencil

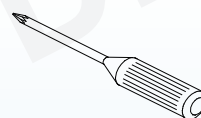

Phillips  
Screwdriver



Drill Bit  
(Ø=5/16")



Drill Bit  
(Ø=3/8")



Safety Glass

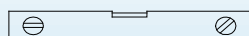

Level

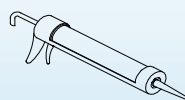

Caulk Gun

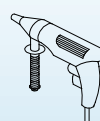

Drill

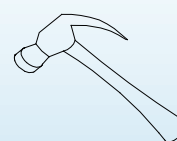

Hammer

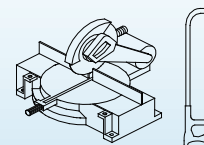

Mitter Saw  
or Hacksaw

**OTHER TOOLS MAY BE REQUIRED**

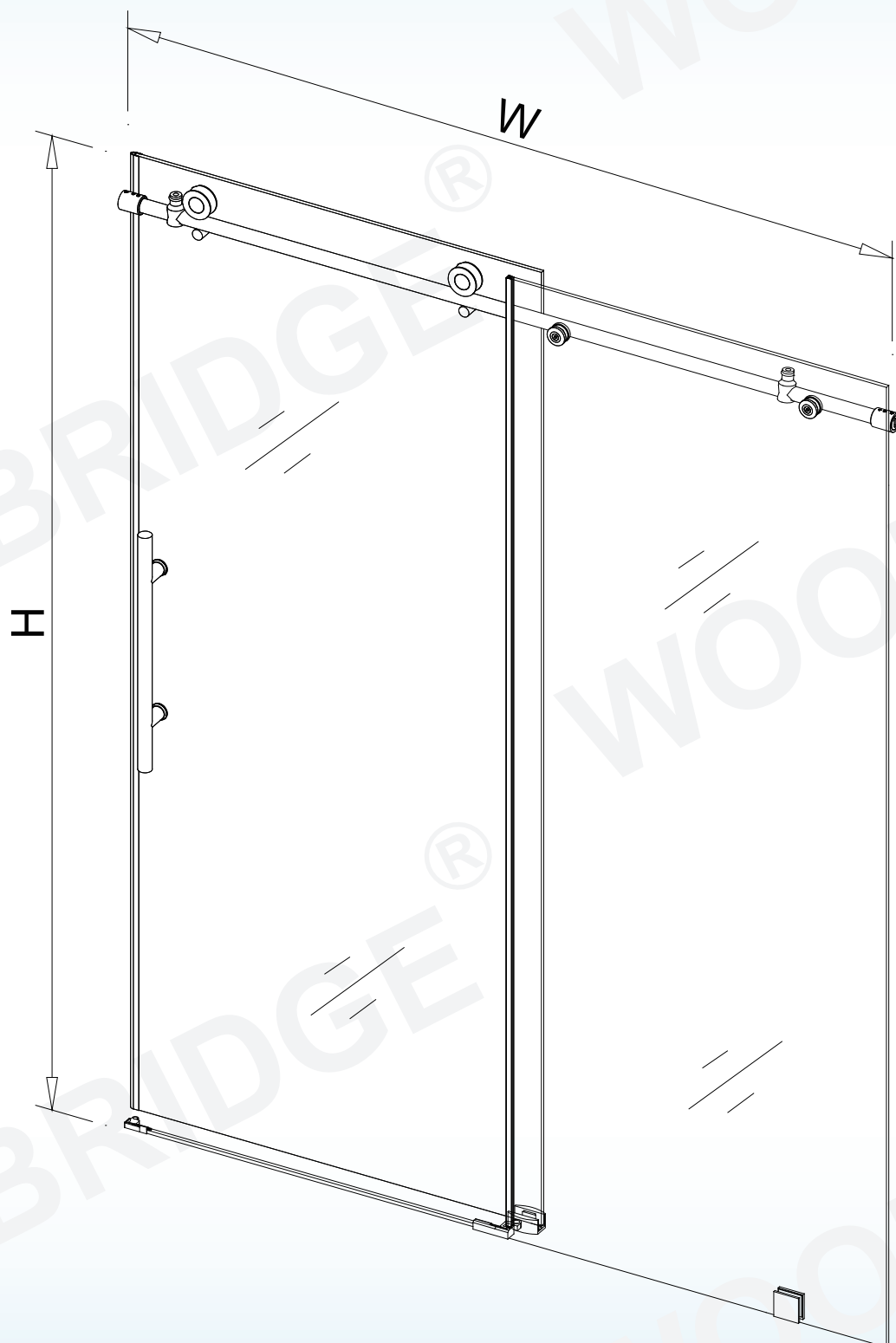

Threshold Requirement (Size): 2 3/4"

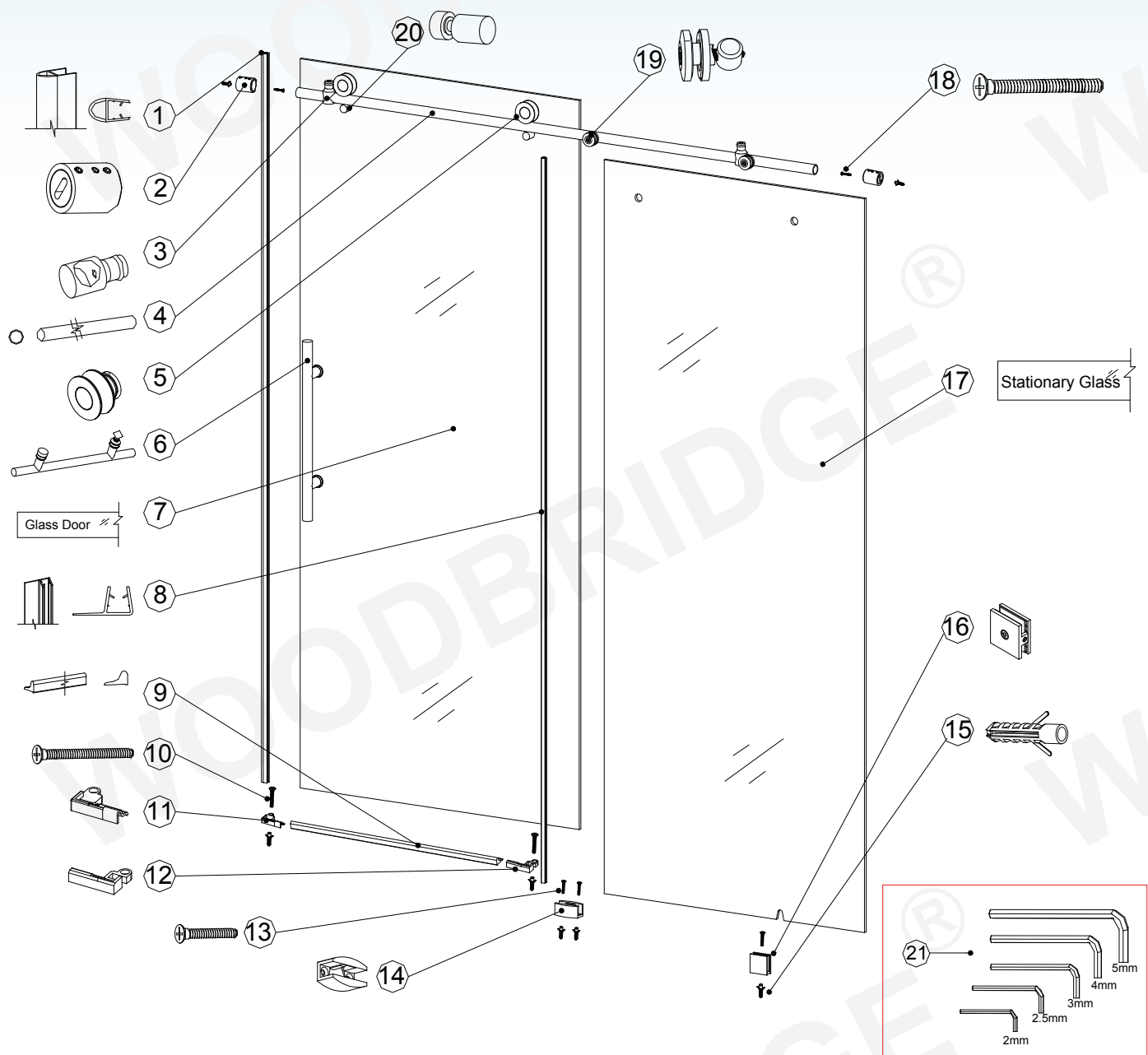

No.	Description	QTY	No.	Description	QTY
1	Bumper Strip	1 pc	12	Aluminum Cover-Right	1 pc
2	Guide Rail Bracket	2 pcs	13	Screw M5X30	2 pcs
3	Glass Door Stopper	2 pcs	14	Guide Block	1 pc
4	Upper Guide Rail	1 pc	15	Wall Anchor	7 pcs
5	Roller	2 pcs	16	Bottom Clamp	1 pc
6	Handle	1 pc	17	Stationary Glass	1 pc
7	Glass Door	1 pc	18	Screw M5X60	2 pcs
8	Side Anti-Water Strip	1 pc	19	Glass Bracket	2 pcs
9	Anti-splash Threshold	1 pc	20	Safety Pin	2 pcs
10	Screw M4X30	3 pcs	21	Allen Key	5 pcs
11	Aluminum Cover-Left	1 pc	22		

NOTE:

01:

Open the packaging carefully and inspect all the necessary parts using detailed diagram and component list in your manual as a reference. Before discarding the carton, check for small hardware bags that tend to fall to the bottom of the box. If any parts are damaged or missing, please contact us for replacement.

02:

Retain these installation instructions for future use if need.

1. Measure the distance between two finished walls. This distance is marked as W.

*Please see Fig 1 for details*

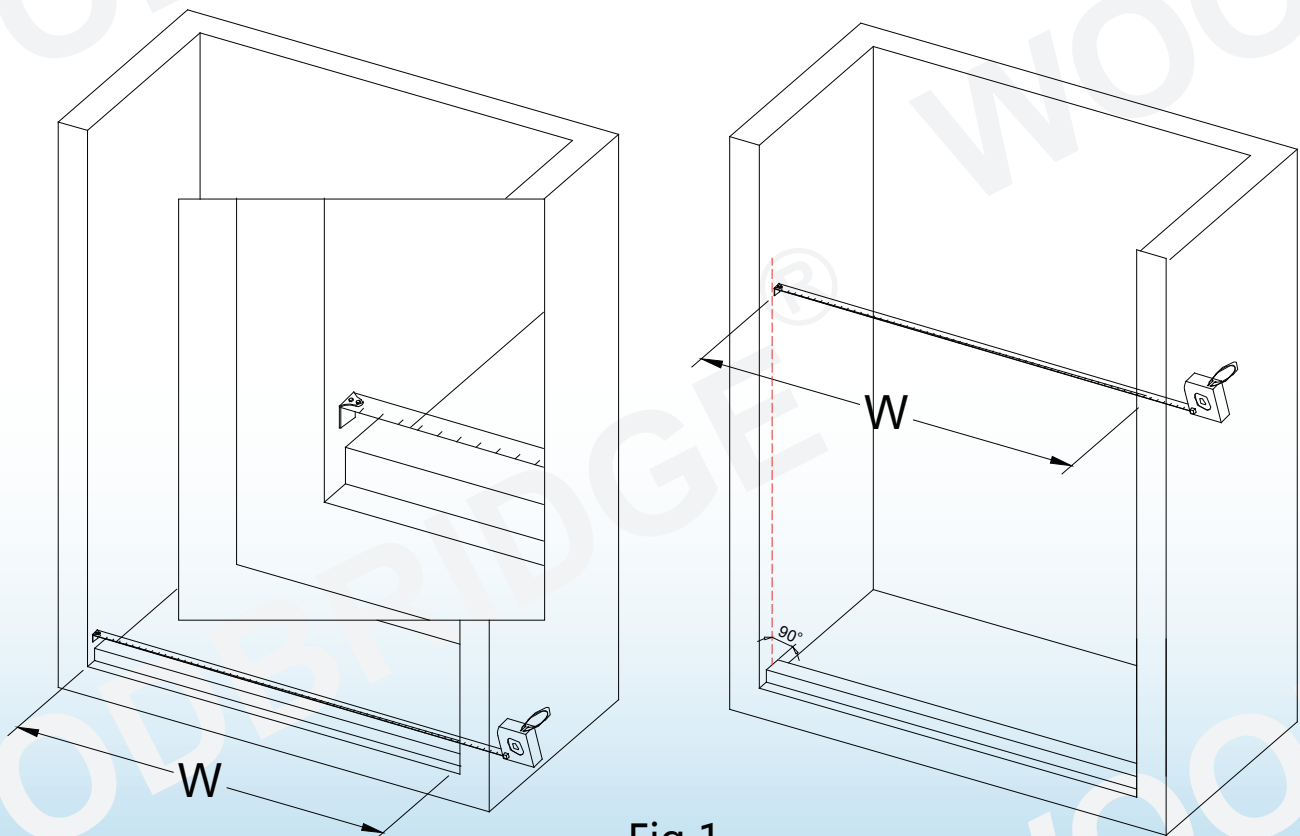
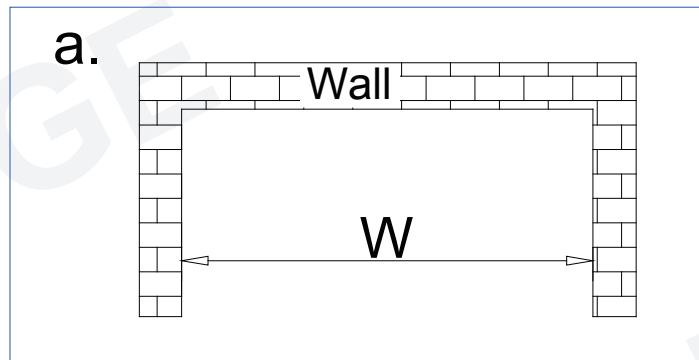
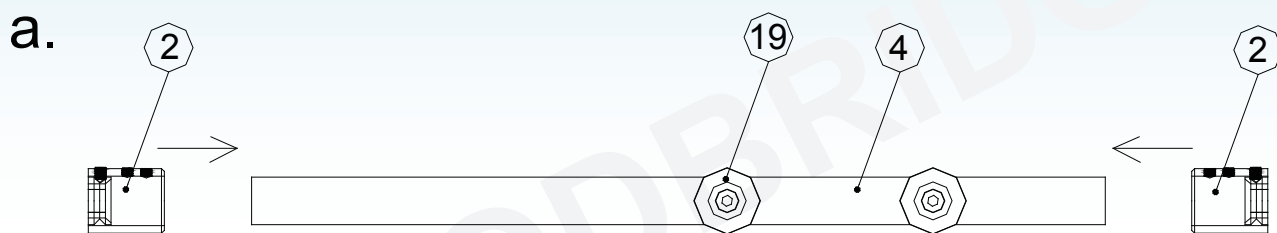
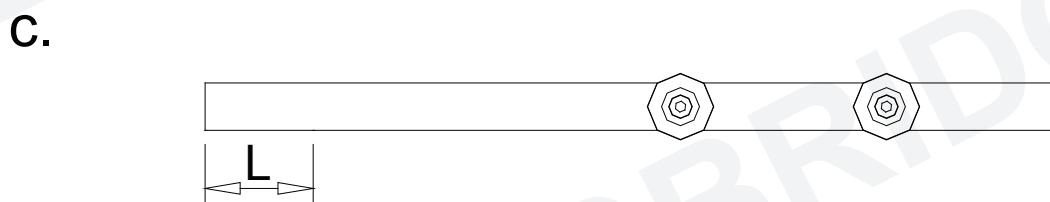
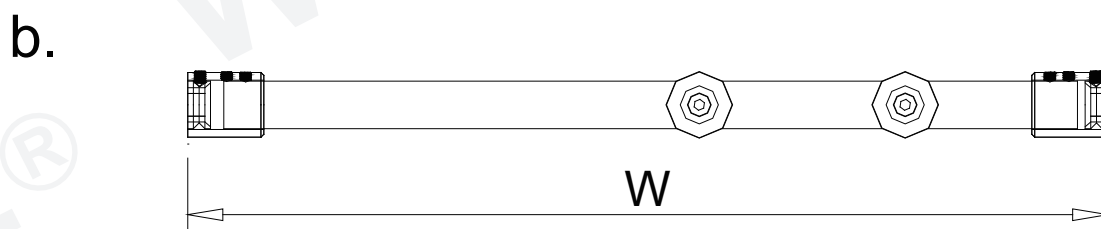

Fig 1



Note: The Glass Brackets have been pre-installed to the roller bar.



2. Your Upper **Guide Rail (04)** has been precut for your Shower model opening width: 48" or 60" for shower width.

If W-width of your wall-to-wall opening is equal to the size of your Shower model, it is unnecessary to cut the Upper Guide Rail and you can continue to Step 3.

If W-width of your wall-to-wall opening is less than the size of your Shower model, you will need to cut the Upper Guide Rail from the end which is farther from the **Glass brackets (19)** holes.

The length to cut off will be L:

$L = \text{Shower model size} - W$   
 $L = \text{Subtract } W \text{ from the size of your Shower model.}$

## FOR EXAMPLE

If your wall opening  $W=47"$ . Your shower model is 48".

$L=48"-47"=1"$ ,

You have to cut 1" off from the rail.

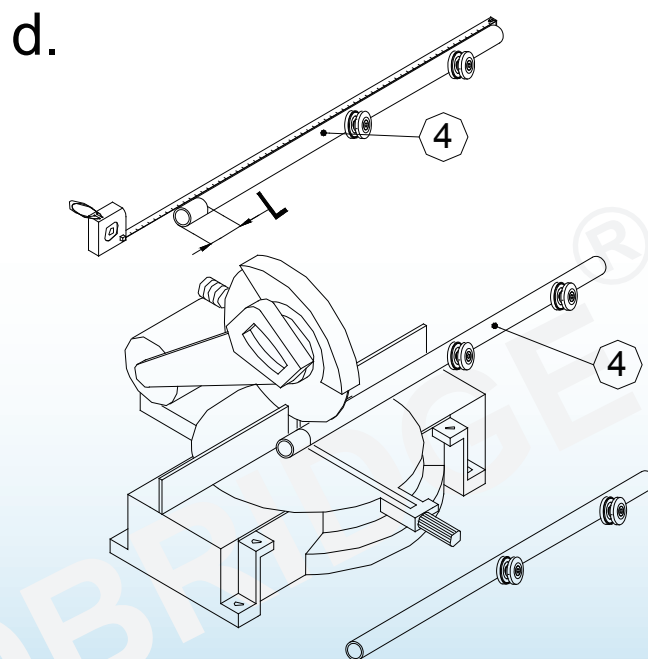

Fig 2

Please see Fig 2 for details

## 3. Install stationary glass

Loosen the screw on **Bottom Clamp (16)**. Disassemble the **Bottom Clamp** and install the it on the **Stationary Glass (17)**.

*Please see Fig 3 for details*

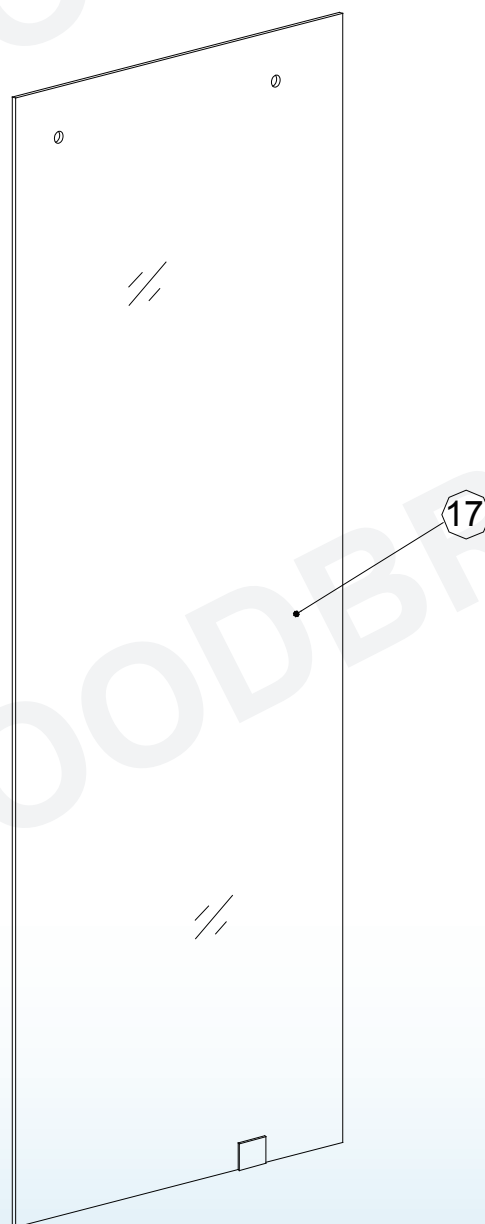
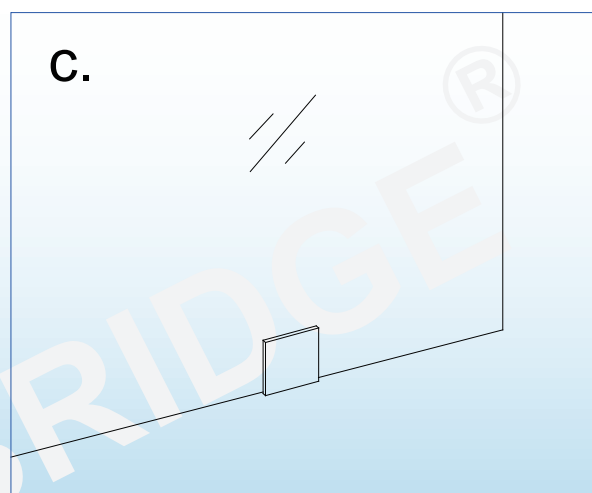
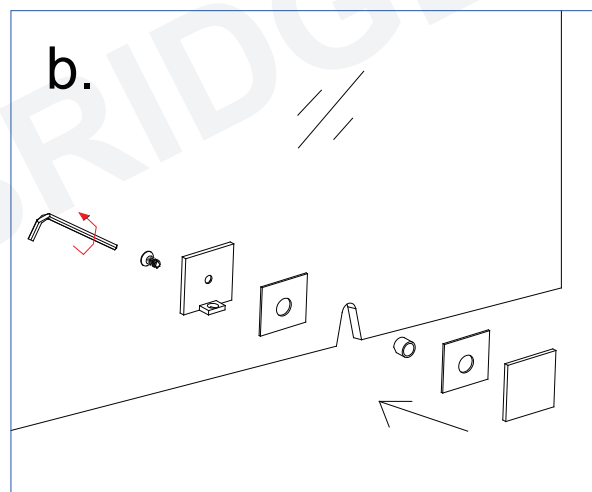
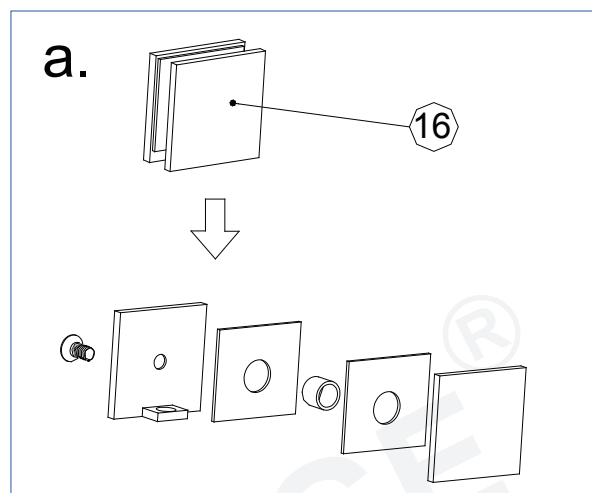

Fig 3

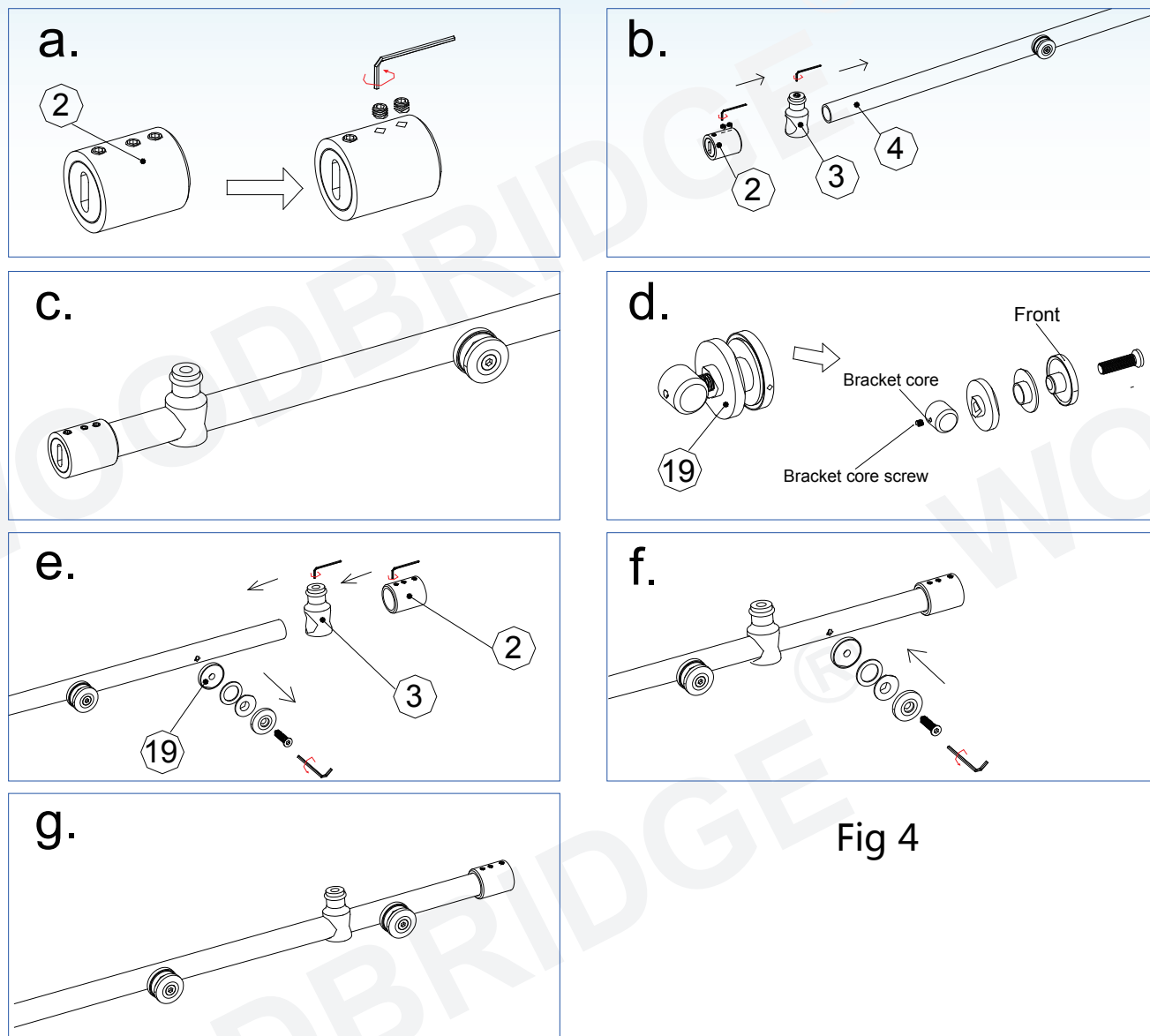
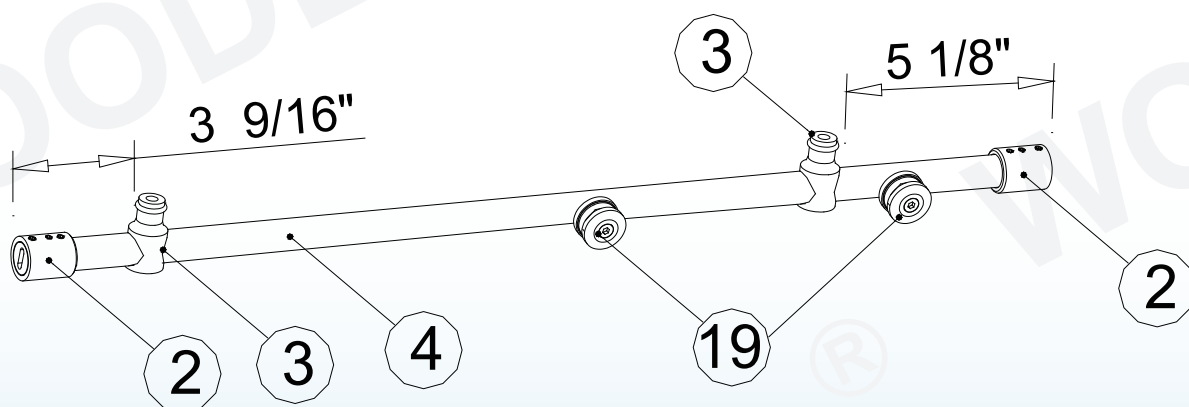

Fig 4



4. Use the allen key (21) to loose the screw on the **Guide Rail Brackets (2)** and **Glass Door Stoppers (3)**. Slide the **Glass Door Stopper (3)** and then the **Guide Rail Bracket (2)** to the **Guide Rail (4)**, use the allen key (21) to tighten the parts to the guide rail temporarily.

Please see Fig 4 for details



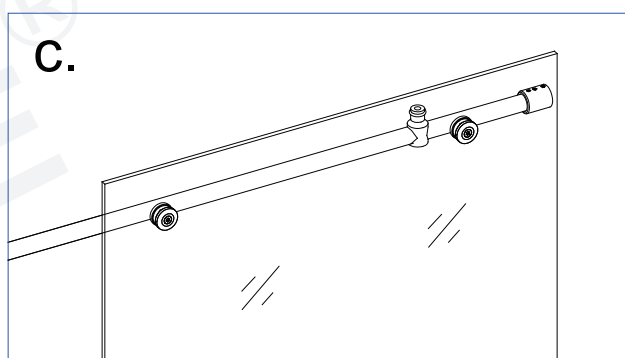
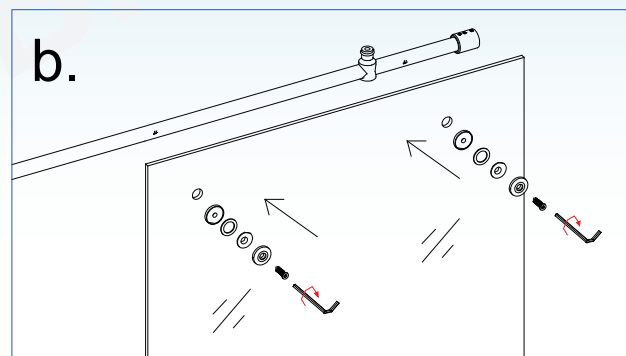
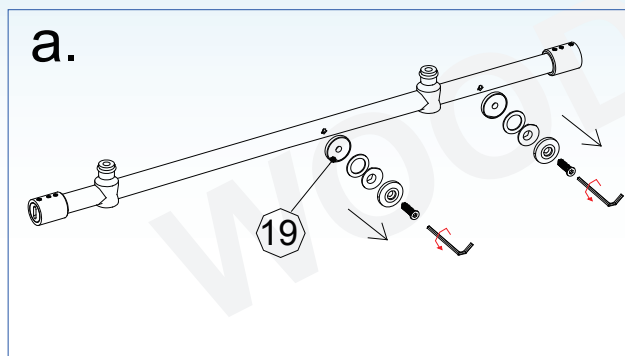

5. Loose the screws on the **Glass Bracket (19)**, align the hole of the glass bracket to the holes on the **Stationary Glass (17)**. Secure the **Upper Guide Rail (4)** to the stationary glass by fastening the screws on the glass bracket.

*Please see Fig 5 for details.*

## ATTENTION:

Never set your glass down directly onto a tile or concrete floor.  
Always use a piece of wood or cardboard and leave the corner pads on the glass until it becomes necessary to remove them to protect the bottom edge and the corners of the glass from breakage.

Fig 5

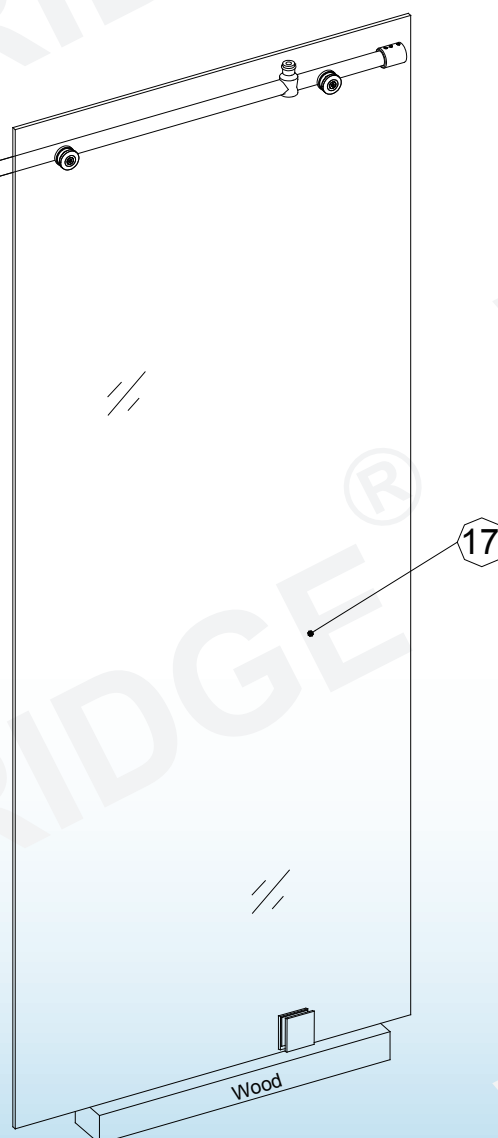

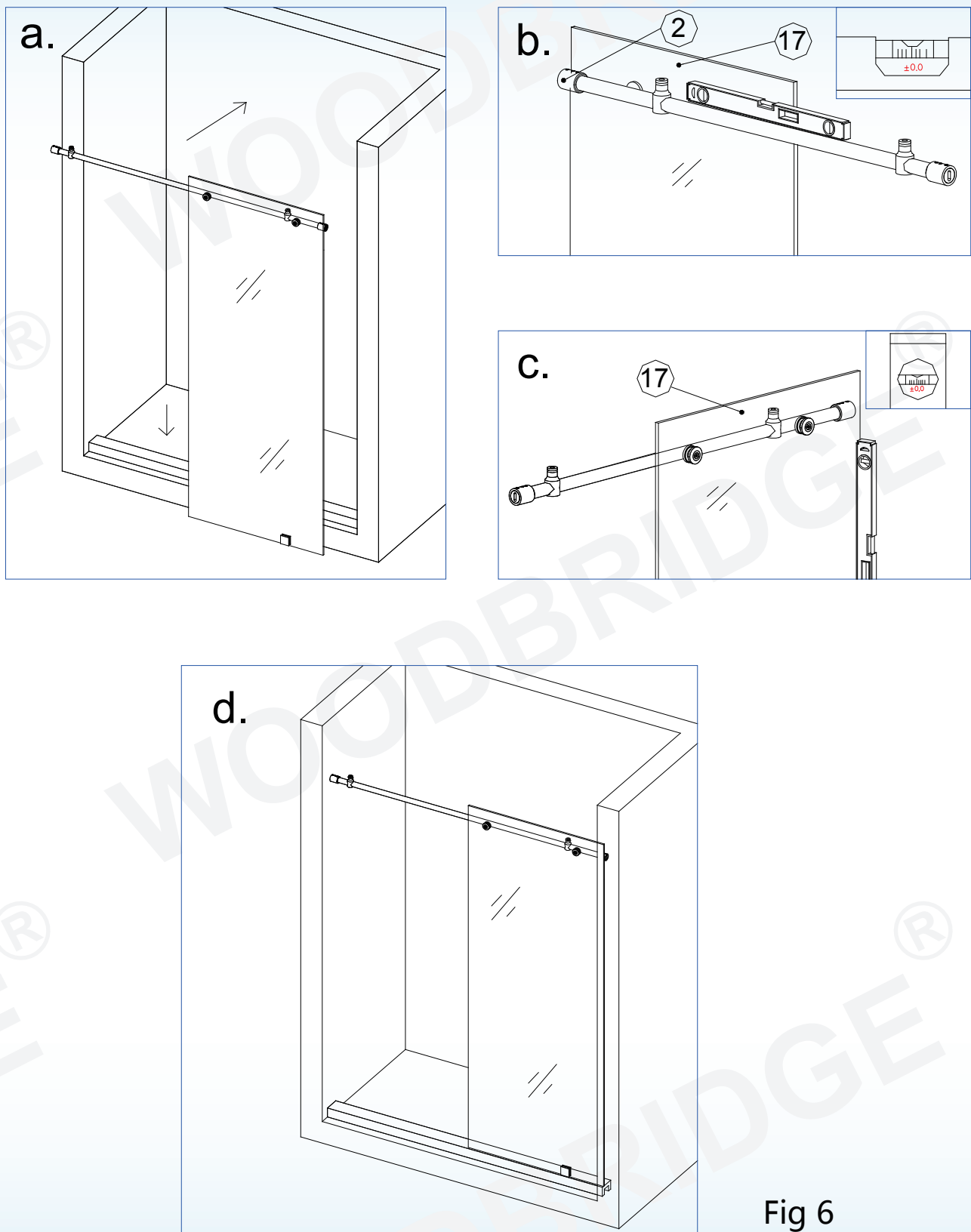
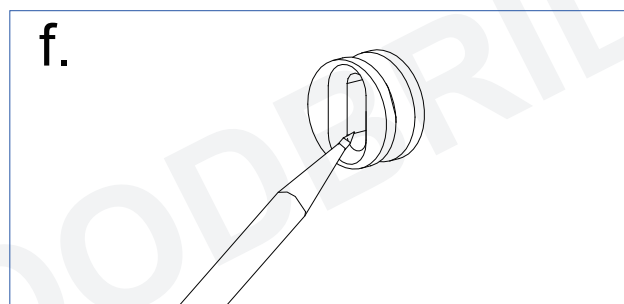
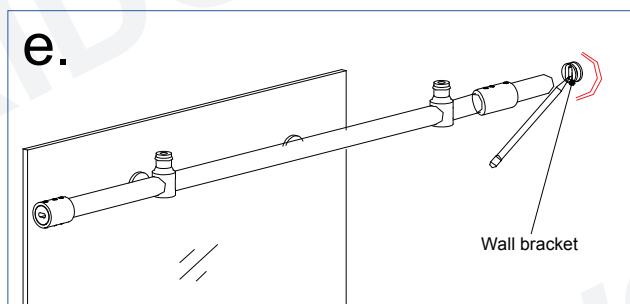
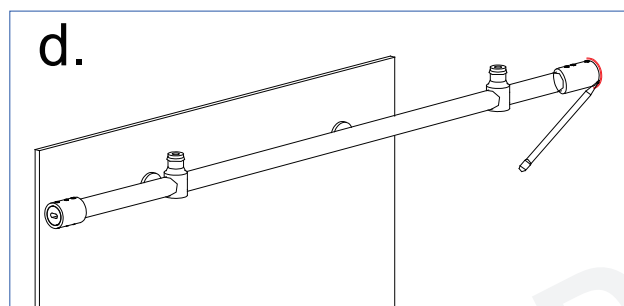
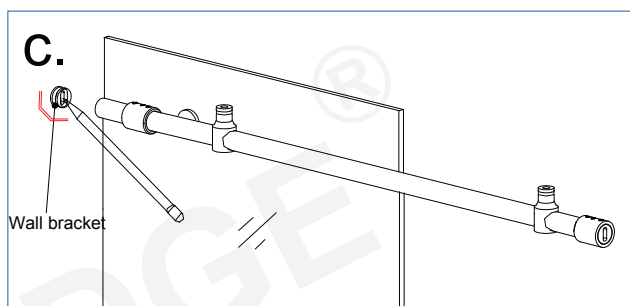
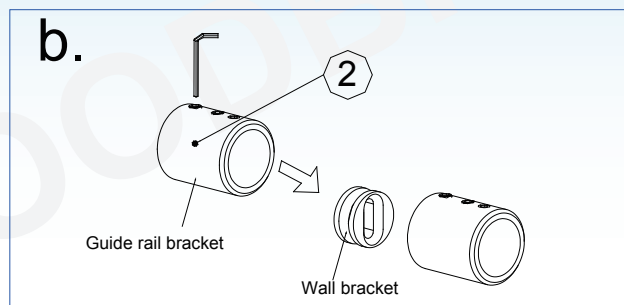
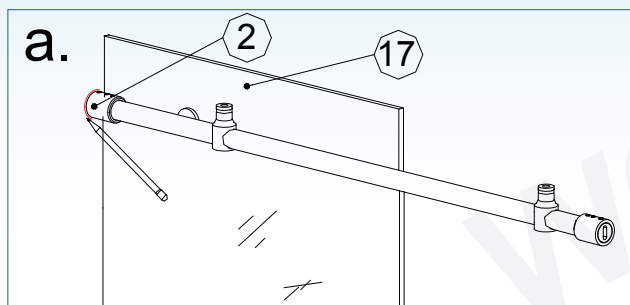

Fig 6

6. Place the **Stationary Glass (17)** against the wall. Make sure the stationary glass and the Upper Guide Rail (4) are leveled.

*Please see Fig 6 for details.*



7. Slide the **Guide Rail Bracket (2)** against the wall, outline the guide rail brackets position on the wall. Set the **Stationary glass (17)** aside. Remove the wall bracket from the guide rail bracket and place them to the outlined positions and mark the drilling holes on the wall. Outline the position of the **Bottom Clamp (16)** on the base. Set the **Stationary glass (17)** aside. Loosen the screw on bottom clamp. Remove the clamp from the Stationary glass and place it back to the outlined positions, now mark the drilling holes on the threshold.

Please see Fig 7 for details

Fig 7

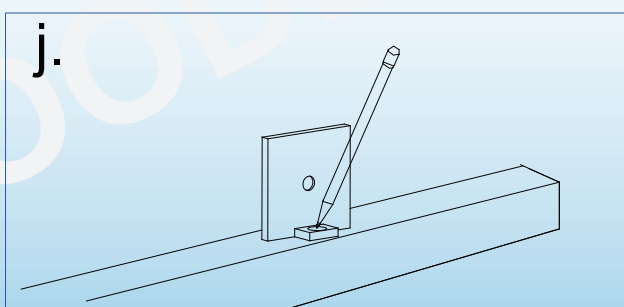
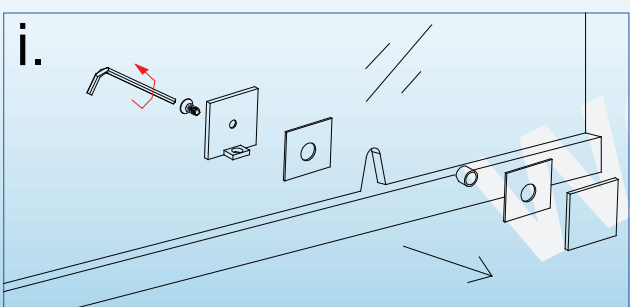
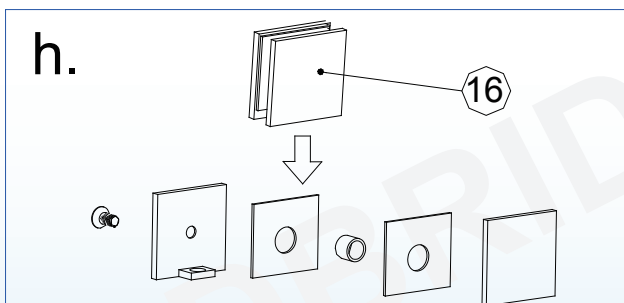
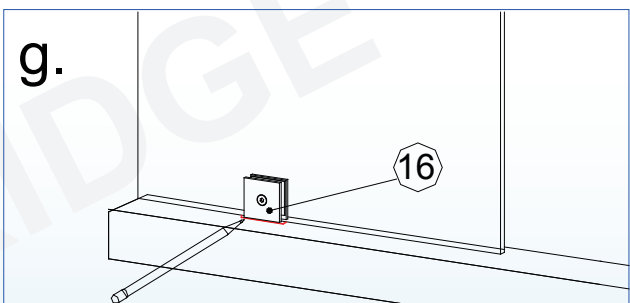

8. Drill the holes to the wall per the predrilled position using 8mm( $\phi$ 5/16") drill bit and Apply silicone into the holes, insert the **Wall anchors (15)** for the Guide Rail Bracket. Mount the Wall Bracket of the **Guide Rail Bracket (2)** to the wall by using the **Screws M5×60 (18)**. Drill the holes to the threshold ....

Please see Fig 8 for details

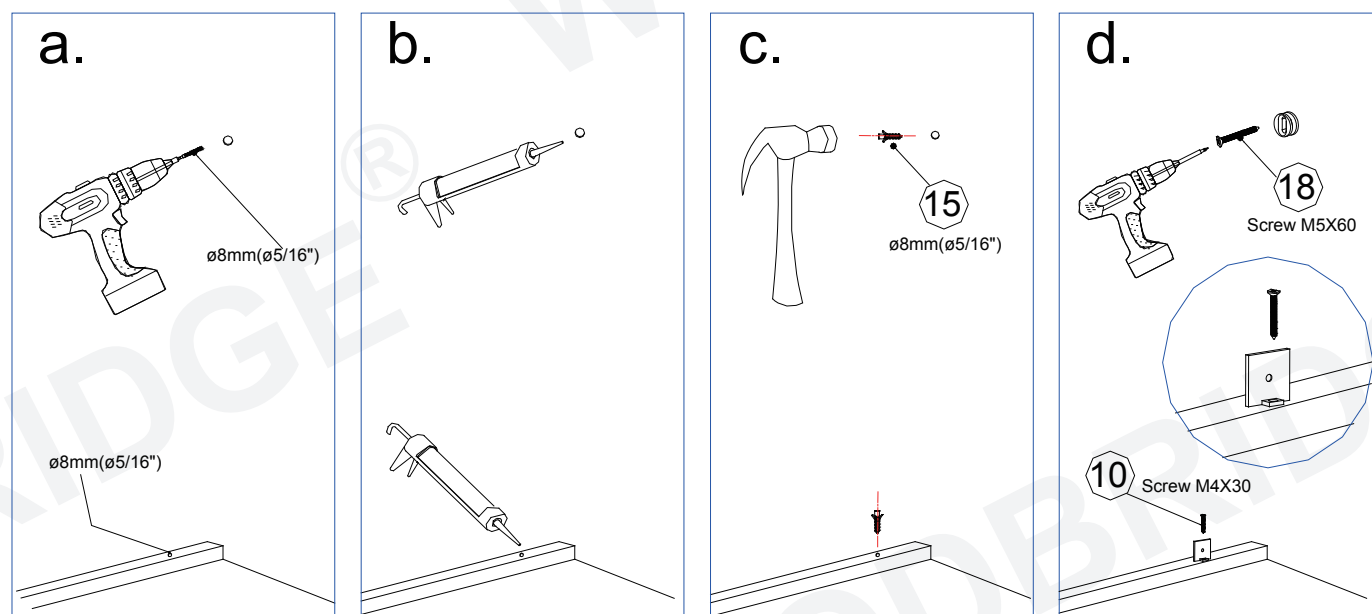

Note:

The other side of the **Guide Rail bracket (2)** is installed in the same way.

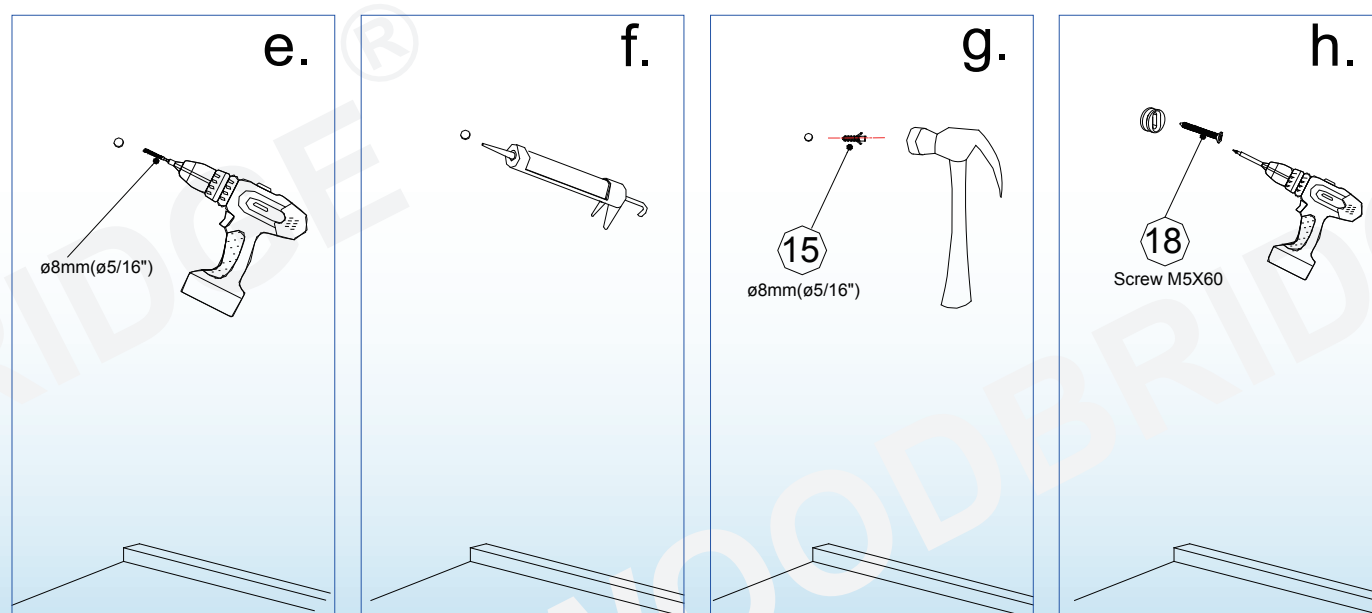

Fig 8

9. Place the **Stationary glass (17)** back into the designated position. Slide the **Guide Rail Bracket (2)** to the two end sides of the **Upper Guide Rail(4)**. Tighten the set screws on the **Guide rail bracket (2)** with **Allen Key (21)** to secure the guide rail to the wall. Install the **Bottom Clamp (16)** back to the stationary glass.

Please see Fig 9 for details

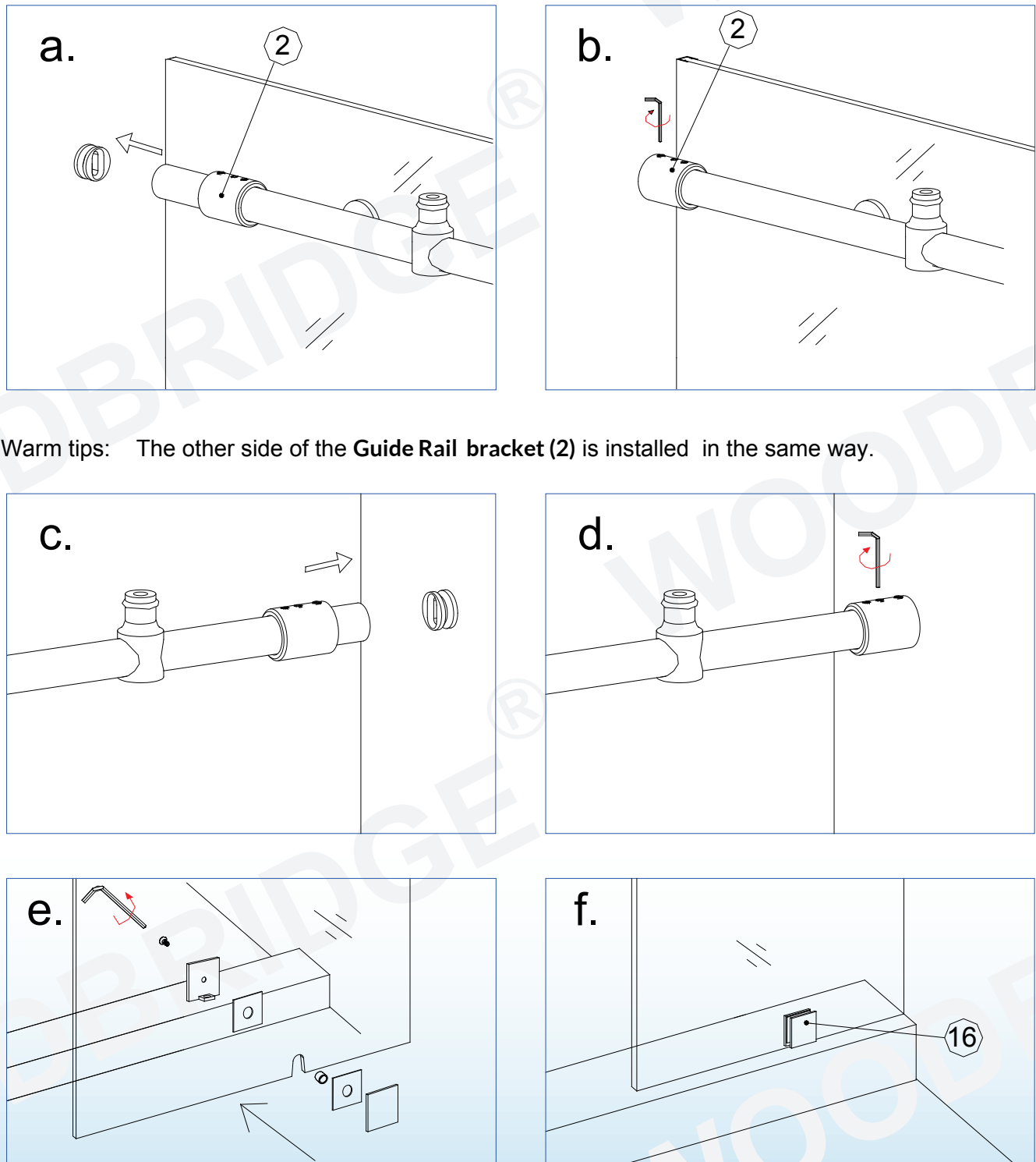
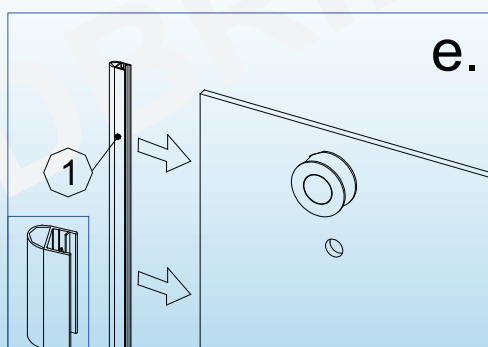
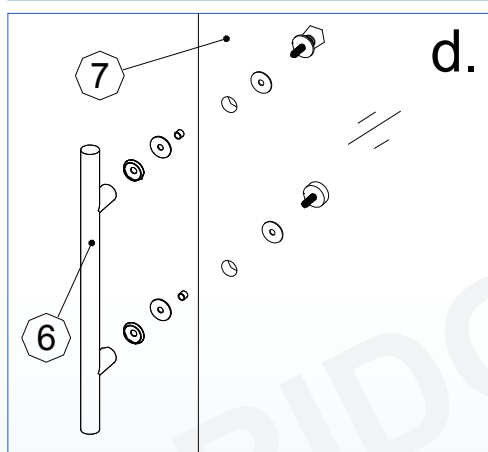
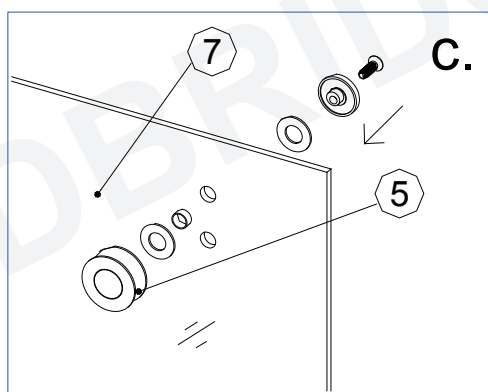
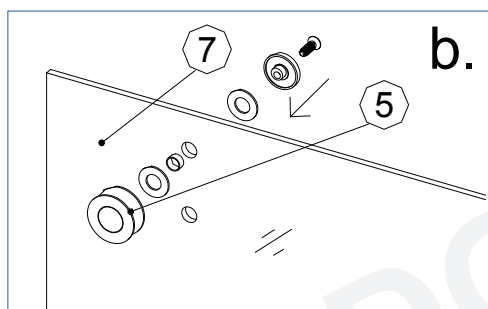
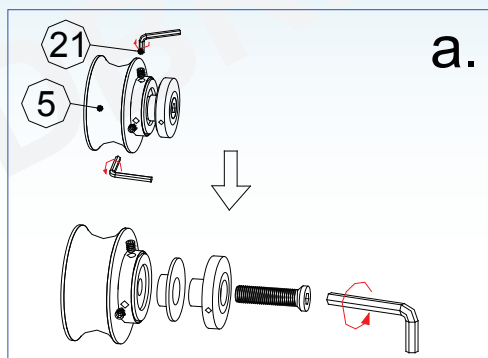

Fig 9



Attention: Need to loosen the small allen screws before loosening the long allen screw on the roller

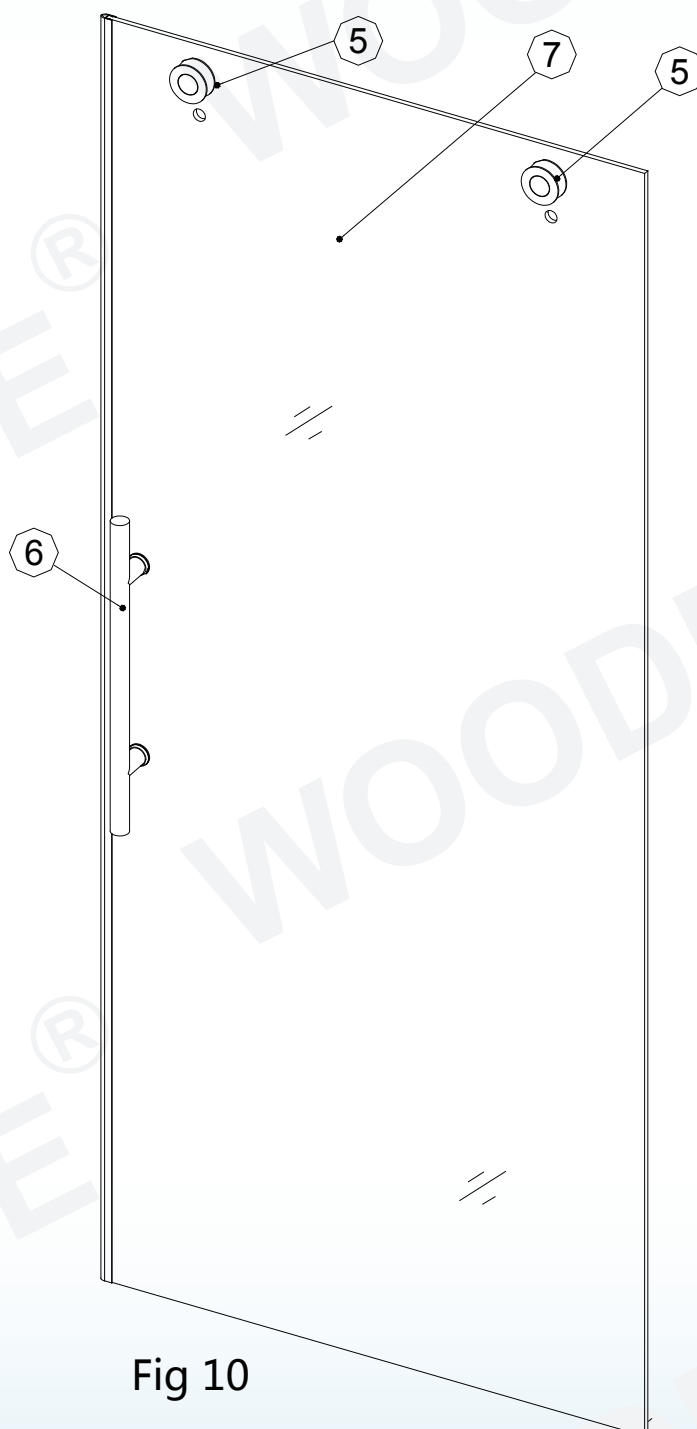

Fig 10

10. Install Glass Door Loosen the **Rollers (5)** screws and the Install the rollers. And then Install **Handle (6)** and **Bumper Strip (1)** to the door.

Please see Fig 10 for details

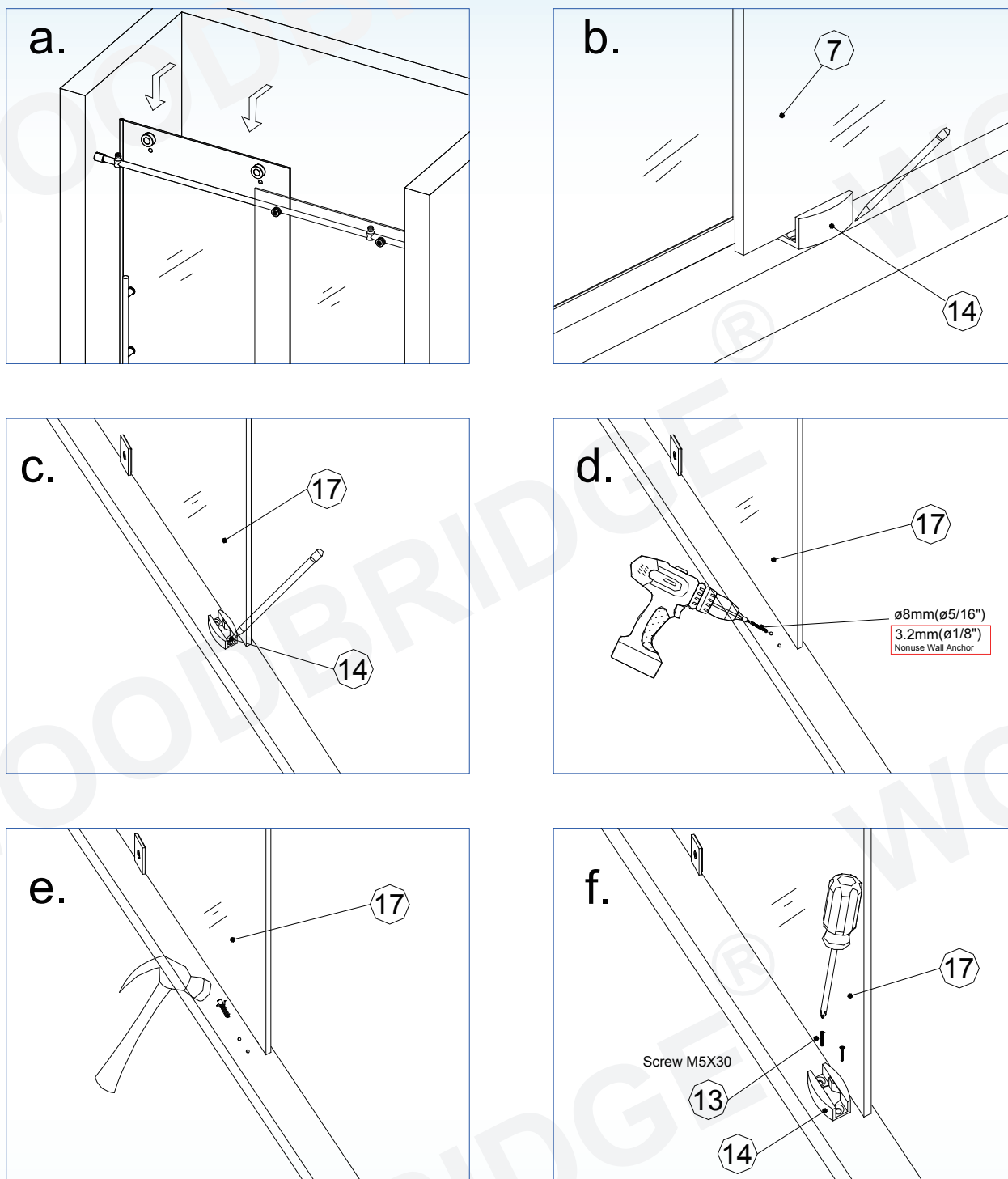

Fig 11

11. Hang the **Glass Door (7)** installed with rollers, handles and strip to the **Upper Guide Rail (4)**. Slide the **Guide Block (14)** to the bottom of the glass door. Mark down the predrilled position of the guide block. Set the glass door aside. Now drill the hole with 3.2mm( $\varnothing 1/8''$ ) drill bit to the threshold. Put the silicone to the hole and then put the **wall anchor (15)** into the hole. Now secure the guide block to the threshold with **M5x30 screw (13)**.

Please see Fig 11 for details

12. Hang the **Glass Door (7)** back to the **Upper Guide Rail (4)**, slide the bottom of the glass door into the slot of the **Guide Block (14)**. Be careful that the glass door should not touch the metal part of the guide block.

Please see Fig 12 for details

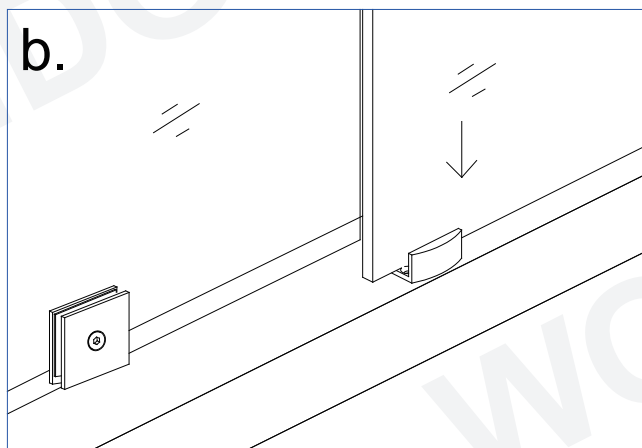
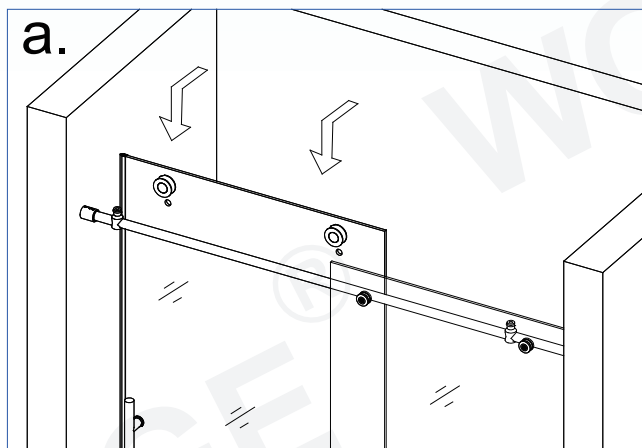
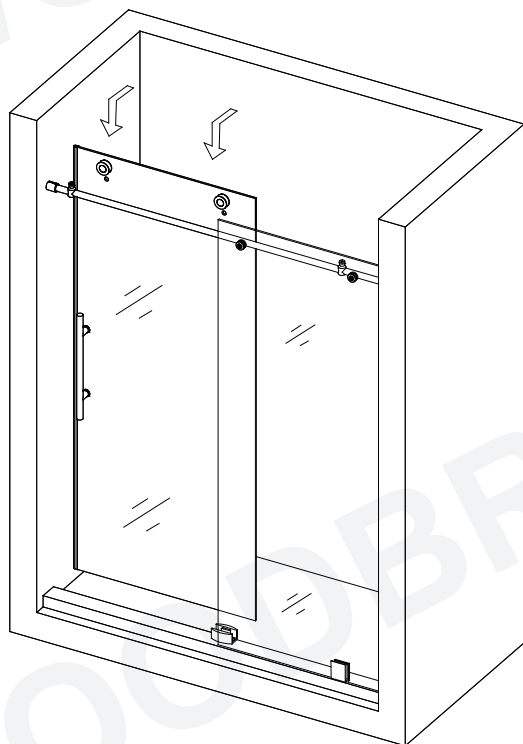

Fig 12

13. Slide the **Side Anti-Water Strip (8)** to the **Stationary Glass (17)**, remove the flapper that interferes with the **Upper Guide Rail (4)**

Please see Fig 13 for details

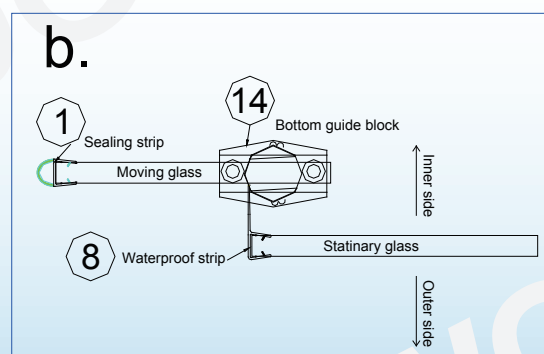
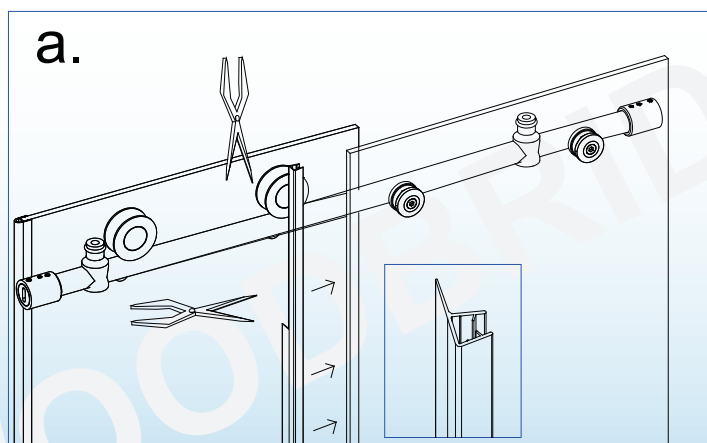

Fig 13



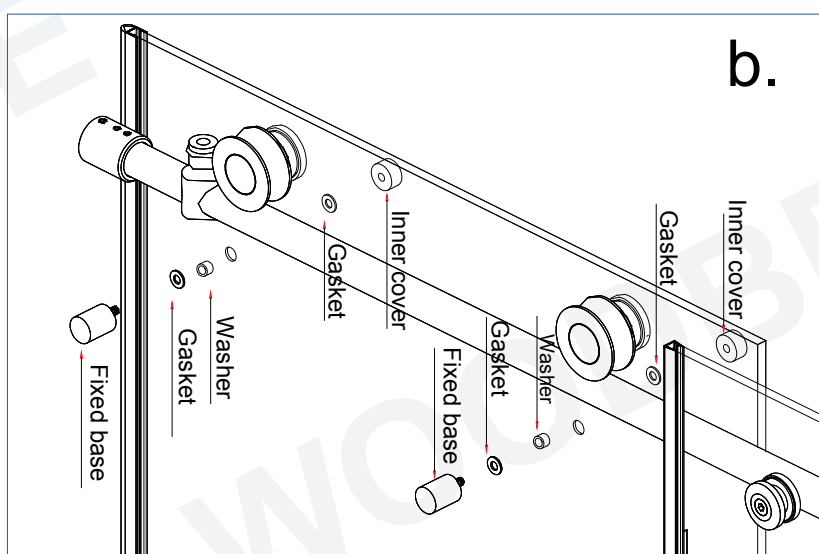
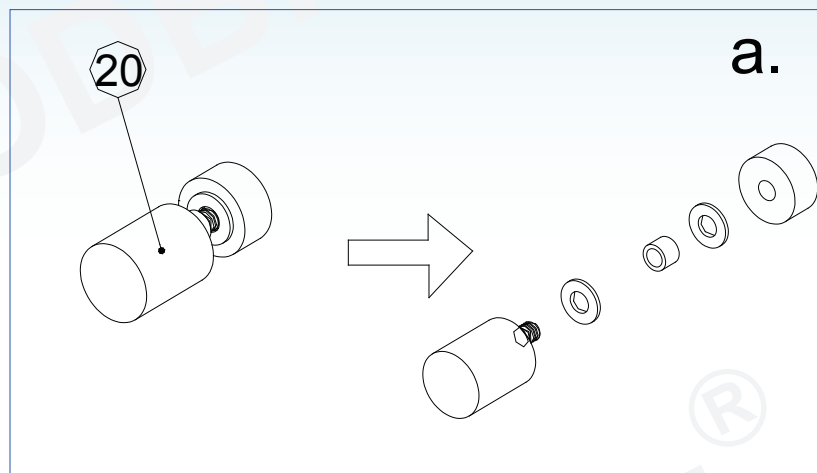
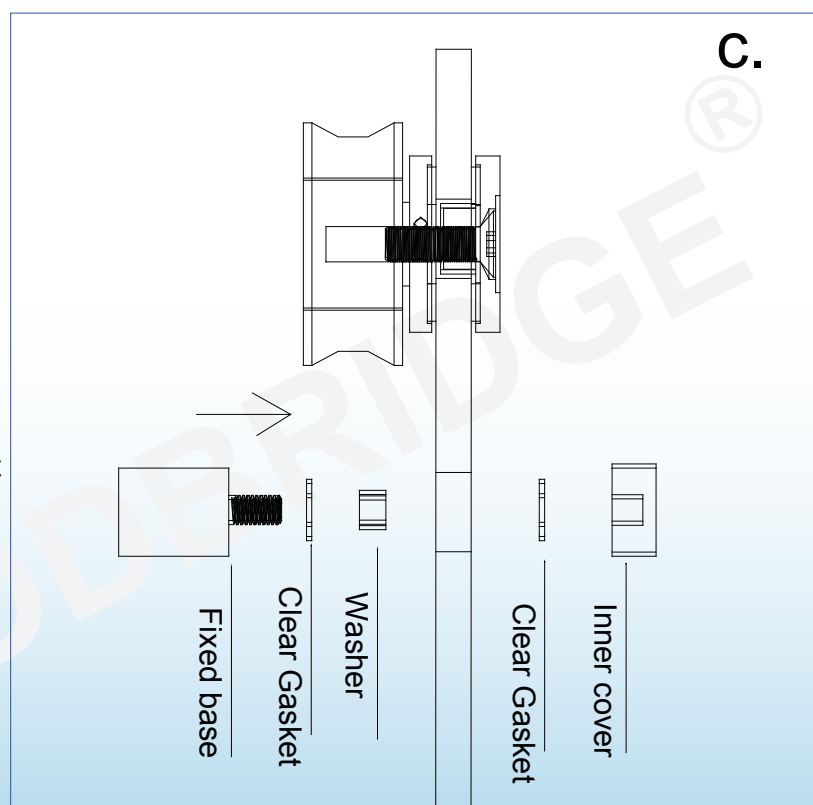

Fig 14



14. Install the **Safety Pin(20)** to the **Glass Door (7)**. Make sure that the clear gasket will be between the glass and the metal parts of the safety pin.

Please see Fig 14 for details

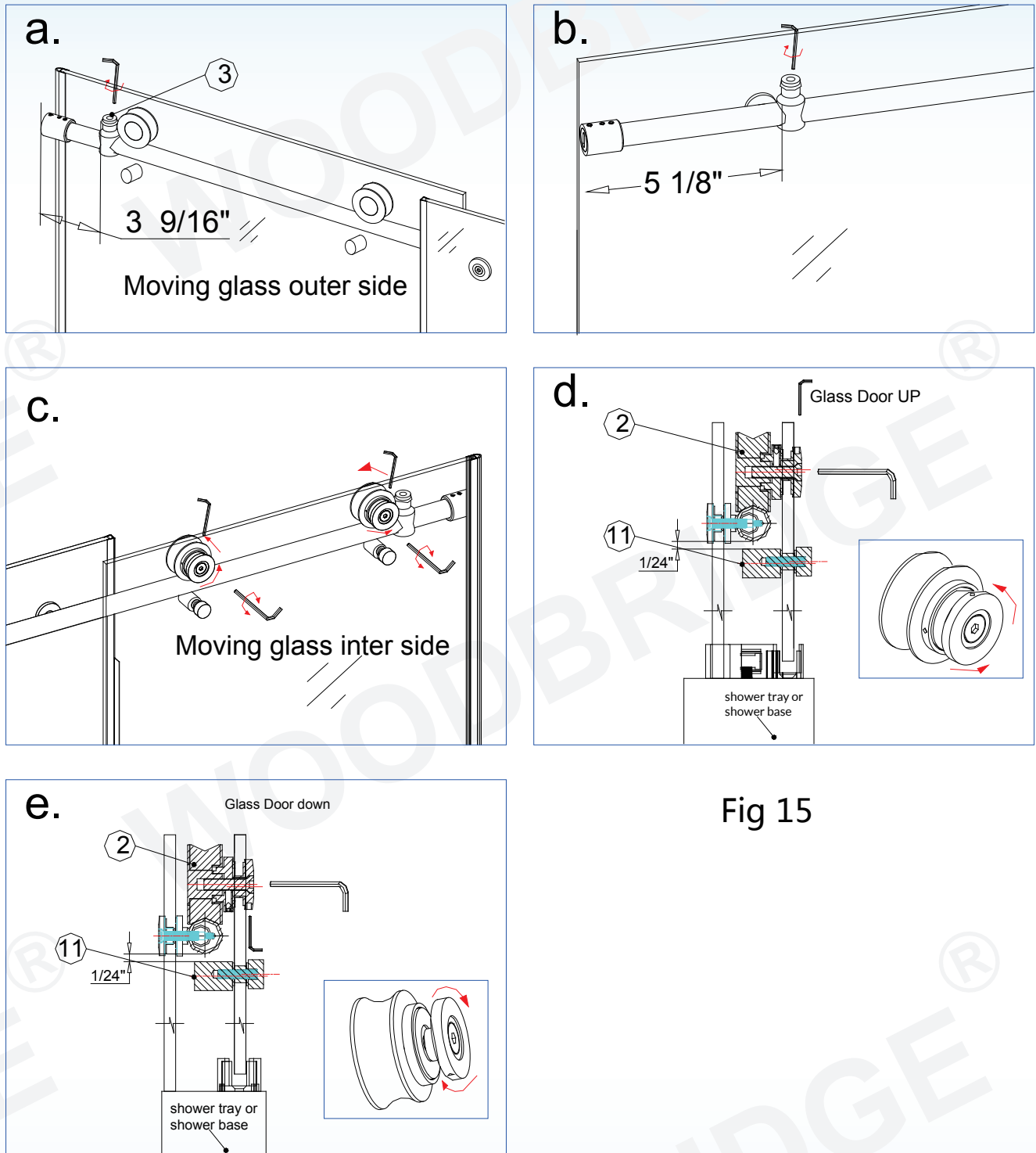

Fig 15

## 15. Adjust the **Roller(5)** and fix the **Glass Door Stopper(3)**

Adjust the fasteners on both **Rollers (5)** to ensure that the bottom edge of the **Glass door (7)** will not touch the bottom of the **guide block (10)**.

Slide the **Door Stopper (3)** close to the wall side, slide the **Glass Door(7)** to make **roller(4)** contact to the stopper and get perfect space then lock the stopper bottom screw.

Please make sure that the **Glass Door(7)** especially the door corners will not hit the walls when closed and opened

Please see **Fig 15** for details

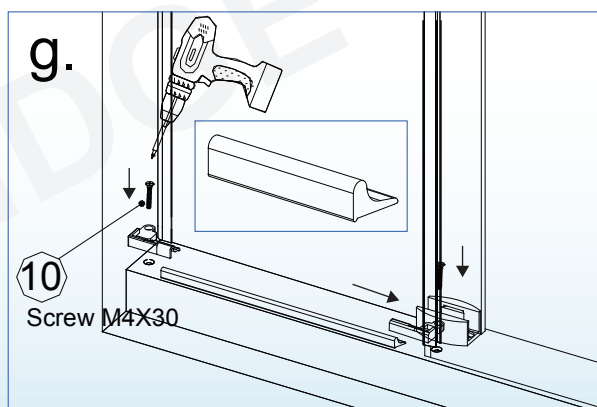
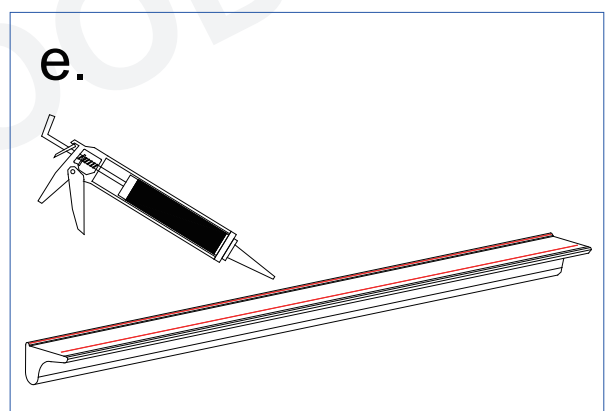
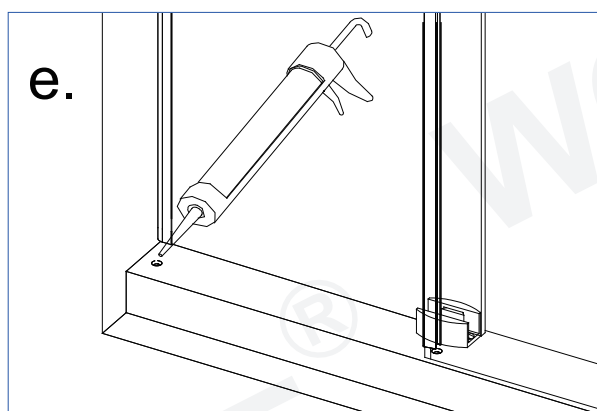
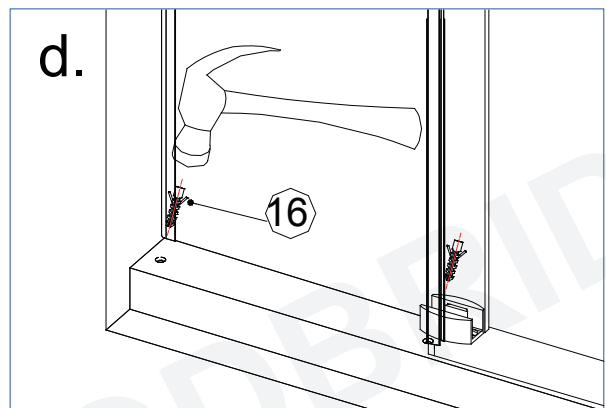
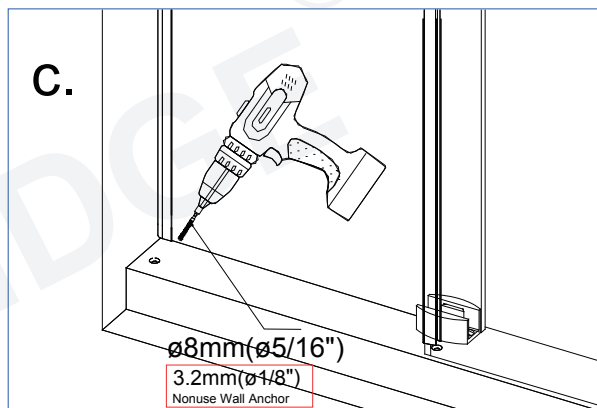
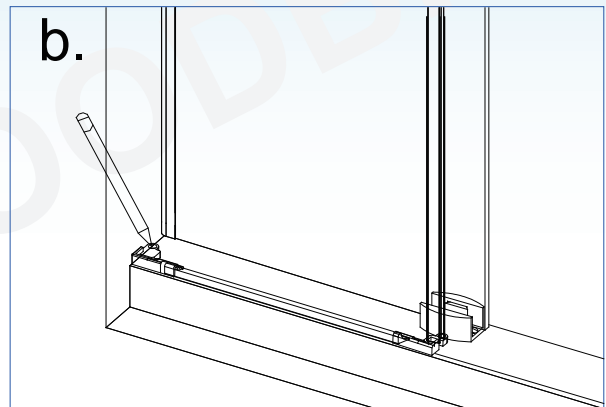
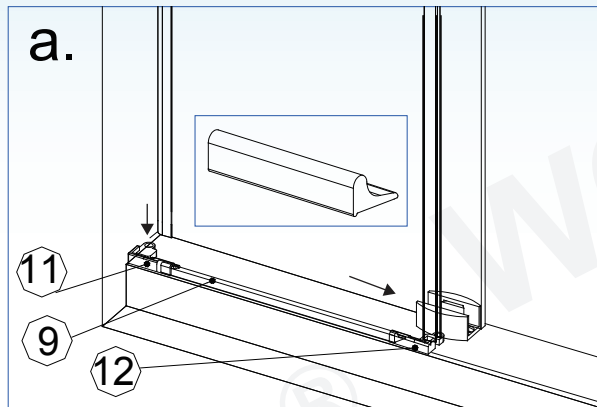

16. Install the **Anti-Splash Threshold (9)** in front of the **Glass Door (7)**. Put the Anti-splash threshold in front of the glass door, and then put the **Aluminum Cover with slot** into the **Stationary Glass (17)**, on top of the threshold.

Put the other cover to the other side. Mark down the predrilled holes on the threshold, drill the holes with 3.2mm (Ø1/8") drill bit, put the **wall anchor (15)**. Put silicone sealant to the bottom of the Anti-splash threshold, secure it to the threshold with **M4x30 Screw (10)** and put the covers back on it.

Fig 16

Please see **Fig 16** for details

17. Apply silicone sealant on the seams between the stationary glass and the shower base/bathtub, and between the wall and the stationary glass.

See **Figure 17** for details.

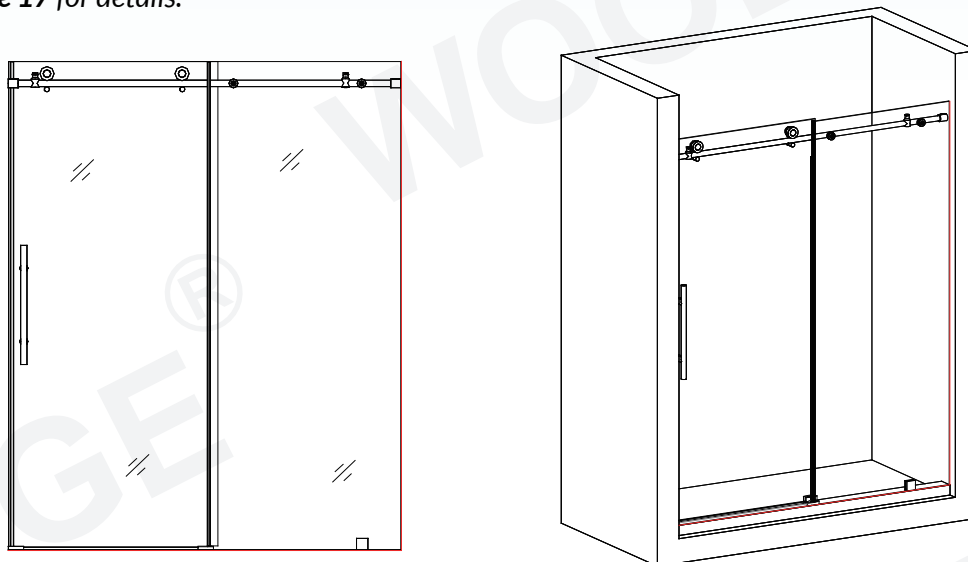

TUB DOORS **INSTALLATION the same as SHOWER DOORS**

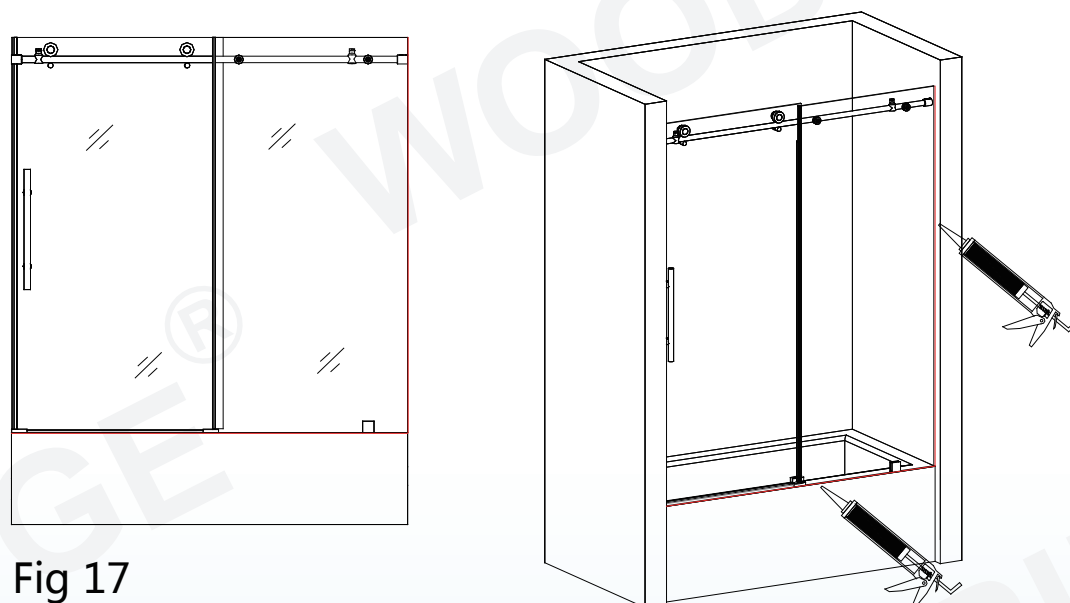

Fig 17

**MUST ALLOW SILICONE TO DRY FOR 24 HOURS BEFORE STARTING USING THE SHOWER**

Thank you for using WoodBridge products!

Please don't hesitate to contact us if you have any questions or concerns.

Customer Service Phone: 562-774-2284. (Monday - Friday 9 AM - 5 PM Pacific Time)

Or Email: [help.woodbridge@gmail.com](mailto:help.woodbridge@gmail.com)

## NOTES

---

---

---

---

---

---

---

---

---

---

## INSTALLER INFORMATION

DATE OF INSTALL:

INSTALLER'S NAME:

PLUMBER:

☐

CONTRACTOR:

☐

LICENSE #: