

Wine Rack

Ok, let's get rolling

This should be easy, just follow our simple instructions.

We recommend that it is assembled by two adults, on a carpeted or padded area, in the room that it is intended for.

Please do not throw away any of the packaging or instructions until you have checked all the components and hardware and the furniture is fully assembled.

Please keep all pieces out of reach of children.

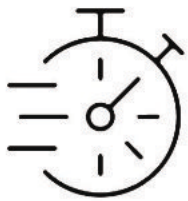

Approximate assembly time: 90 minutes.

Important:

1. Do not tighten bolts / screws completely until all bolts / screws are lined up and inserted into holes.
2. Do not over tighten screws and bolts to avoid stripping.
3. Please use hand tools to assemble this product. Do not use power tools.

What's included:

(A) 1 pcs	(H) 1 pcs	(P ₁) 1 pcs	(U) 1 pcs
(B) 1 pcs	(H ₁) 1 pcs	(P ₂) 1 pcs	(U ₁) 1 pcs
(C) 1 pcs	(I) 1 pcs	(Q) 1 pcs	(V) 2 pcs
(C ₁) 1 pcs	(I ₁) 1 pcs	(R) 1 pcs	(W) 1 pcs
(D) 1 pcs	(J) 1 pcs	(R ₁) 1 pcs	(W ₁) 1 pcs
(D ₁) 1 pcs	(J ₁) 1 pcs	(T) 1 pcs	(X) 2 pcs
(E) 1 pcs	(K) 1 pcs	(S) 1 pcs	(X ₁) 1 pcs
(F) 2 pcs	(L) 2 pcs	(S ₁) 1 pcs	(Y) 1 pcs
(G) 1 pcs	(O) 1 pcs	(S ₂) 2 pcs	(Y ₁) 1 pcs
(G ₁) 1 pcs	(P) 2 pcs	(S ₃) 2 pcs	(Y ₂) 1 pcs

(2) 44 pcs	(9) 1 pcs	(20) 2 pcs
(3) 1 pcs	(9.1) 1 pcs	(21) 5 pcs
(4) 14 pcs	(12) 3 pcs	(22) 4 pcs
(4.1) 14 pcs	(13) 8 pcs	(23) 4 pcs
(5) 14 pcs	(13.1) 8 pcs	(24) 7 pcs
(6) 12 pcs	(17) 44 pcs	
(7) 38 pcs	(18) 16 pcs	
(8) 32 pcs	(19) 12 pcs	

The goods

②



③

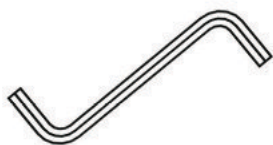

④



④.1



⑤



⑥

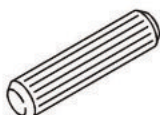

⑦



⑧

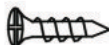

⑨

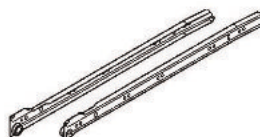

⑨.1

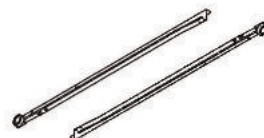

⑫



⑬

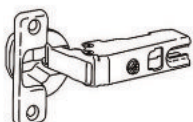

⑬.1

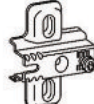

⑰



⑱



⑰



⑳

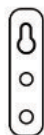

㉑

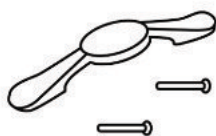

㉒

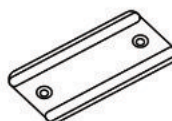

㉓

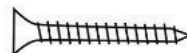

㉔



You need:

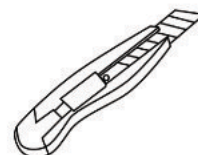
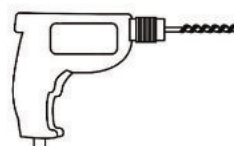
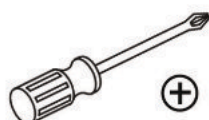
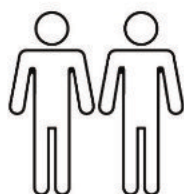

Attention!

Please take a look at the attached picture. On the top of this picture you can see part 13 and 13.1 are attached together. Please unscrew the bolt and it falls in two parts 13 and 13.1 (see bottom of the picture).

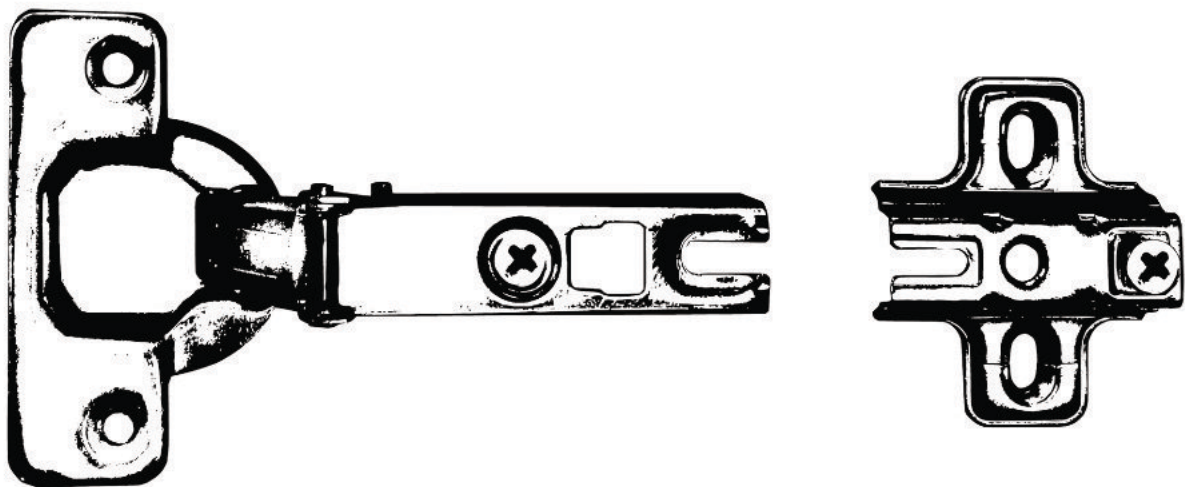
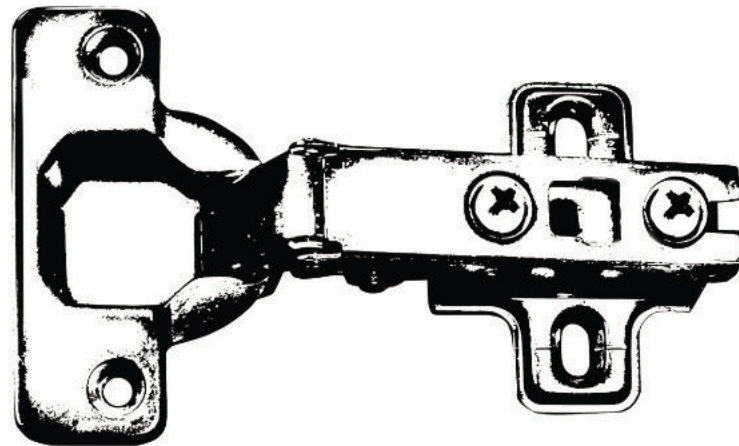

The goods

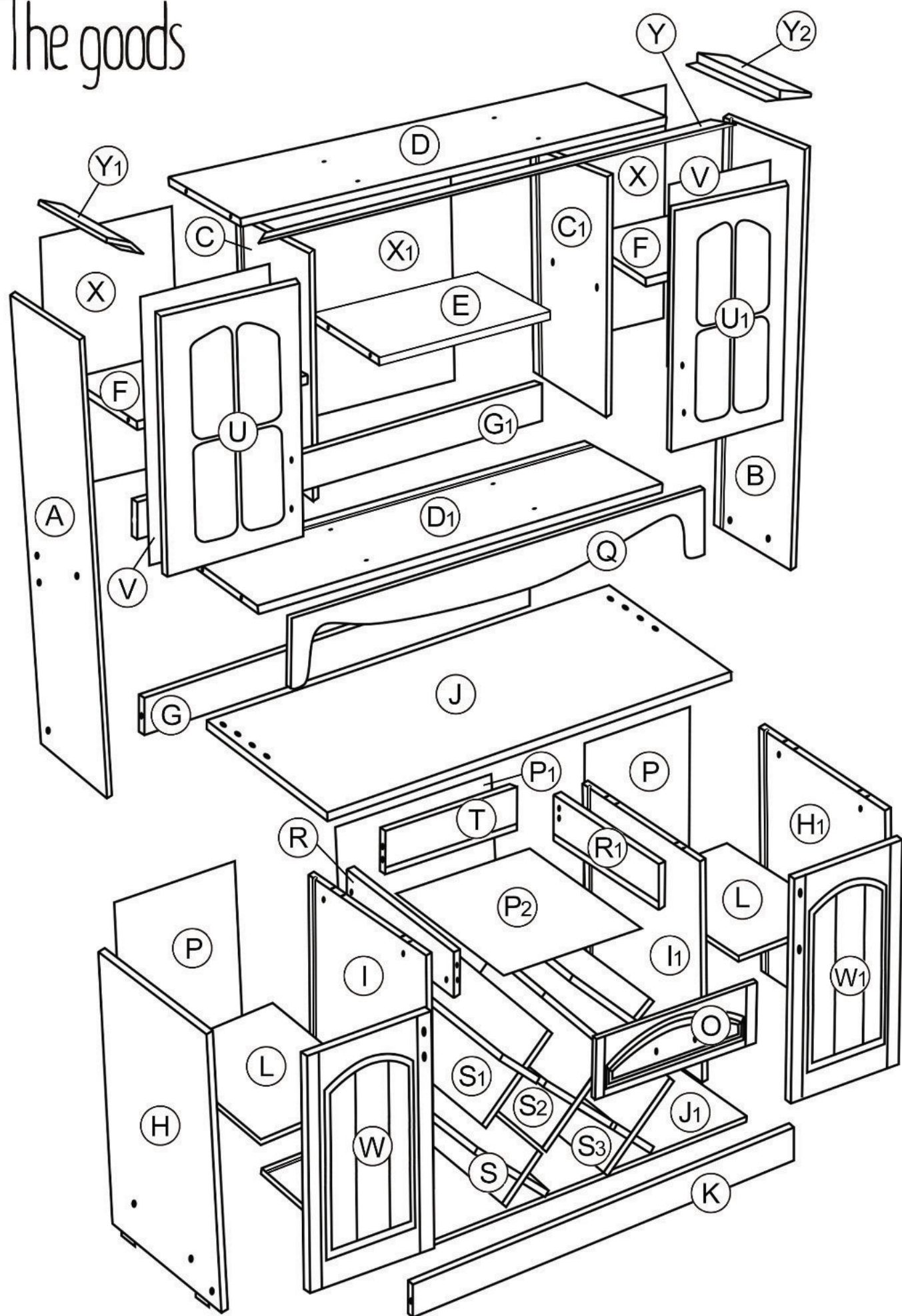

Step 1

Parts (13) and (13.1) are attached together.
You need to unscrew the bolt and it will
fall in two parts (13) and (13.1)
Attach hinges (13.1) to board and
unit using hinge screws (8).

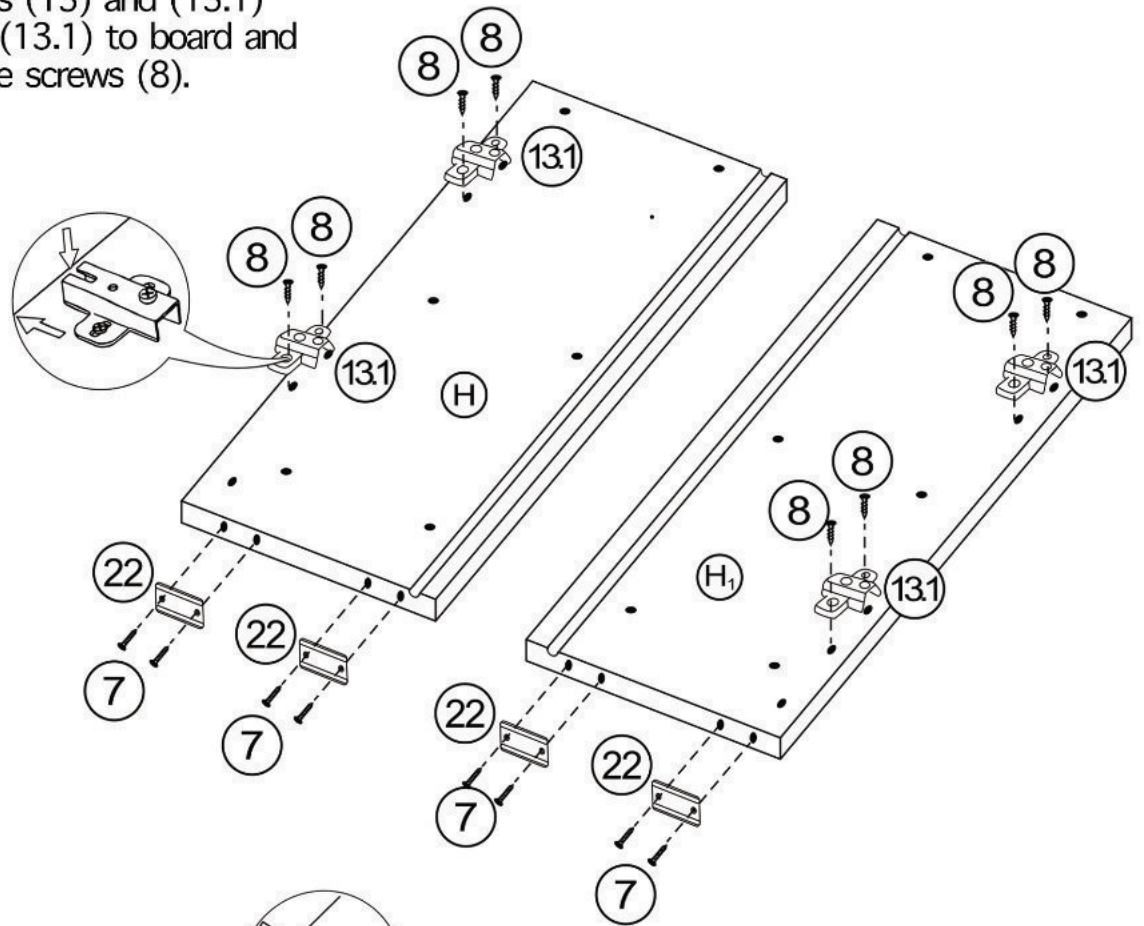

Step 2

A Yup, it's as
easy as it looks.

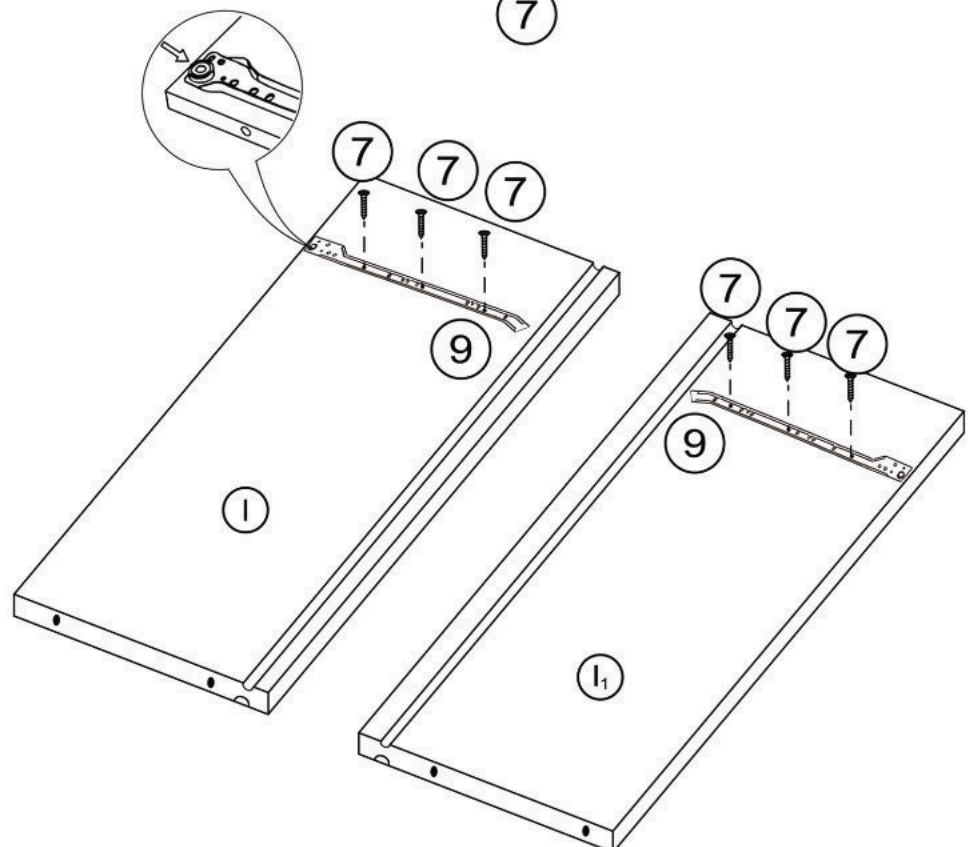

Step 3

Parts (13) and (13.1) are attached together.

You need to unscrew the bolt and it will fall in two parts (13) and (13.1).

Attach hinges (13) to doors and unit using hinge screws (8).

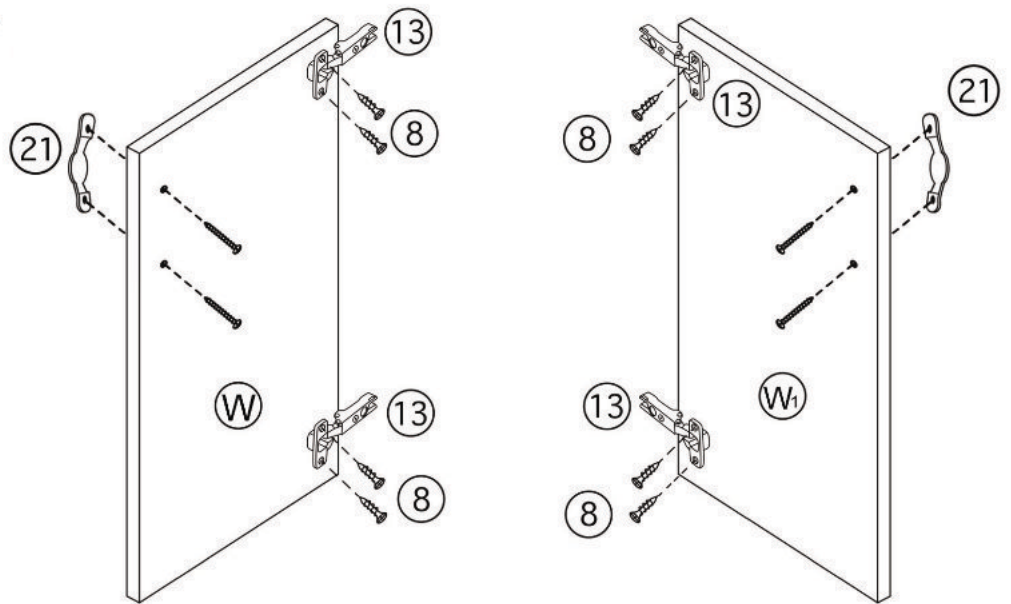

Step 4

Attach panels (I, I₁, J₁) to assembly using screws (2).

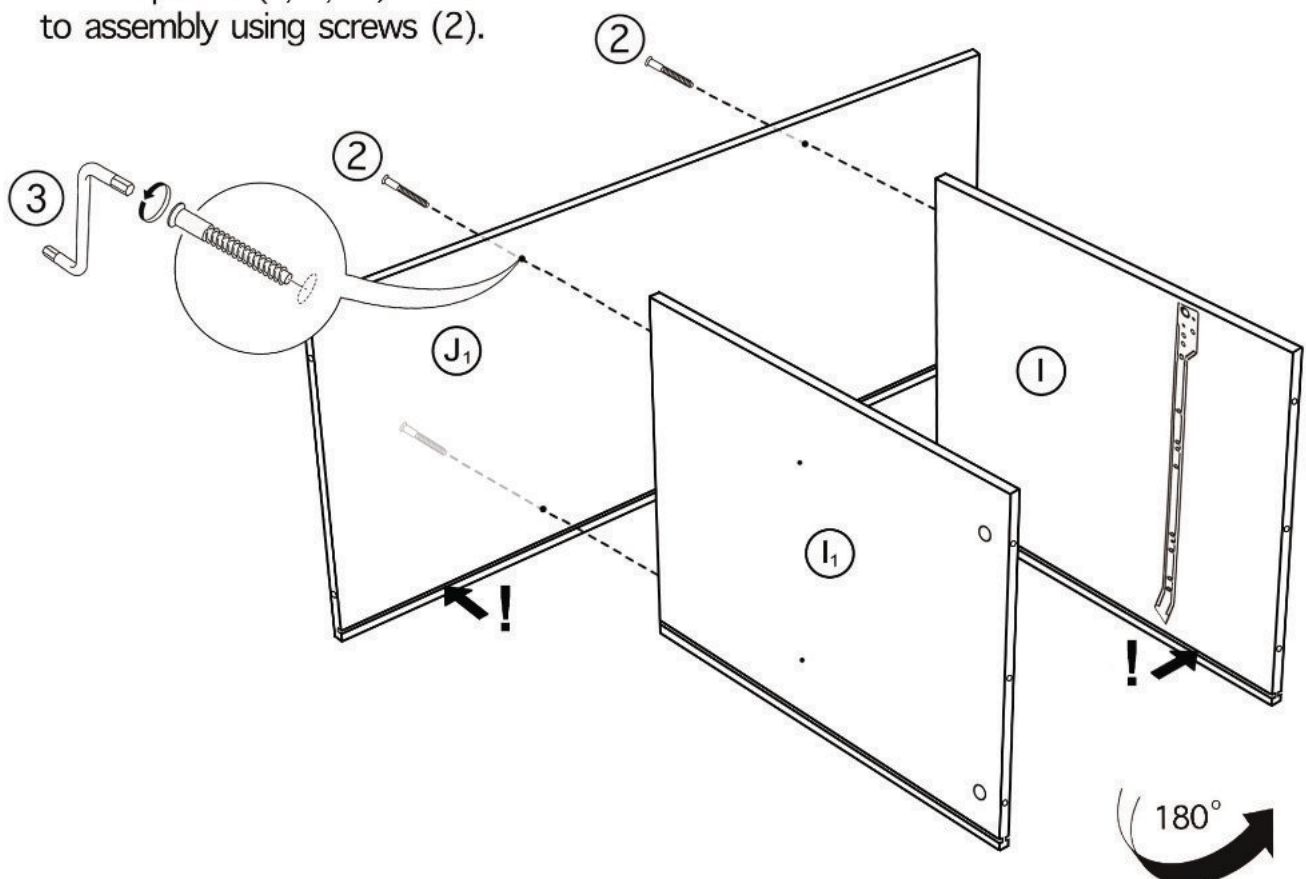

Step 5

Attach lower panel (J₁) to assembly using screws (2).

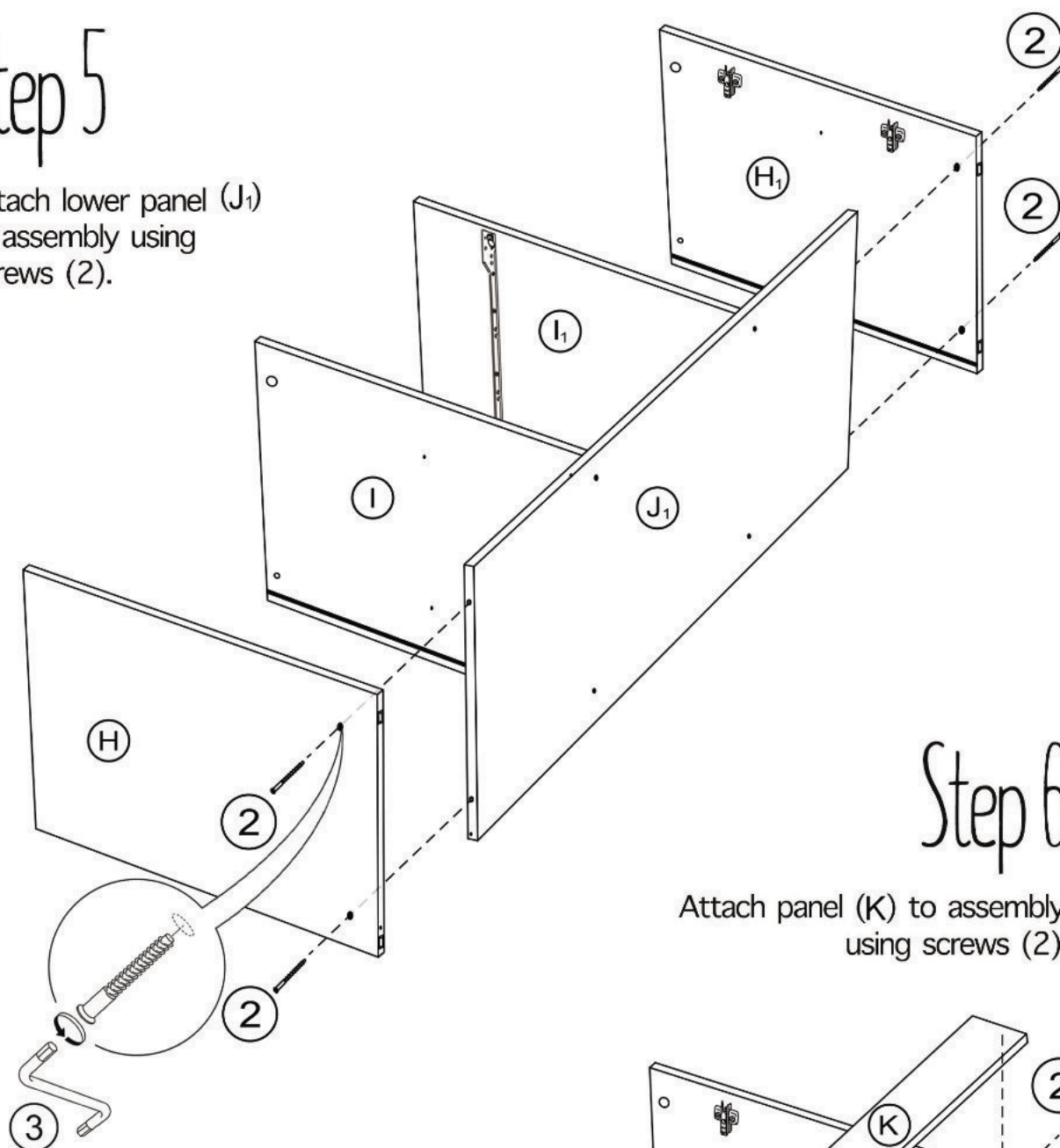

Step 6

Attach panel (K) to assembly using screws (2).

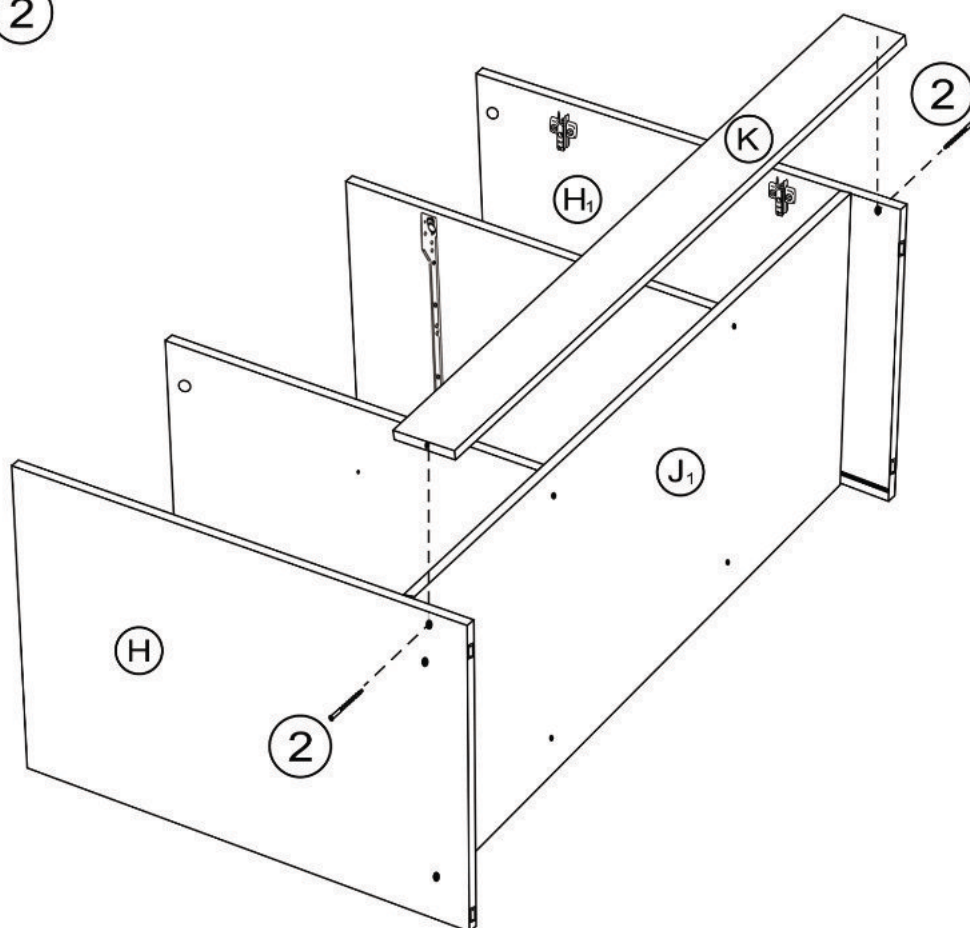

Step 7

Slide back panel into grooves on inside of assembly.

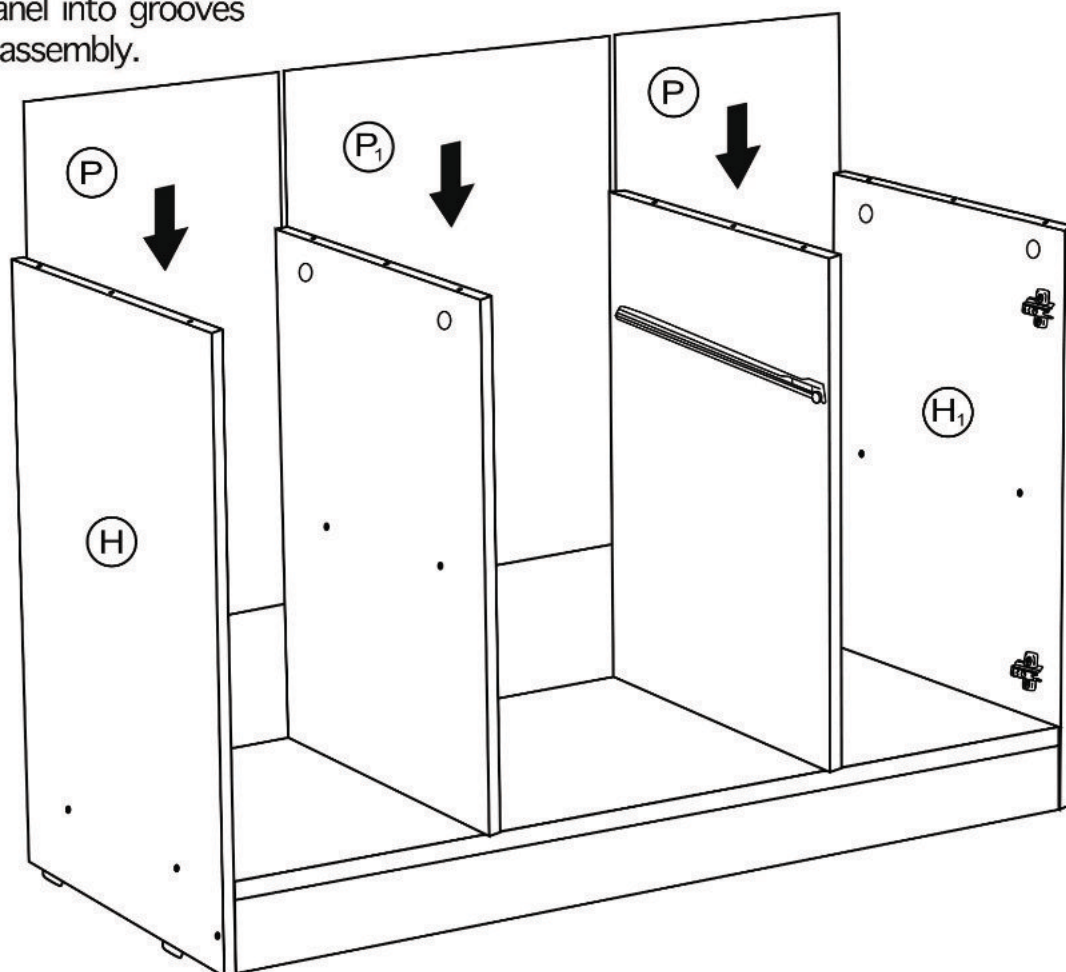

Step 8

Insert cam bolts and wooden dowels into board J.

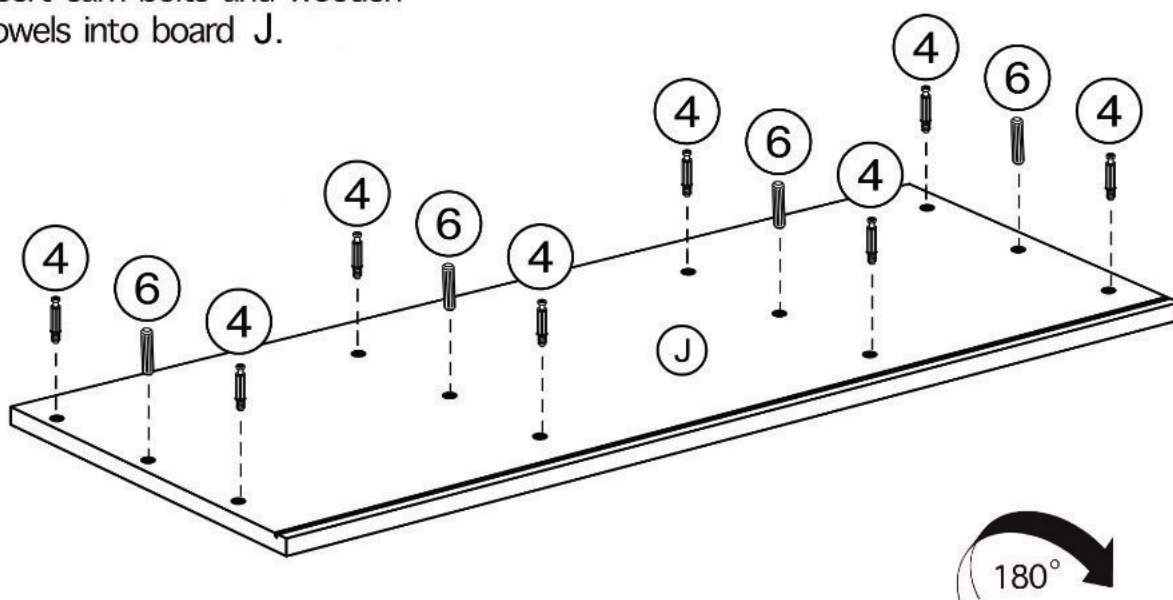

Step 9

It's all coming together!
Attach top panel.

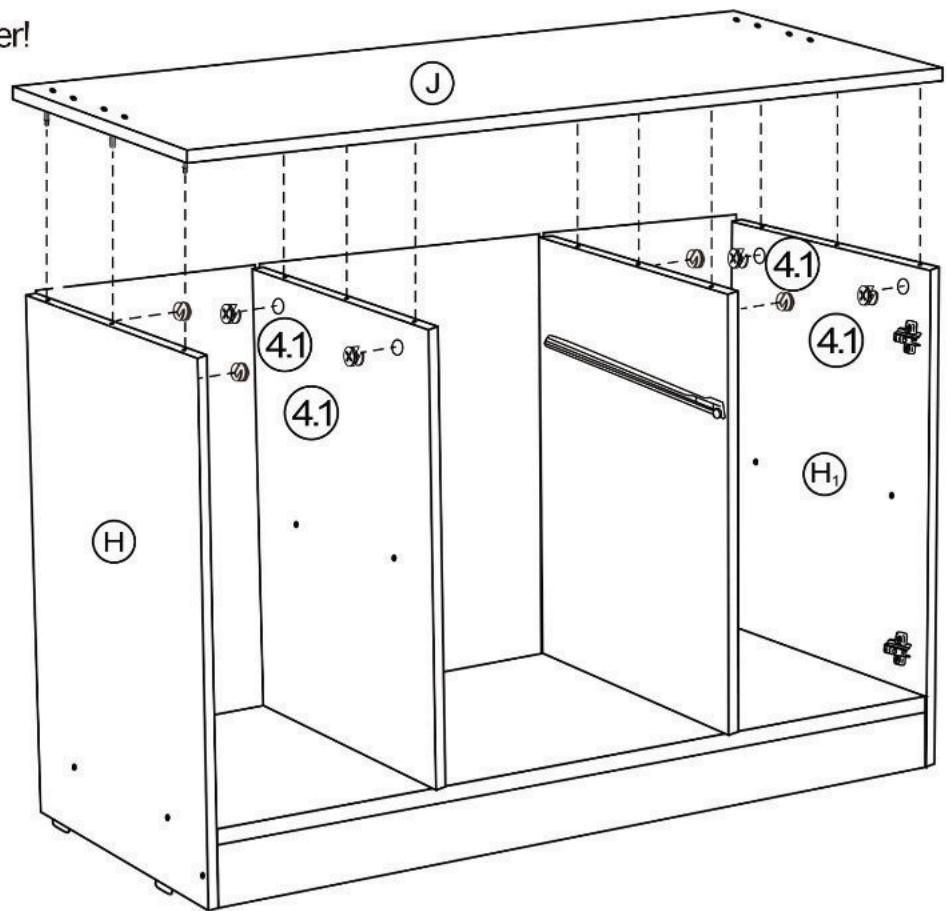

Step 10

Let's get the shelf set up
you're doing great!

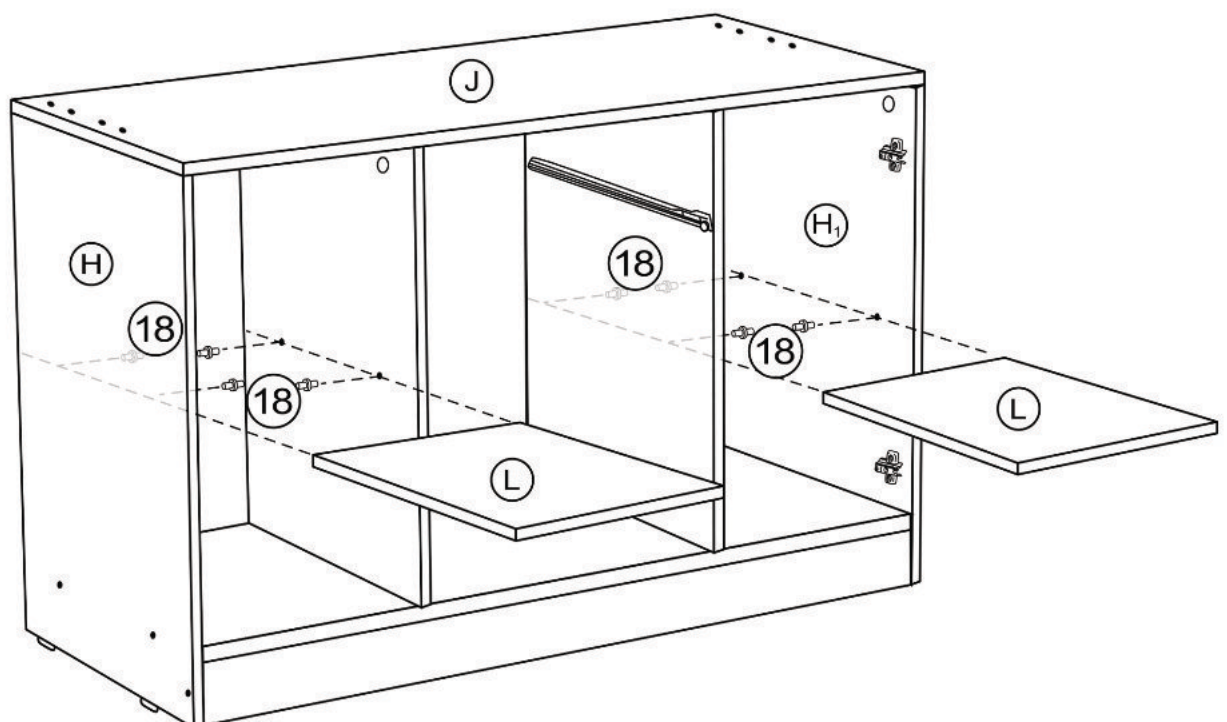

Step 11

Time to get the drawers prepared to stash away junk you'll most likely forget is in there. Unless you're one of those organized people (*eye-roll*).

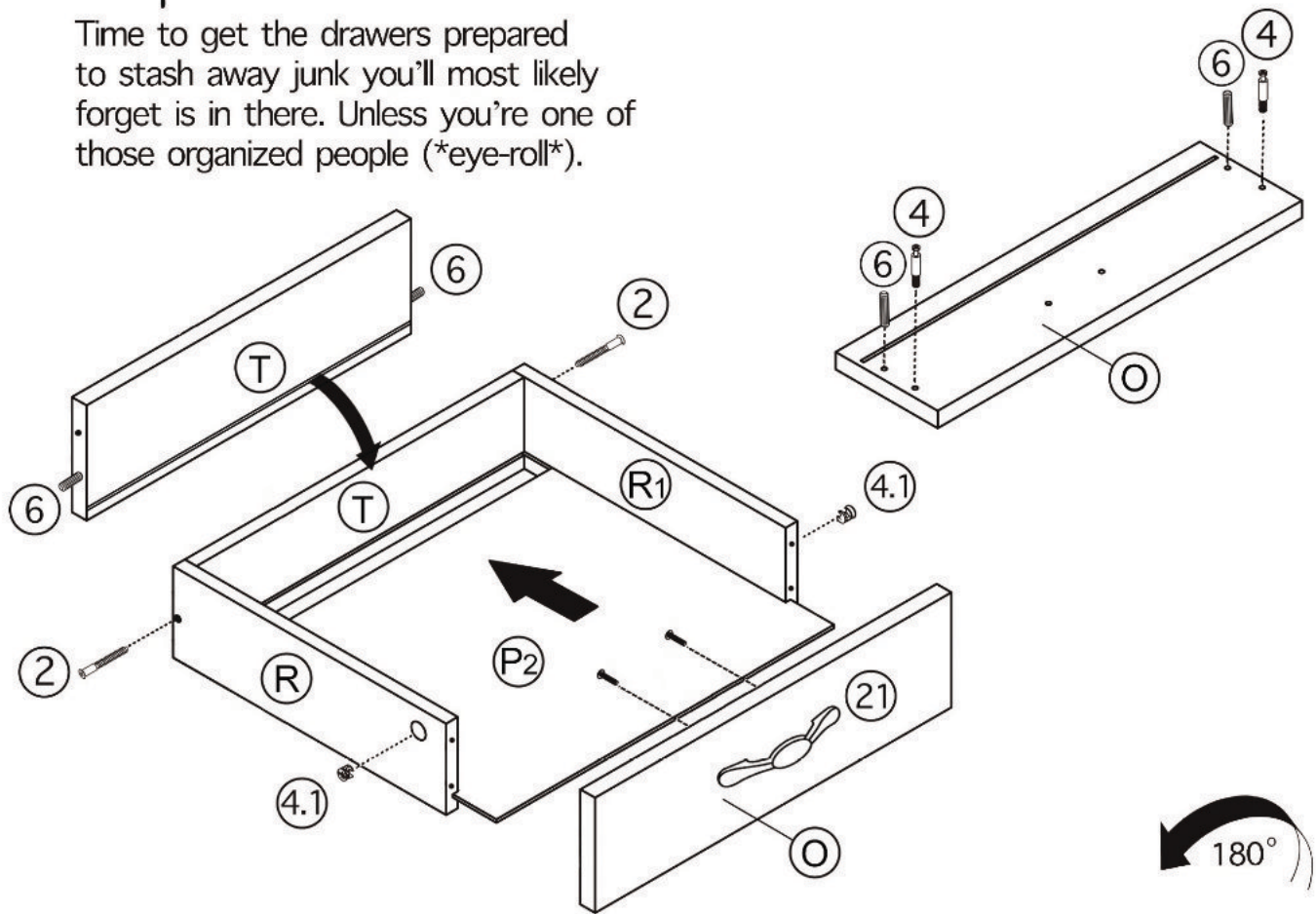

Step 12

Attach the rails (16.1) to assembly using screws (7).

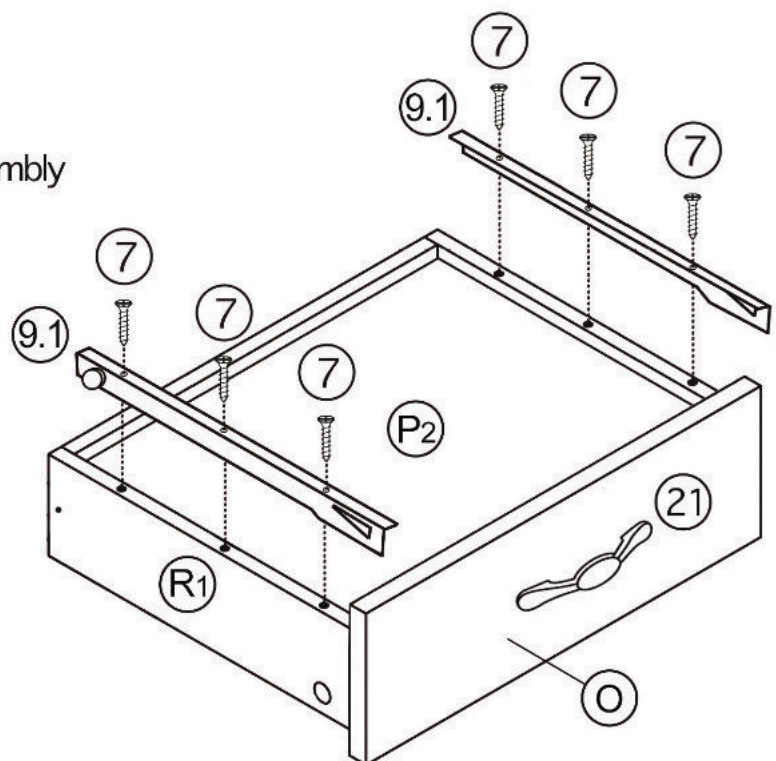

Step 13

Yup, it's as easy as it looks.

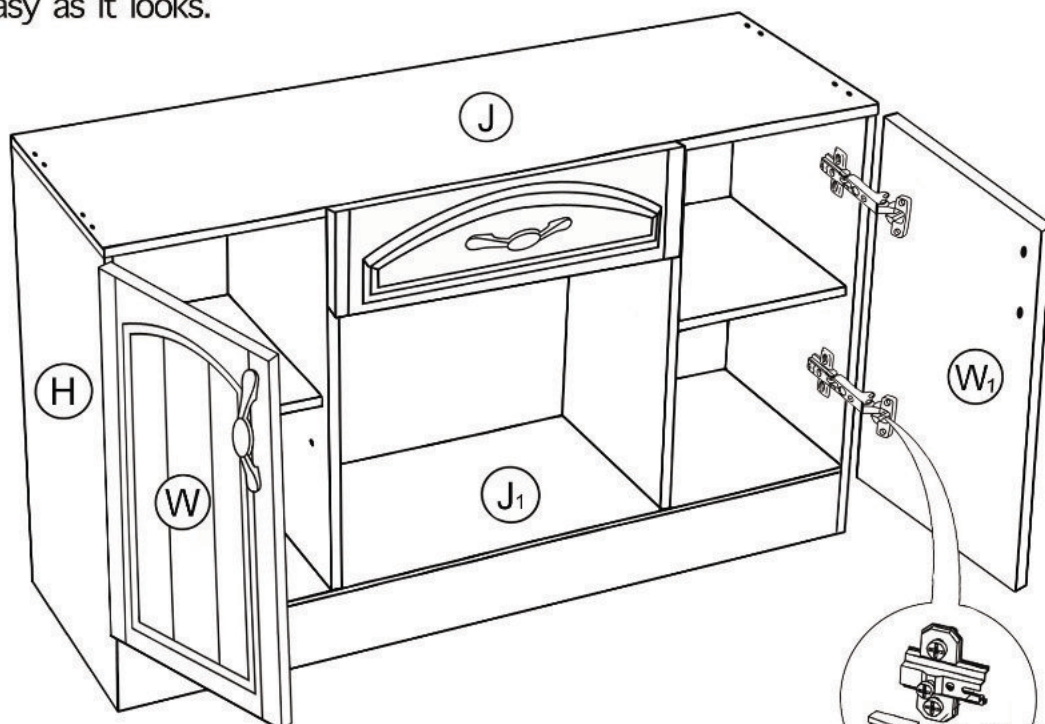

Step 14

Hinges adjustment.

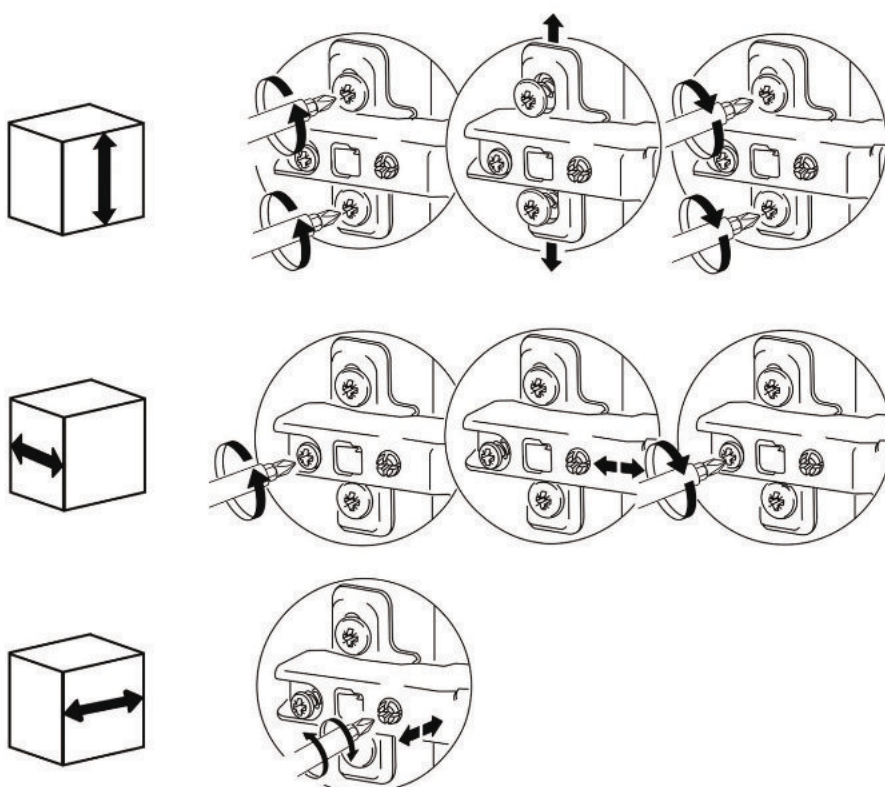

Step 15

Something tells me you
knew this step was coming...
align drawer groove lines
and slide it.

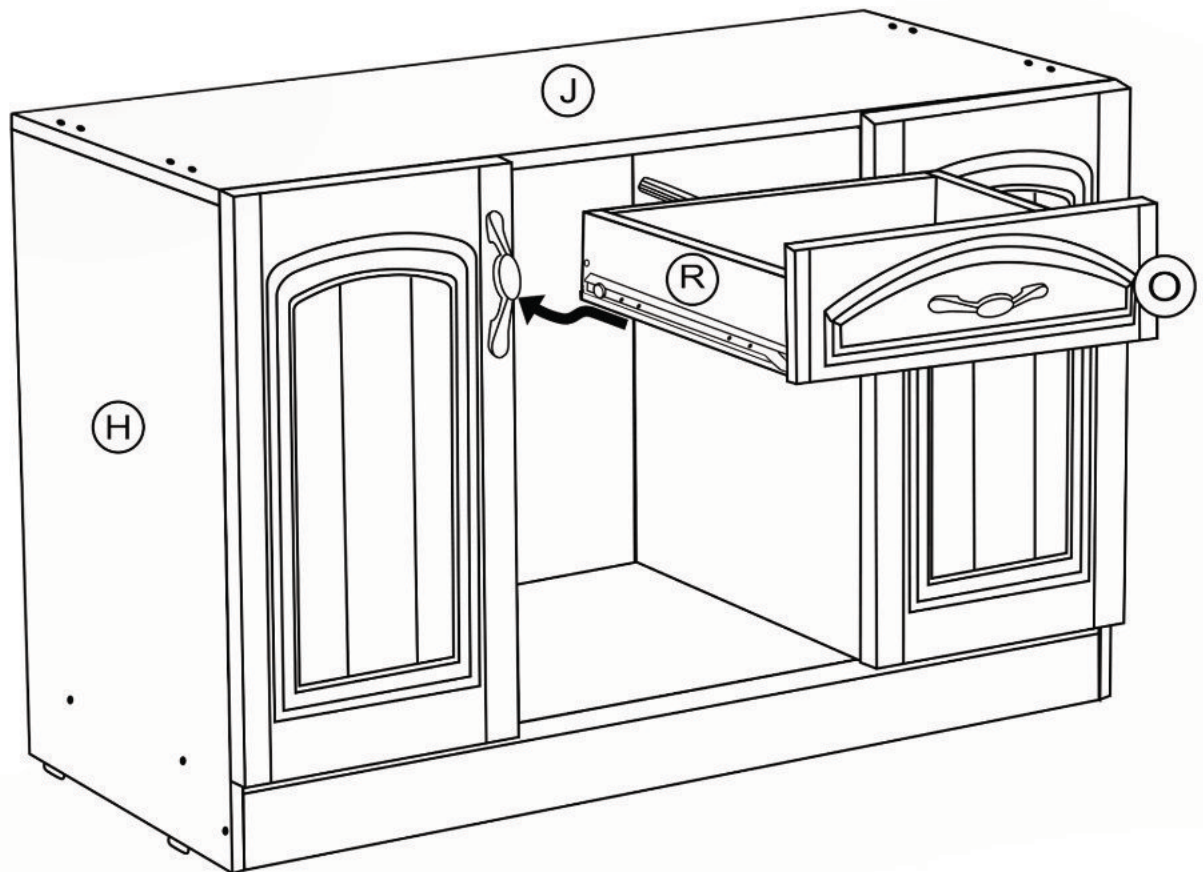

Step 16

Final touches!

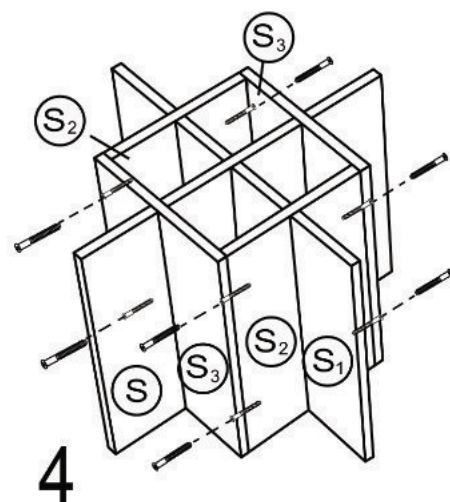
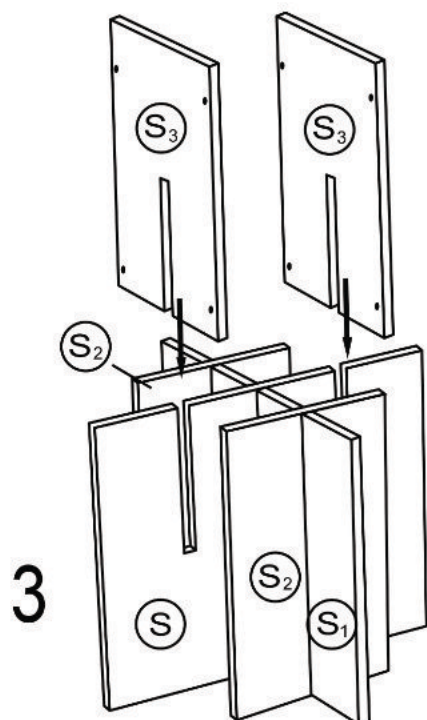
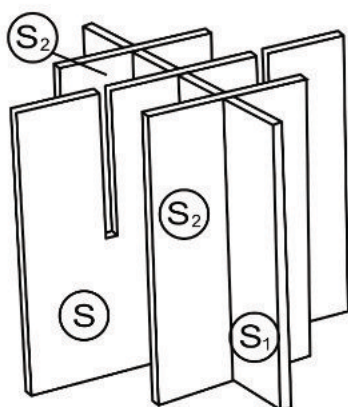
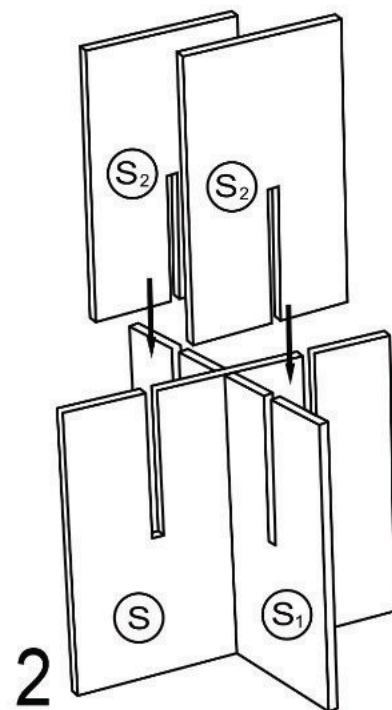
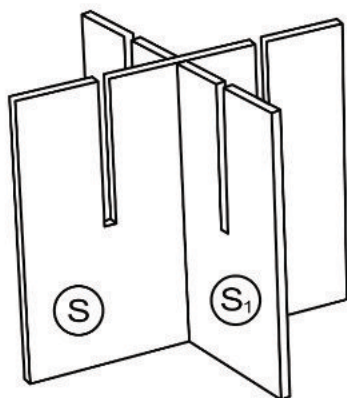
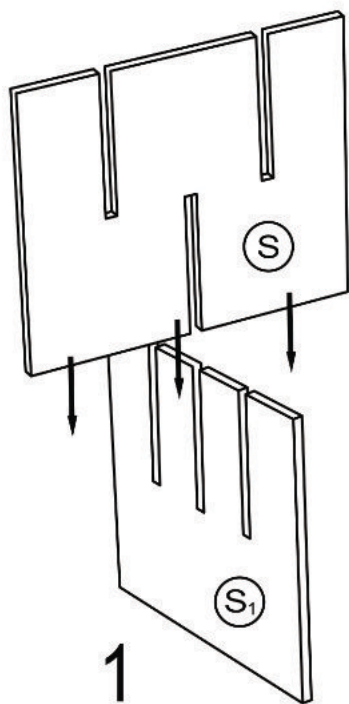

Step 17

Put parts (S, S1) in the cabinet.

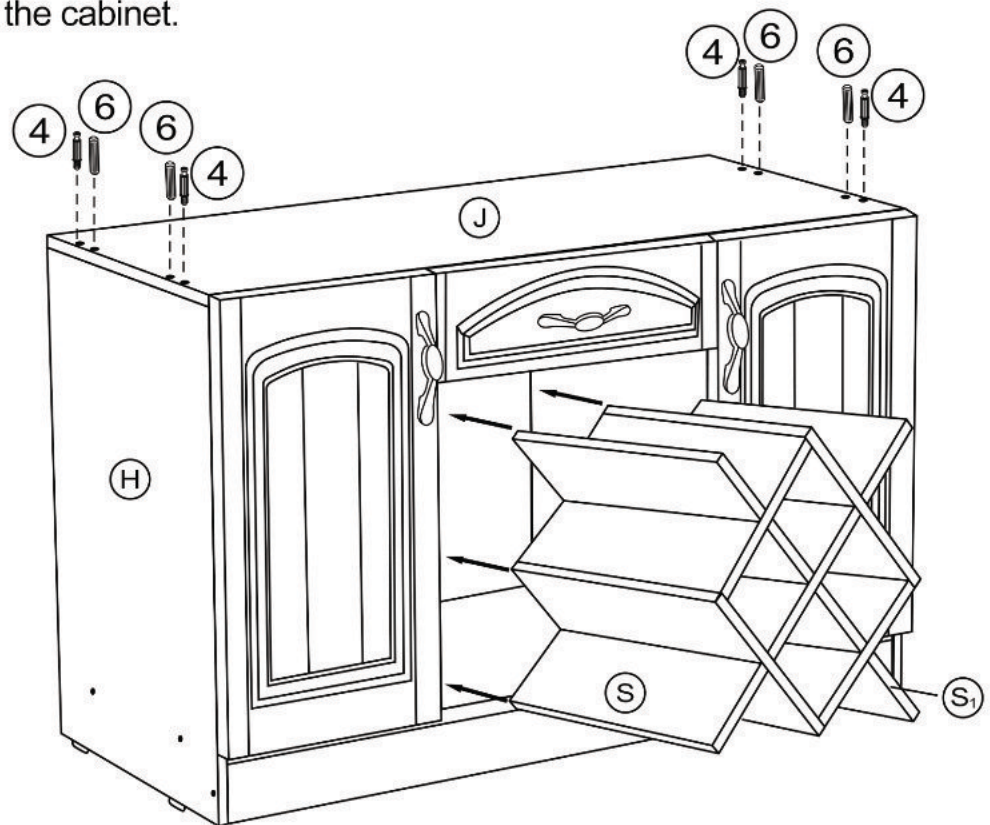

Step 18

Attach the plastic clamer on the glass and secure glass by screws (7).

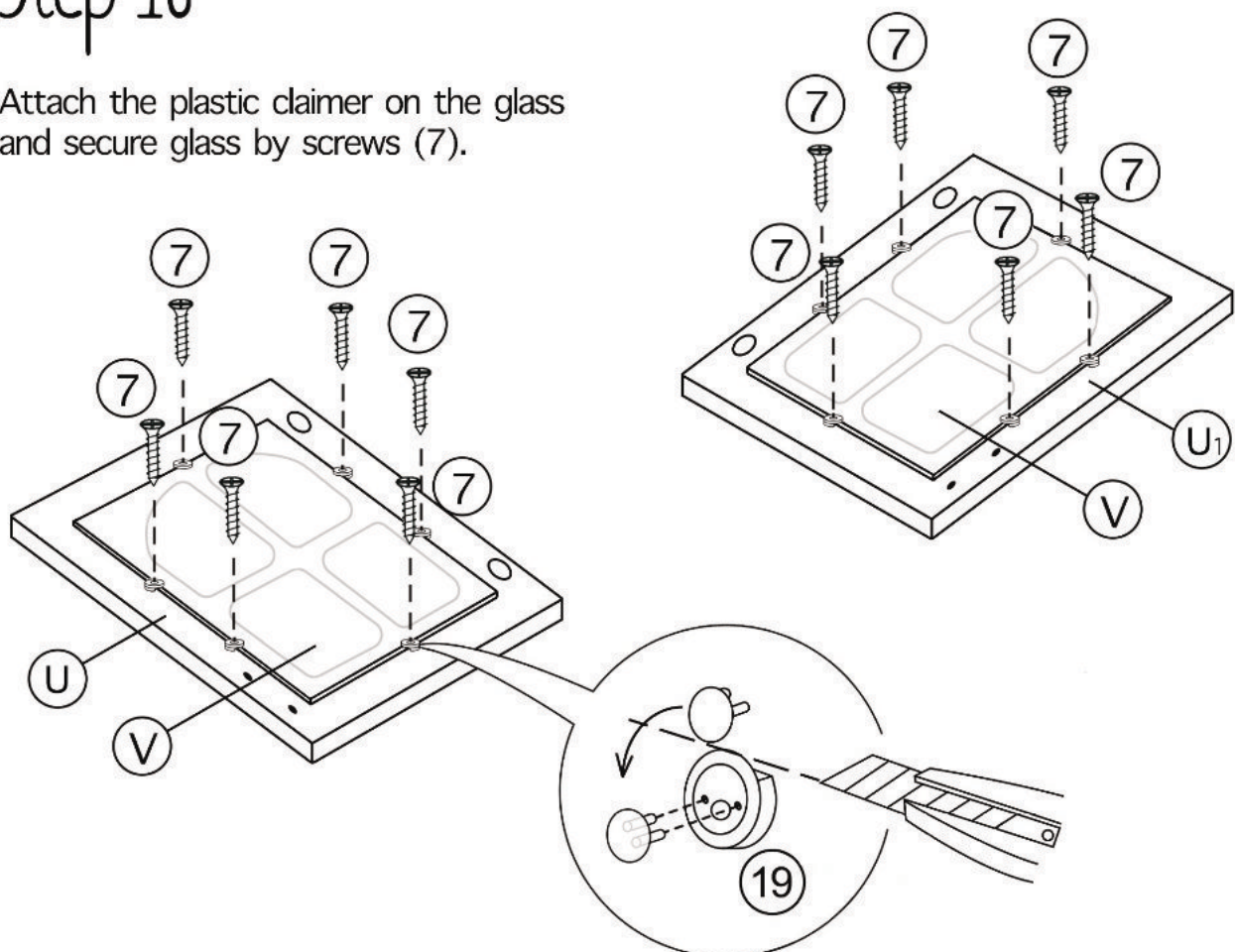

Step 19

Parts (13) and (13.1) are attached together.
You need to unscrew the bolt and it will
fall in two parts (13) and (13.1)
Attach hinges (13) to doors and
unit using hinge screws (8).

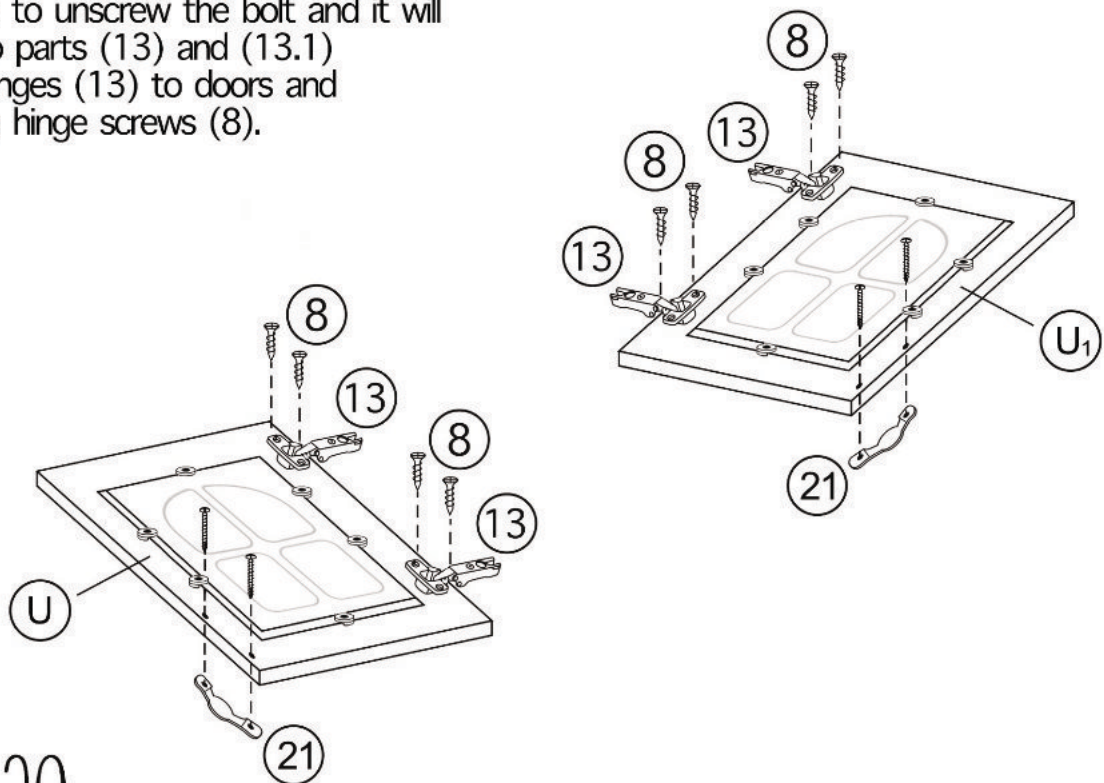

Step 20

Attach hinges (13.1) to board and unit using
hinge screws (8).

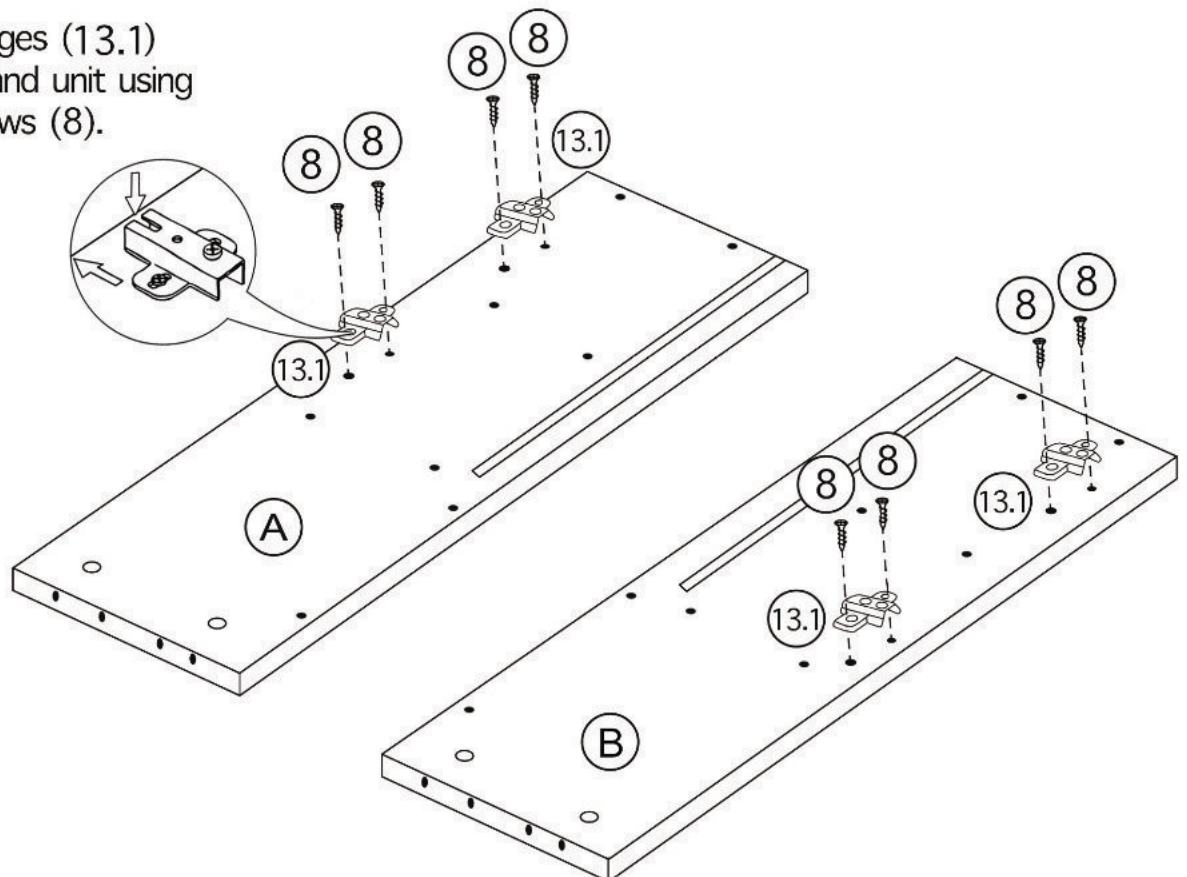

Step 21

You're almost done! If not pizza, then uber eats?
You've worked hard enough today.

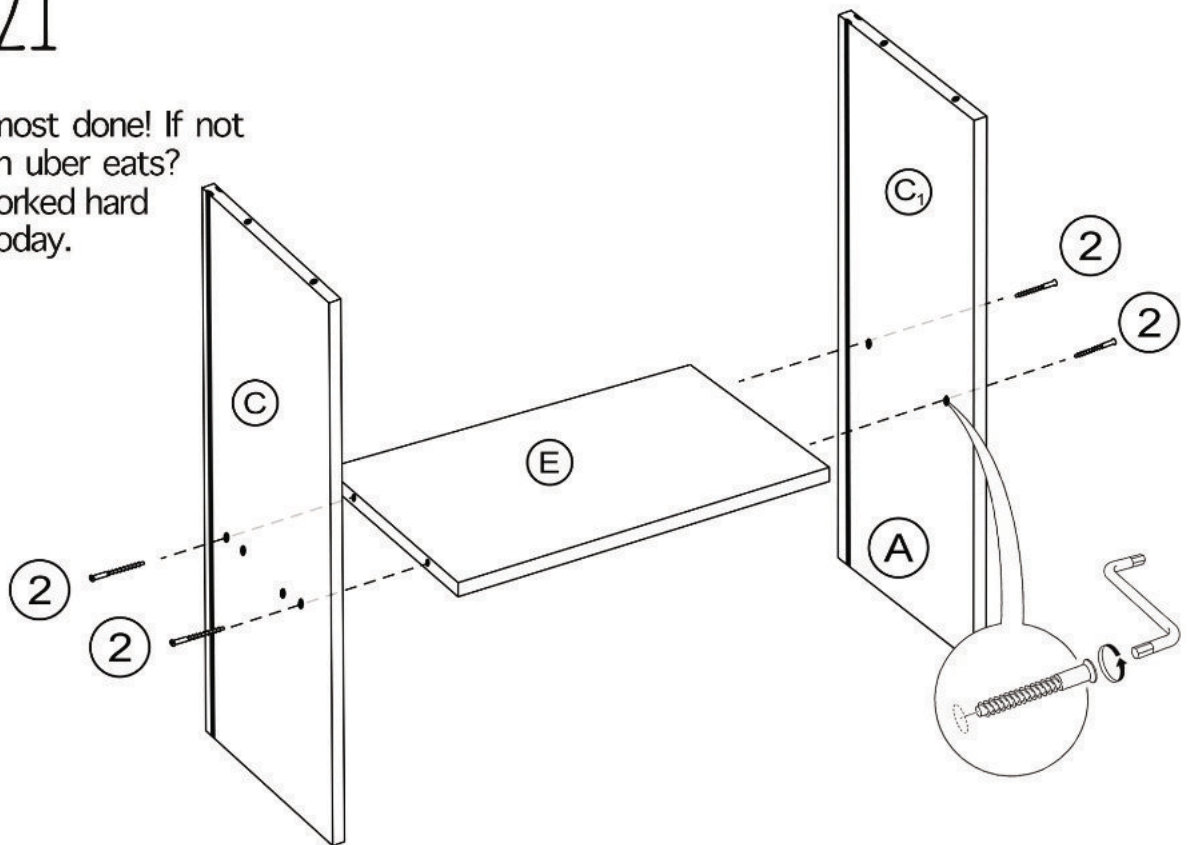

Step 22

Attach lower panel (D₁) to assembly using screws (2).

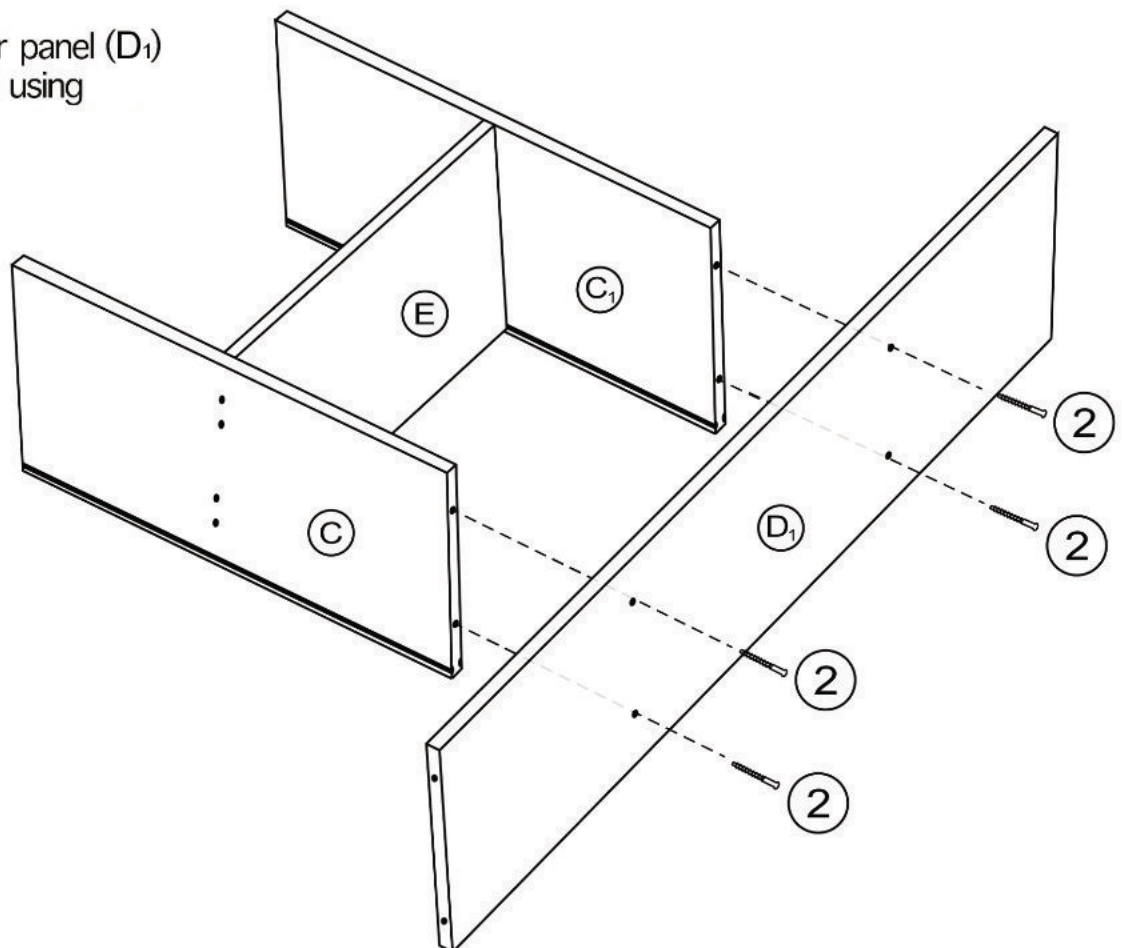

Step 23

Yup, it's as easy as it looks.

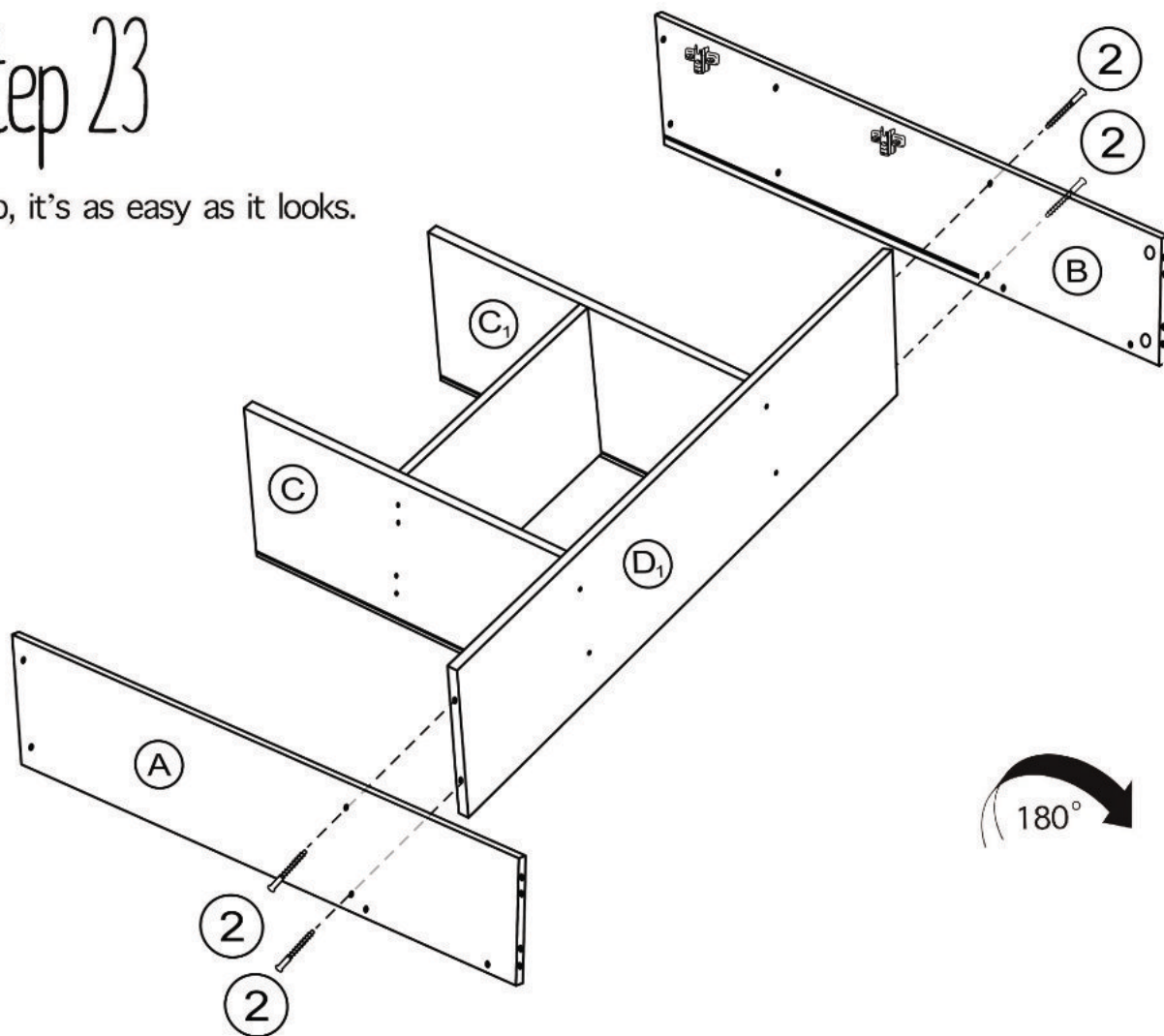

Step 24

Attach panels (G, G1) to assembly using screws (2).

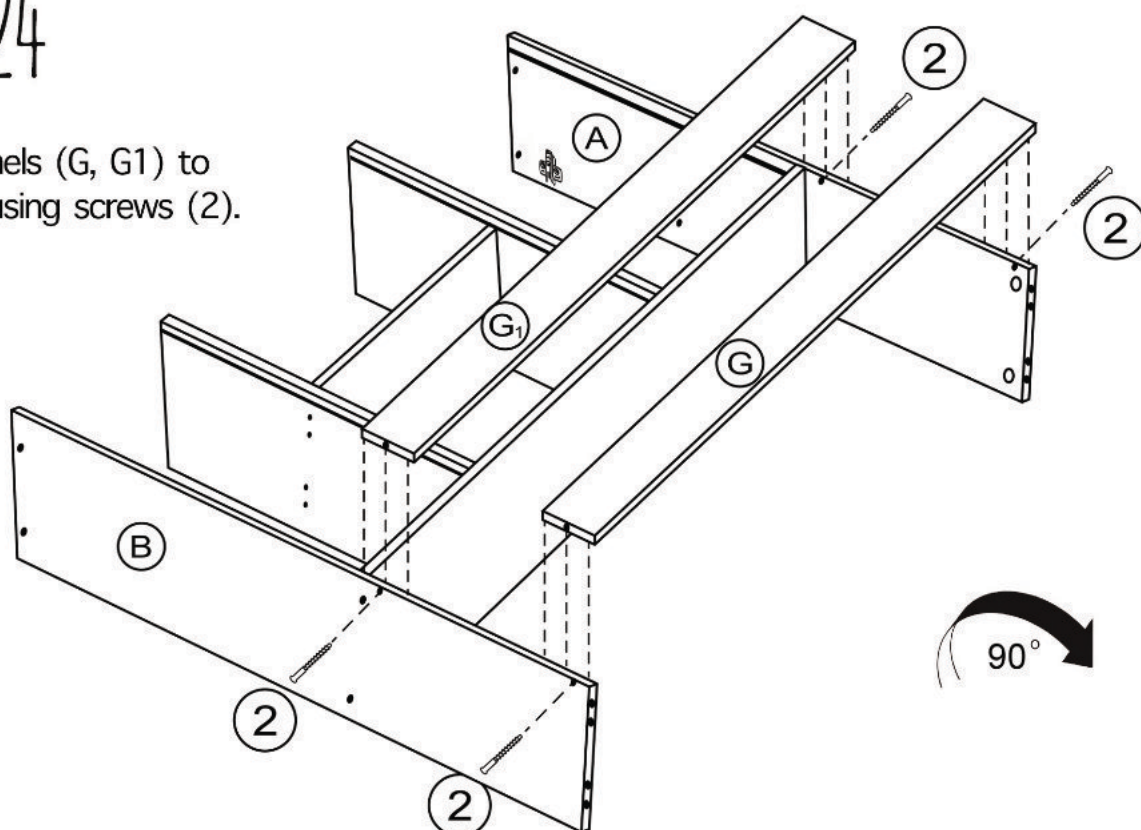

Step 25

Slide back panel into grooves on inside of assembly.

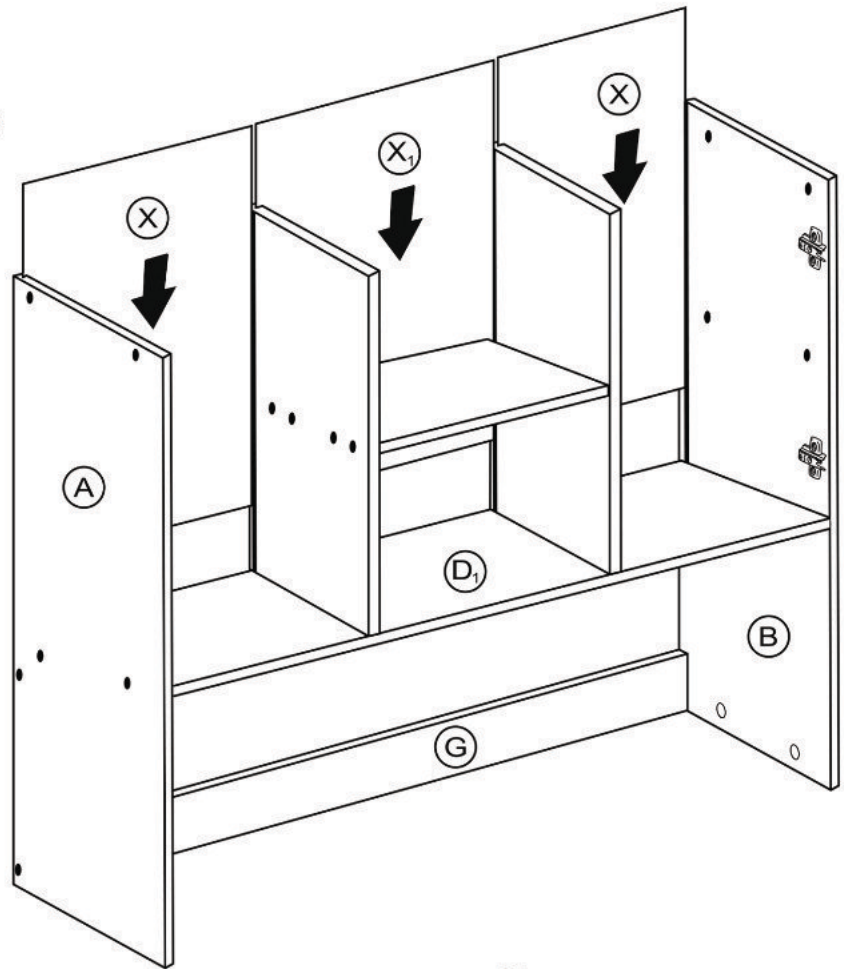

Step 26

It's all coming together!
Attach top panel.

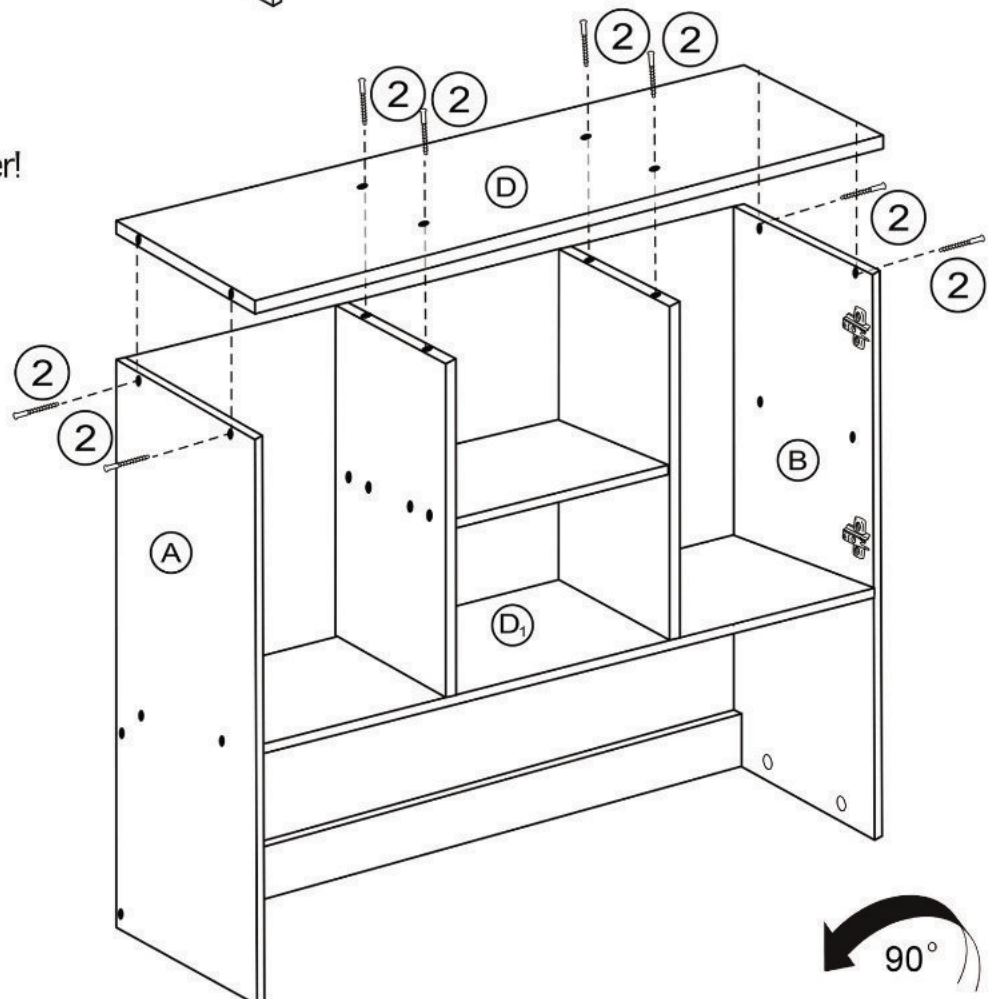

Step 27

Secure apron with (7) screws.

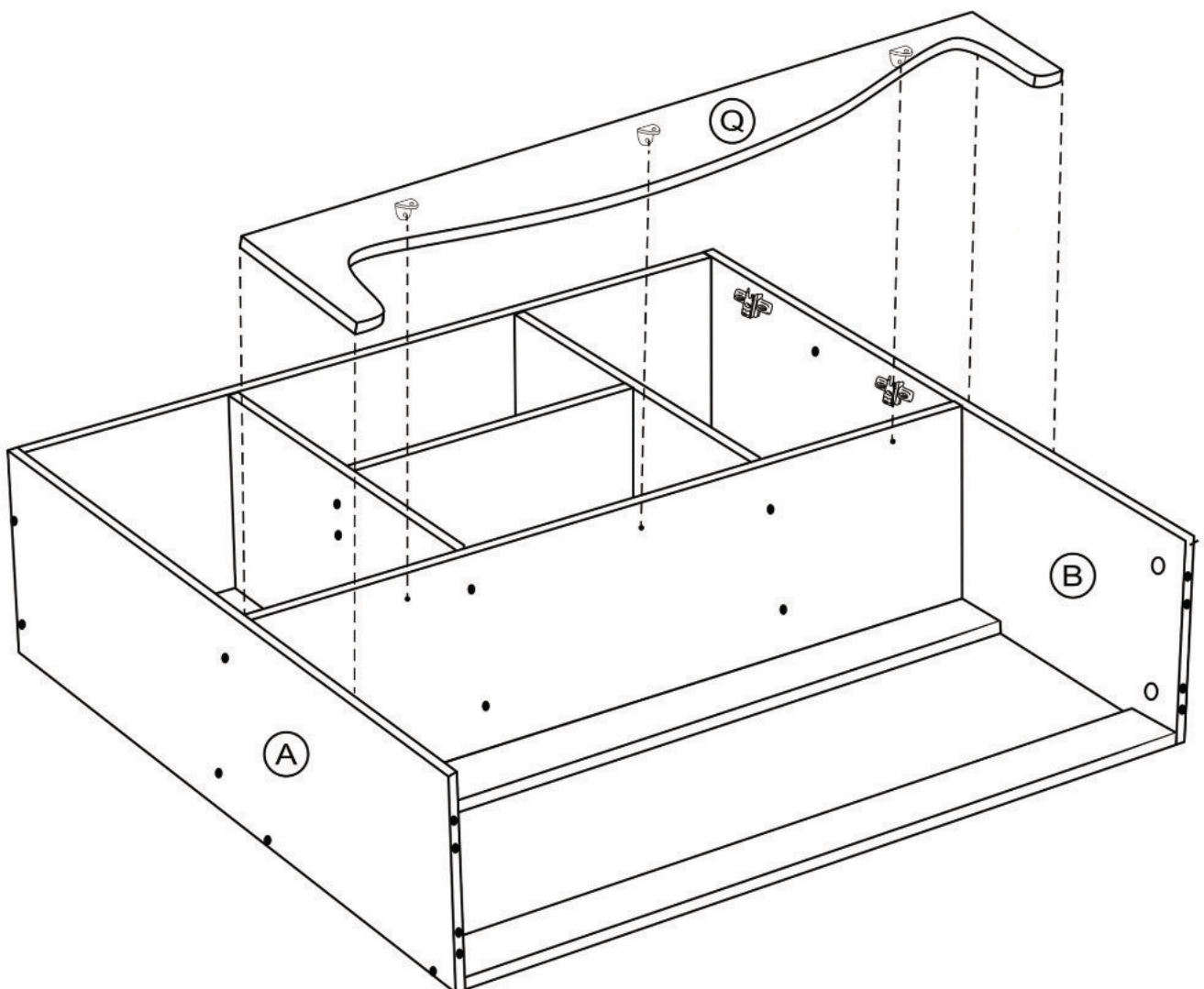
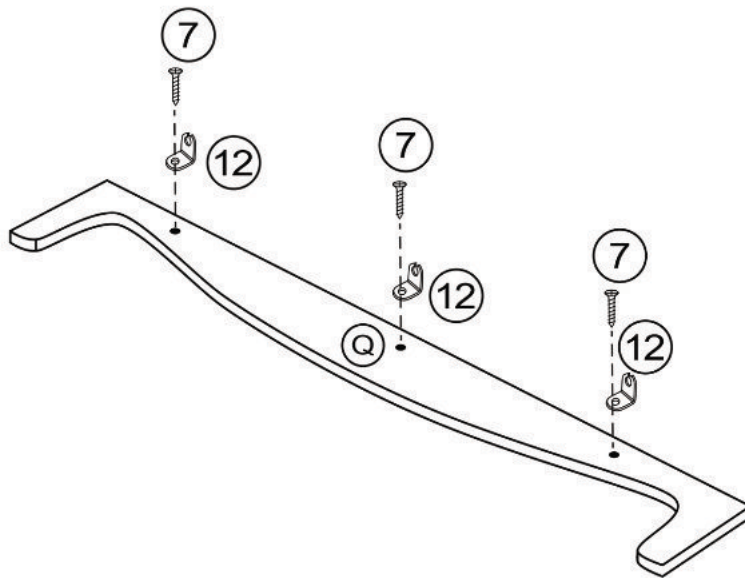

Step 28

Attach panels (Q) to assembly using screws (7).

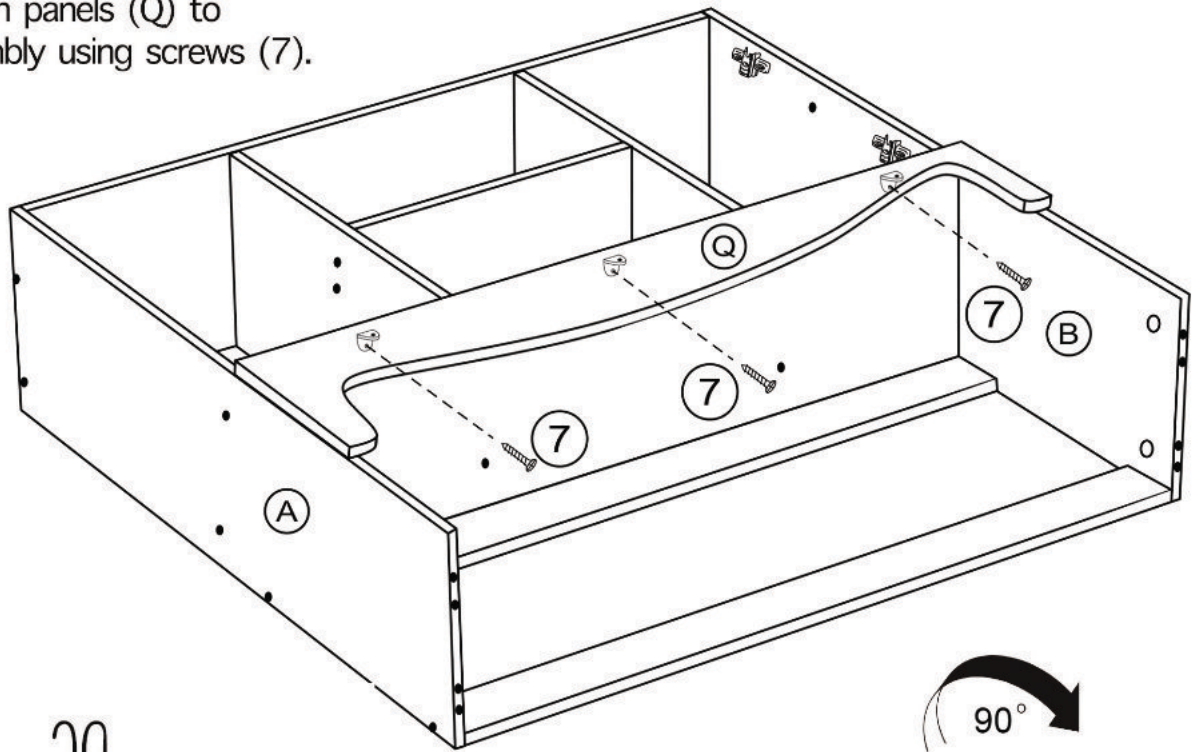

Step 29

Attach wall straps (20) using screws (23).

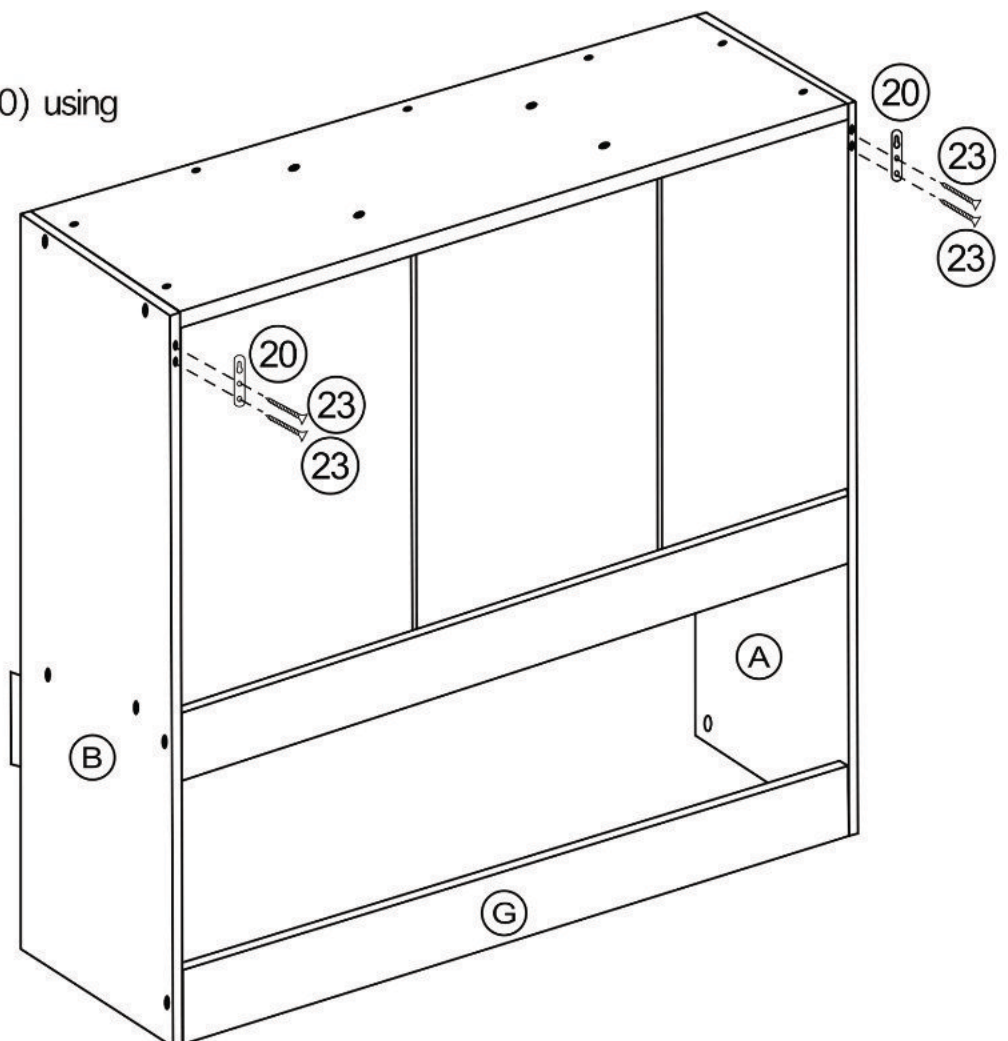

Step 30

I know... we're thinking the same thing, I'm hungry. (Yes we're looking at you, accessible chip bag) but hold off, because you deserve better than that!

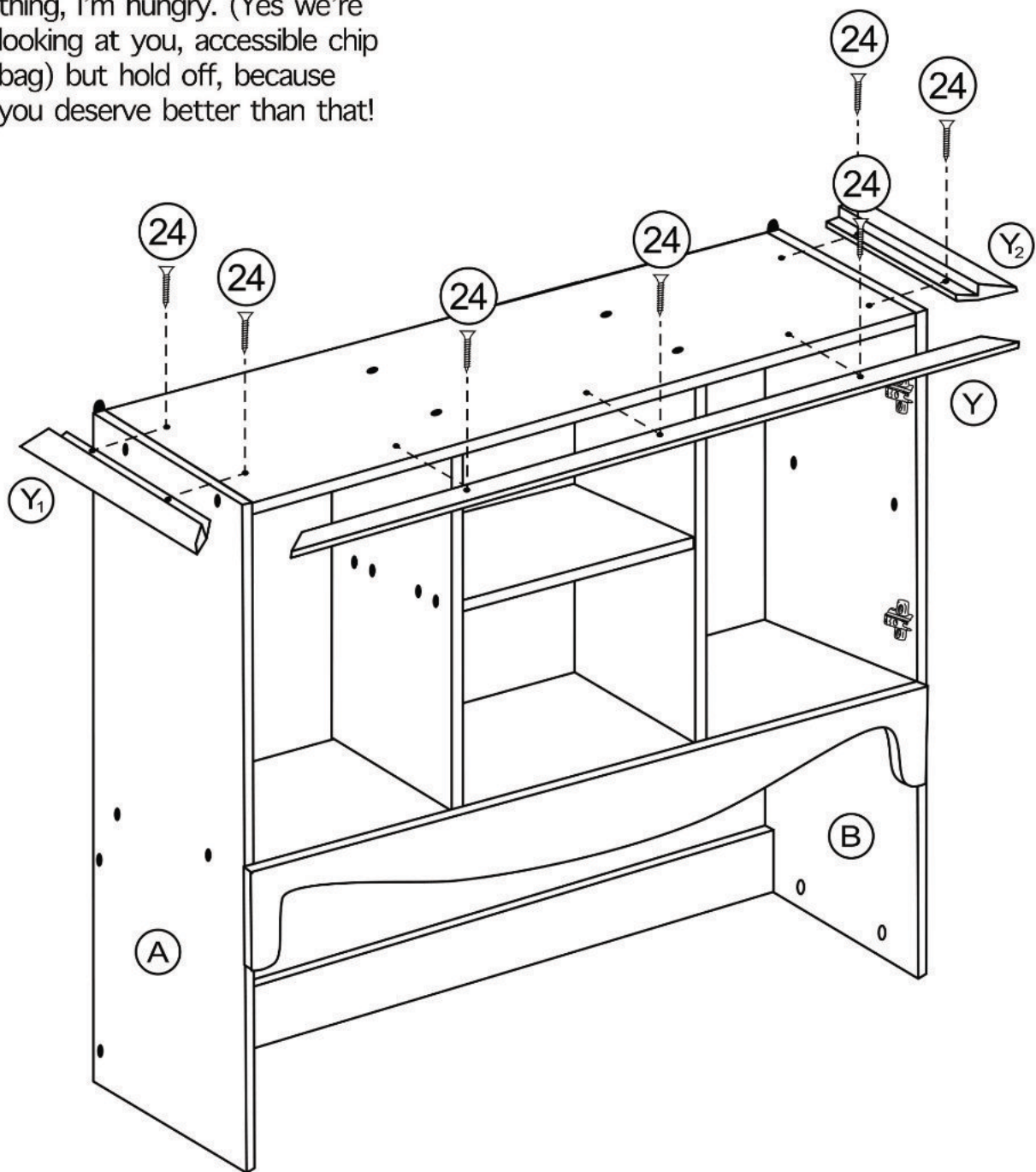

Step 31

Let's get the shelves set up
you're doing great!

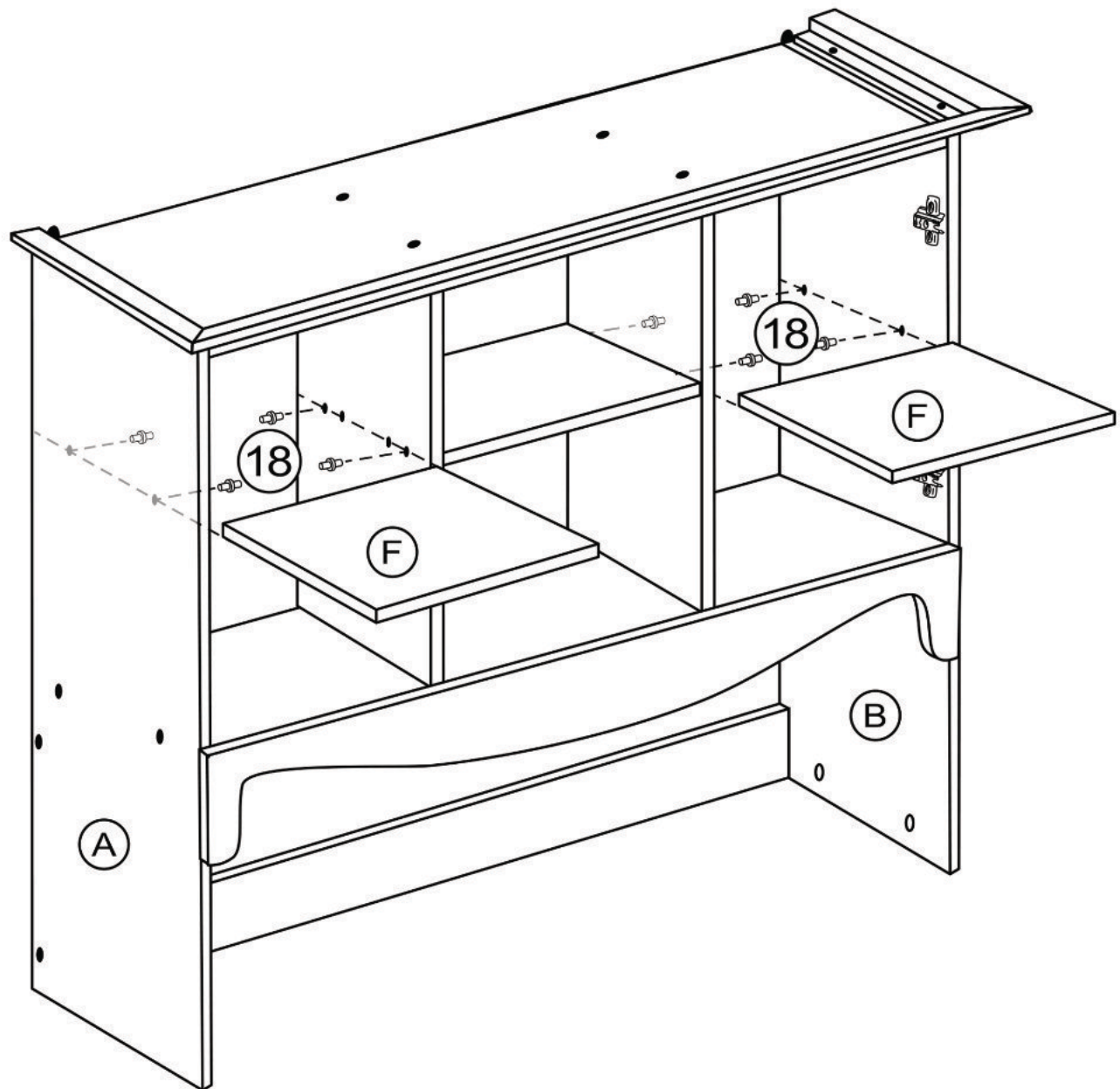

Step 32

Final touches!

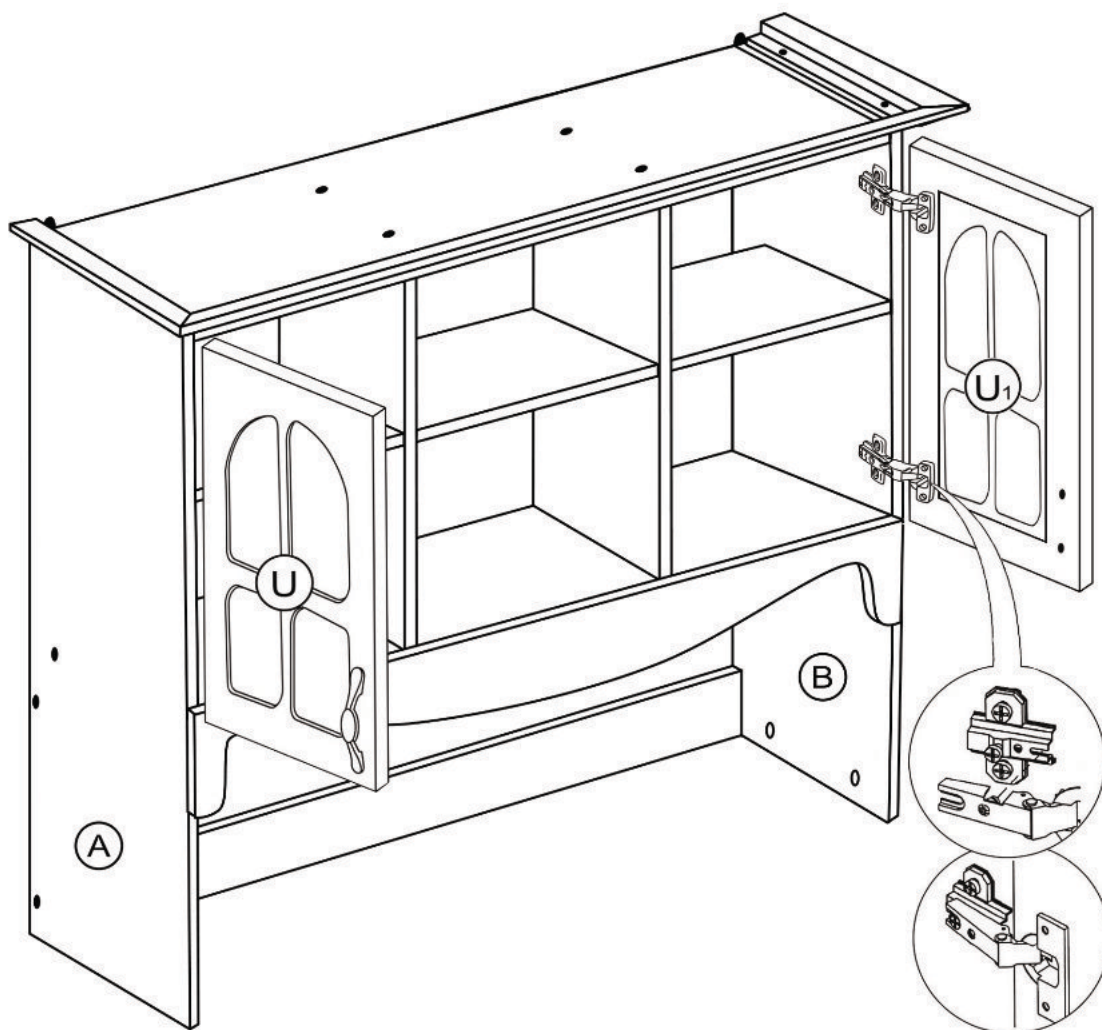

Step 33

Hinges adjustment.

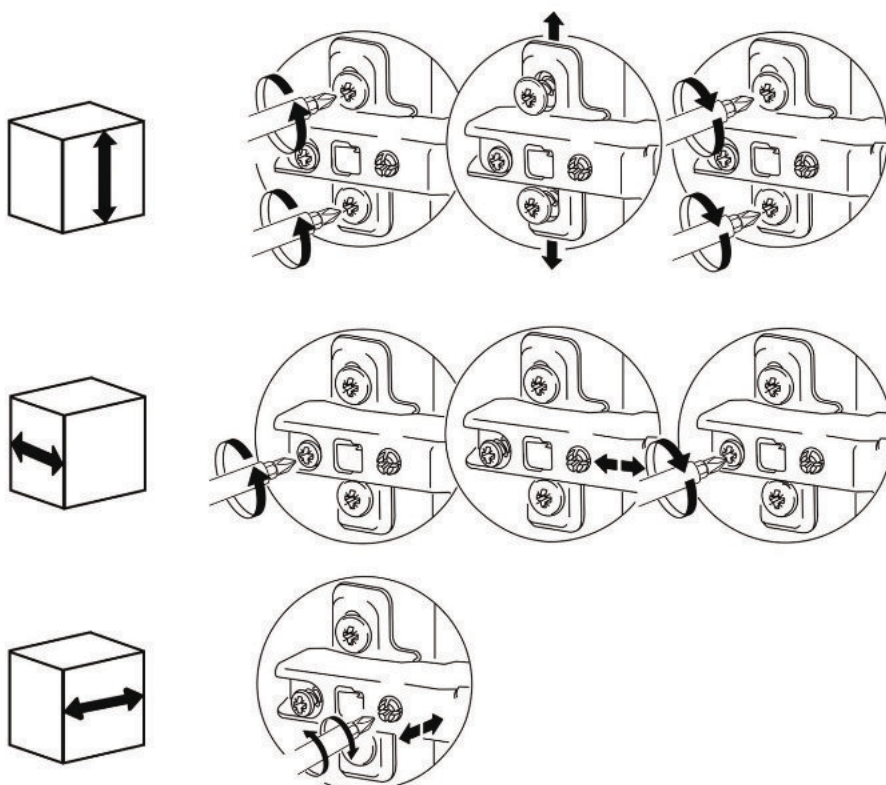

Step 34

It's all coming together and
go enjoy your well deserved
slice & episode!

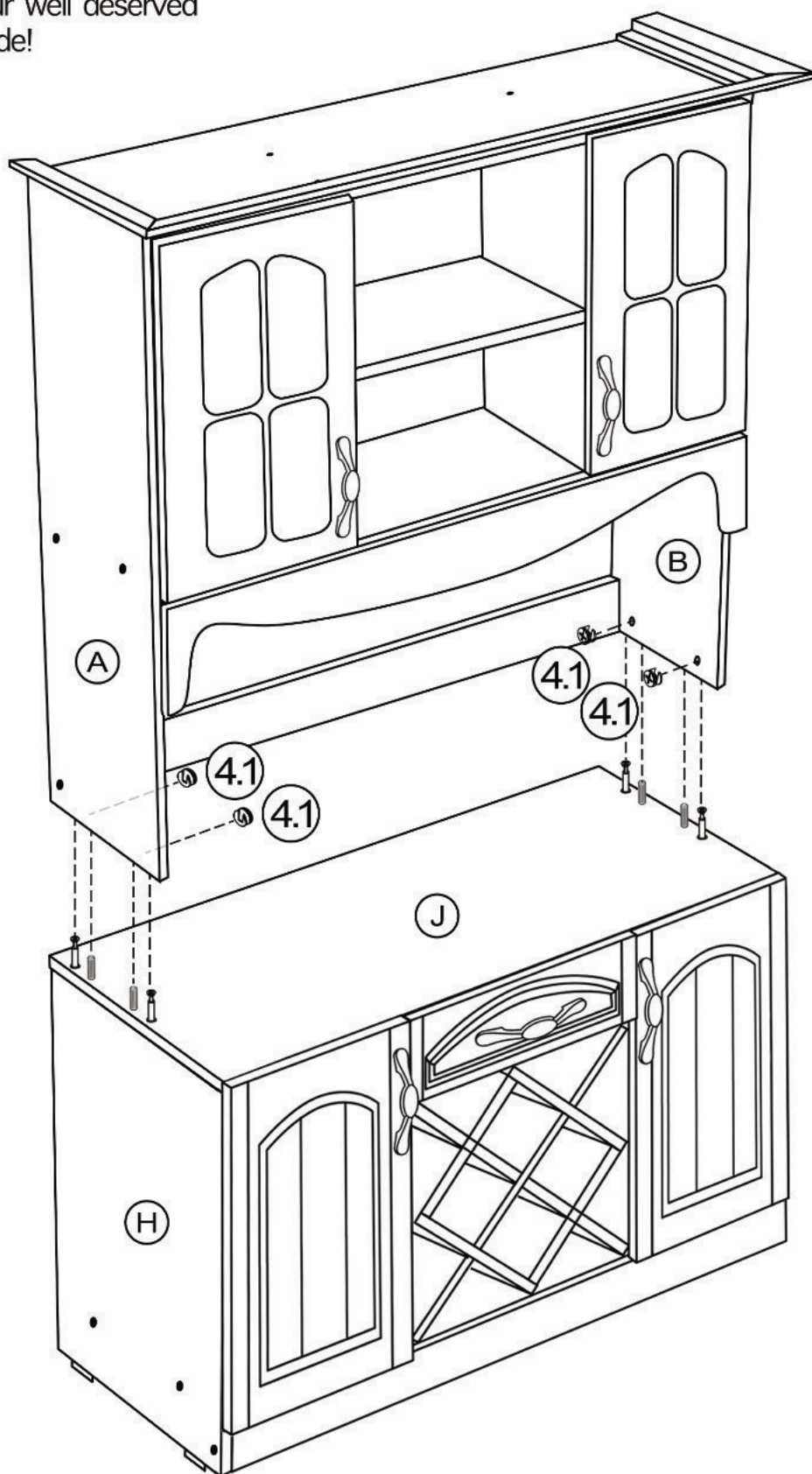

Step 35 (optional)

Wall mount attach

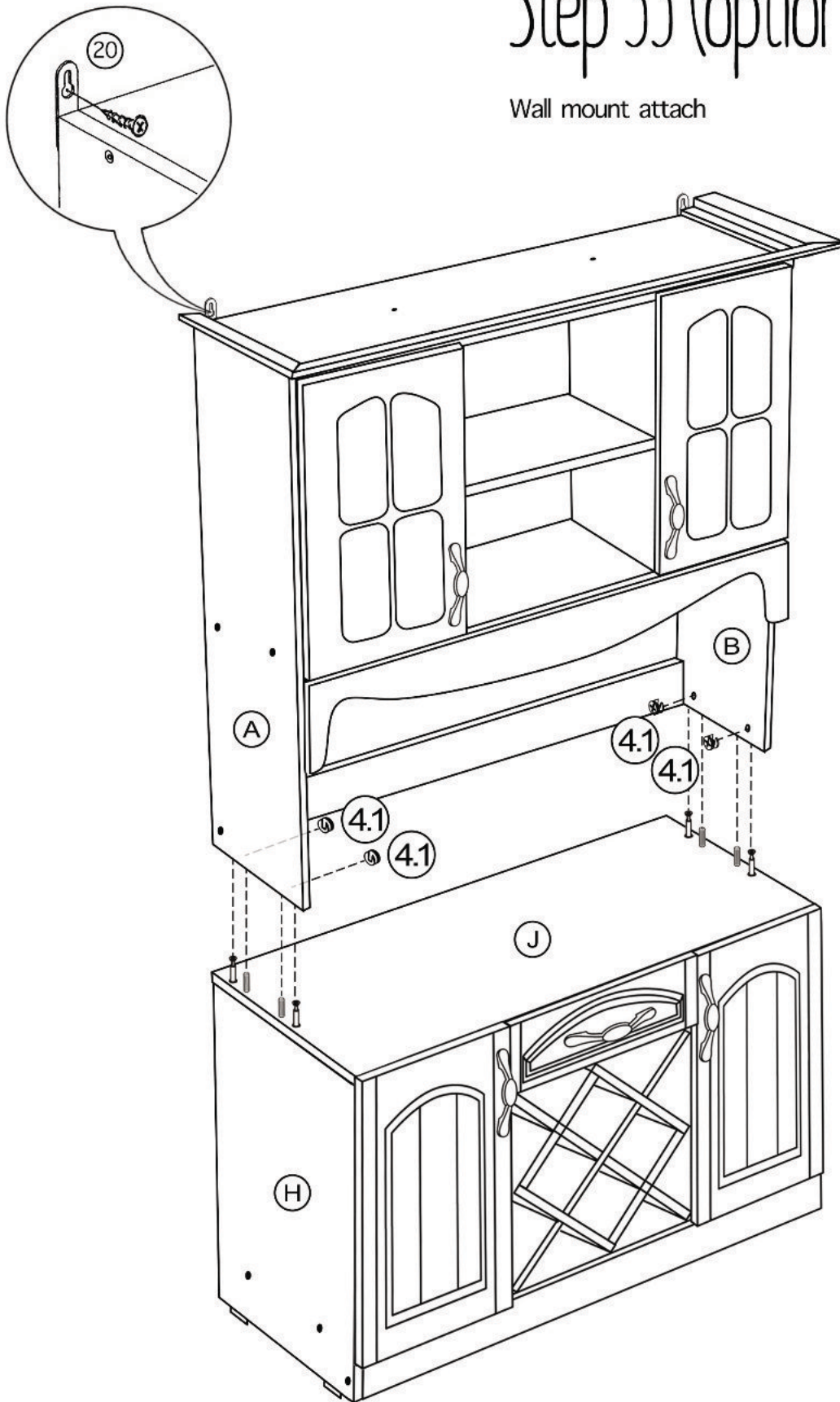

Safety First, fun later

We want your product to last as long as possible, so we recommend that you tighten the screws 2 weeks after assembly and for added safety check the tightness of all screws every 2 months.

Safety use of this product starts with you.

Use this product responsibly with the primary concern for your safety. Follow assembly instructions carefully and inspect product upon receipt and each use. We cannot be held legally responsible for any injuries or death resulted from failure to follow instructions or improper use of this product.

Proper Use

- DO NOT use for commercial purposes
- DO NOT use as a step stool or stand on storage unit
- DO NOT put hot serving liquid directly on storage unit top
- DO NOT leave spilled liquid on the storage unit top
- DO NOT use storage unit if damaged
- DO NOT exceed weight limit
- DO NOT make temporary repairs
- DO NOT use outdoor

We are only in business if you're happy

We do our best to ensure your furniture arrives without any problems, but occasionally mistakes happen - as humans we are imperfect beings. In the event that a part is damaged or missing, contact our customer service department and we will be more than happy to help you.

Did we do alright? Please spread the love!

If you are happy with your product, tell your friends and family about us or even better leave us a review online.

Spreading the word gives us the opportunity to make more people happy and keep our prices low for your next purchase.