

vax[®]
LiFE

CORDLESS UPRIGHT VACUUM

LET'S GET STARTED.

U85-LF-B



Let's talk safety



Basic safety precautions

- This Cordless upright is intended for household use only and NOT for commercial or industrial use.
- Only use the Cordless upright indoors and keep the area your cleaning well lit.
- Keep fingers, hair and loose clothing from moving parts and openings whilst using the Cordless upright.
- This appliance can be used by children aged from 8 years and above and persons with reduced physical, sensory or mental capabilities or lack of experience and knowledge if they have been given supervision or instruction concerning use of the appliance in a safe way and understand the hazards involved. Children shall not play with the appliance. Cleaning and user maintenance shall not be made by children without supervision.



Don'ts

- Don't charge the Cordless upright outdoors, or leave the charger connected to the mains when not in use.
- Don't use this Cordless upright if it has been dropped, damaged, immersed in water or left outdoors.
- Don't run over the charger cord or use Cordless upright if the charger cord or plug is damaged. Please contact our Customer Care Line on: 0330 026 8455 (Mon-Fri 0830-18-30 Sat 0900-1700).
- Don't handle the plug or use the Cordless upright with wet hands.
- Don't throw the Cordless upright or battery into fire or expose to high temperatures, as the Cordless upright contains a rechargeable Lithium-Ion battery which may cause damage or burst.



Do's

- Always make filter and dirt container are fitted correctly before using your Cordless upright
- Always turn off the Cordless upright and remove the battery before carrying out any maintenance
- Turn off all controls on the Cordless upright before disconnecting or connecting the battery
- Take extra care when cleaning on the stairs
- Always protect the charger cable from heated surfaces or near open flames

- Use only the Vax recommended charger and accessories with this Cordless upright.
- Turn off all controls on the Cordless upright before disconnecting or connecting the battery and before carrying out any maintenance.
- Take extra care when cleaning on the stairs.
- Always protect the charger cable from heated surfaces or near open flames.
- Use only CE approved 13amp extension cords, non-approved extension cords may overheat. Care should be taken to arrange the extension cord as it could be a trip hazard.
- Always carry the Cordless upright by the handle.
- Store your Cordless upright in a cool, dry area.

- Don't use the charger cord as a handle, pull the charger cord around corners or sharp edges or close a door over the charger cord. Don't unplug Cordless upright charger by pulling on the charger cord.
- Don't attempt to remove blockages with sharp objects as this may cause damage to your Cordless upright.
- Don't use the Cordless upright with incorrect voltage as this may result in damage or injury to the user. The correct voltage is listed on the ratings label.
- Don't vacuum up hot coals, cigarette butts, matches or smoking hot burning items or use in an area where there may be harmful fluids (chlorine, bleach, and ammonia drain cleaner).
- Don't vacuum up hard or sharp objects such as glass, nails, screws, coins, etc.

- Use only CE approved 13amp extension cords, non-approved extension cords may overheat. Care should be taken to arrange the extension cord as it could be a trip hazard
- Always carry the Cordless upright by the handle
- Store your Cordless upright in a cool, dry area
- Please keep instructions for further use.

PLEASE KEEP INSTRUCTIONS FOR FURTHER USE.

Thank you for buying this LiFE Cordless Vacuum.

Taking care of your floors

The LiFE is designed to make cleaning as quick and convenient as possible and this user guide will help you get the most out of your machine.

The LiFE is perfect for regular cleaning tasks on your floors.

Taking care of your LiFE Cordless Vacuum

Also inside this guide are instructions on maintaining your new machine, so that it's always ready when you are to tackle your floors.

Taking care of you

We're here if you need us. Instead of taking me back to the shop, simply visit:

vax.co.uk/support or call:

(UK) **0330 026 8455** (ROI) 1-800 928 308

Monday-Friday 8:30am to 6:30pm, Saturday 9:00am to 5:00pm

Calls are charged at the UK local rate. Please make a note of the serial number and model number of the product before calling.

Alternatively, you can write to us at:

Vax Ltd., Plot 302, Stonebridge Cross Business Park, Hampton Lovett, Droitwich, Worcestershire, WR9 0LW, UK

This user guide can be found online at: vax.co.uk/support

The Vax logo is displayed in a bold, orange, sans-serif font. The letters are lowercase, and there is a registered trademark symbol (®) to the upper right of the 'x'.

Let us know what you think @VaxUK

Contents

 Let's talk safety

 Getting to know your machine

 Getting started

 Using your machine

 Taking care of your machine

 Let's talk technical

 What to do if it goes wrong

 Getting in touch

 Notes

Dual Power

Included with your machine



Lithium-Ion Battery

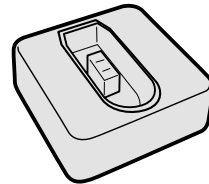

Docking station

Getting to know your machine

Handle

On/Off and brushbar control

Brushbar on/off indicator

Battery Charge Indicator

Battery Slot

Dirt Container

Floor Head

Filter Cap

Filter

Separator

Quick Release Button

Filter

Dirt Container
Release Clip

Floorhead
Removal Button

Technical Specification

Name **LiFE**

Code **U85-LF-B**

Part Number **1-1-135634**

Voltage **18v**

Weight **3.3kg**

Subject to technical change without notice.

Accessories & Consumables

Belt

1-3-129504-00

Filter (Type 77)

1-7-129456-00

Battery Pack

1-5-136719-08

Charger

1-5-136533-00

PLEASE READ 'LET'S TALK SAFETY' AT THE BEGINNING BEFORE USE

Assembling your LiFE cordless vacuum

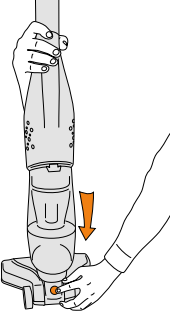

Line up floor head with the main body, push firmly together until floor head locks into place.

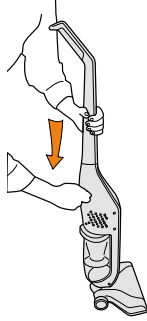

Push the handle into the main body.

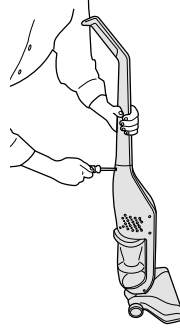

Insert screw from the rear of back panel and tighten with a cross head screwdriver

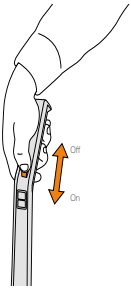

Roll the On/Off and brushbar control forward once for hard floor cleaning. The brushbar will NOT spin.

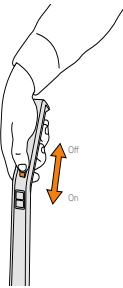

Roll the On/Off and brushbar control forward again for carpets. The brushbar will spin.

Using your machine

Operating your LiFE cordless vacuum

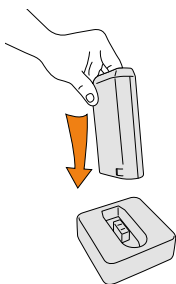

Plug charger into the mains. Push battery firmly into docking station. LED indicator will illuminate within 2 seconds if pushed in correctly. Initial charge should be for 10 hours.

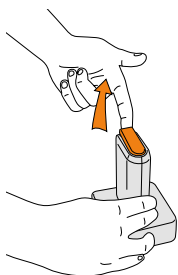

The light will fade in and out when fully charged. To remove battery, lift release flap while holding the docking station.

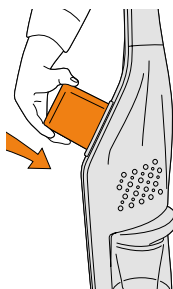

Before inserting the battery make sure On/Off and brushbar control: on machine is set to off.

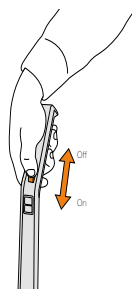

On/Off switch:
0 Off
I Hard floor
II Carpets



Place your foot on the floor head and pull the handle backwards to recline the machine.

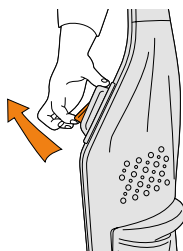

Lift release flap and pull battery to remove.

It is normal for the LED to flash/stay lit for up to 10 seconds after the battery is removed. If it still flashes after 10 seconds, unplug docking station and wait 10 seconds before re-trying.



CAUTION: When carpet mode is selected on the On/Off and brushbar control the brushbar will constantly rotate. Never leave the vacuum cleaner in one spot for an extended period of time as this may damage the floor surface. Vax cannot be held responsible for damage to the floor surface if the customer fails to take notice of this recommendation.

Taking care of your machine

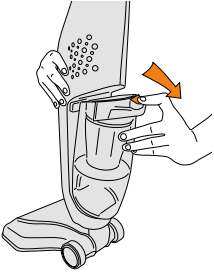

Push dirt container release clip to remove dirt container.

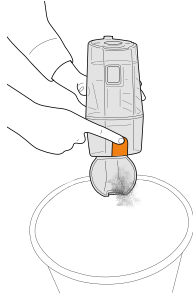

Press dirt container quick release button, allowing dirt to fall out.

Advanced Cleaning

Press the dirt container quick release button, to access separator. Twist the separator to unclip and pull, tap the separator over a bin and wipe clean.

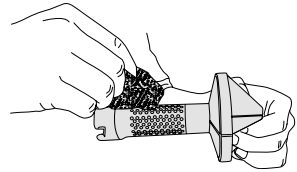
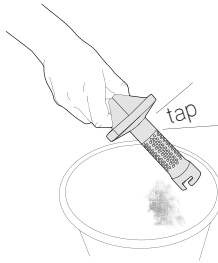
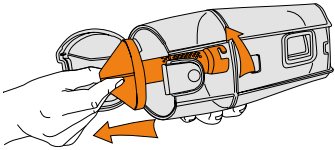

Taking care of your machine

Cleaning the filter

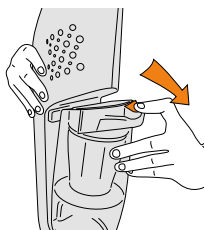

Push dirt container release clip to remove dirt container.

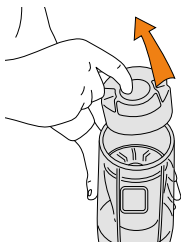

Pull lid of filter cap upwards.

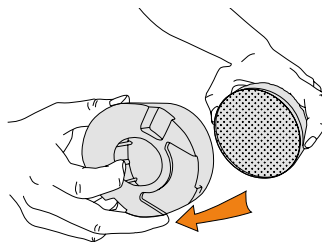

Remove the foam filter.

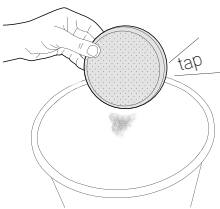

Tap the foam filter to remove any dust and debris.



Foam filter can be washed with water max 40°C.

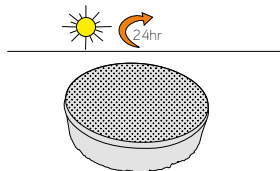

Leave at least 24 hours or until fully dry before replacing into the machine.

Removing blockages

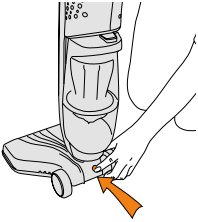

Press the floor head removal button to release the floor head from the main body.

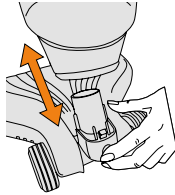

Remove any blockage and reassemble the machine.

Changing the brushbar/belt

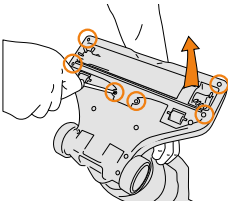

Remove screws as indicated on the floor head plate with a cross head screw driver. Lift floor head plate to access brushbar and belt.

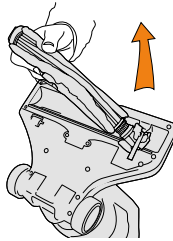

Lift the brushbar from housing and remove belt from motor spindle.

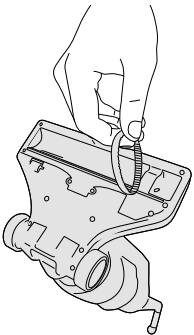

Loop the new belt around the motor spindle and brushbar. Insert the brushbar back into the floor head and replace floor head plate.

When changing the belt, this is the perfect time to clear any debris from your brushbar. Using a pair of scissors, cut through any threads or hair caught around the brushbar.



Let's talk technical

Machine: Battery Charge Indicator

All three LEDs will light momentarily when the power switch is turned on.

The battery charge indicator will then indicate remaining capacity as below:

3 LEDs lit – Remaining capacity is more than 75%

2 LEDs lit – Remaining capacity is more than 50%

1 LED lit – Remaining capacity is less than 25%

1 LED blinking – Remaining capacity is less than 25%

Docking Station: LED operations

LED lit, battery not in Docking Station	No charging is taking place	Normal condition
LED lit continuously	Battery is charging	Leave battery in Docking station
LED pulses (gradually dimming and brightening)	Battery is fully charged	Remove battery from Docking station

Docking Station: LED operations

Your cleaner uses a Lithium-Ion battery. When these batteries no longer recharge, they must be removed from the cleaner and recycled.

If you would like information on the correct disposal of batteries, we're here to help.

Simply call us on 0330 026 8455.

The battery is to be disposed of in one piece. Do not attempt to take apart.





What to do if it goes wrong

Problem

Why does my vacuum cleaner have no power?

Solution

- Check the battery is inserted correctly into the machine.
- The battery may not be charged, remove and charge battery.
- Battery might be too hot, remove and allow to cool for 30 minutes. Replace battery.
- The motor thermostat may have tripped. If this has happened, switch off the vacuum cleaner. Remove and empty the dirt container and check for blockages. Clean the filters and allow the vacuum cleaner to cool for approximately 1 hour (if you have washed the filters you will need to wait 24 hours for the filters to fully dry before putting them back into the vacuum cleaner).

Why won't the vacuum cleaner pick up?

- Empty the dirt container and clean filters. Go to the 'Taking care of your machine' page.
- There may be a blockage in the machine. Please remove the floor head from the main body, check and clear any blockages.
- The brushbar may not be turning. Go to 'My brushbar isn't turning?' below.

My brushbar isn't turning?

- The brushbar may not be switched on, please check the On/off and brushbar control.
- To check the belt, go to 'Changing the brushbar/belt' Go to 'Let's Talk Technical'.
- The brushbar may be blocked. Go to the 'Let's talk technical'.

Why isn't the LED lit when the battery is charging?

- Check the wall docking station is plugged in.
- Check the battery is inserted correctly into the docking station.
- The battery may not be connecting with the docking station. Remove battery and unplug docking station, wait 10 seconds then retry.

Why is the LED continually flashing?

- Check the battery is inserted correctly into the docking station.
- The battery or docking station has an error. Remove the battery and unplug docking station, wait 10 seconds then plug docking station into socket and re-fit the battery.

It's quick and easy to
register for your **FREE**

**2 year
guarantee***

Online at: **vax.co.uk/guarantees**

Please retain your original receipt for proof of purchase.

we're here if you need us

Online **vax.co.uk/support**

Call: (UK) **0330 026 8455** (ROI) 1-800 928 308

Monday-Friday 8:30am to 6:30pm, Saturday 9:00am to 5:00pm*

Alternatively, you can write to us at:

Vax Ltd, Plot 302, Stonebridge Cross Business Park, Hampton Lovett, Droitwich,
Worcestershire, WL9 0LW, UK

* Registration required. Terms and conditions apply.

* Calls are charged at the UK local rate. Please make a note of the serial number and model number of the product before calling.

GET IN TOUCH

 0330 026 8455  info@vax.co.uk  vax.co.uk  [VaxVacuums](https://www.facebook.com/VaxVacuums)  [@VaxUK](https://twitter.com/VaxUK)

EEC Statement of Compliance: Manufacturer/EEC importer: Vax Limited, hereby on our own responsibility, declare that the U85-LF-B is manufactured in compliance with the following Directives: **Safety:** 2006/95/EC Low Voltage Directive.
EMC: 2004/108/EC Electromagnetic Compatibility Directive.

Waste electrical products should not be disposed of with household waste. Please recycle where facilities exist. Check with your Local Authority or retailer for recycling advice.

© 2015 All rights reserved. VAX®, VAX Lozenge, are trade marks or registered trade marks of Techtronic Floor Care Technology Ltd.

