



OWNER'S MANUAL

CARAFE READY • T526S

IMPORTANT SAFEGUARDS

for Safe Operation & Use

When using electrical appliances, basic safety precautions should be followed, including the following:

1. Read and follow all of the instructions in this manual before using the brewer to avoid injury.
2. The brewer pumps extremely hot water! DO NOT touch hot surfaces.
3. Install the brewer in proper location as instructed in this manual.
4. Do not use accessory parts not recommended by Touch Coffee & Beverages, LLC. Using unauthorized accessory parts may result in fire, electrical shock or injury to persons.
5. Do not place on or near a hot gas or electric burner, or in a heated oven.
6. The brewer is designed for indoor use only! Do not use the brewer outdoors or near damp areas.
7. Do not immerse the electrical cord or the brewer in water or any other liquid, as this may result in fire, electric shock and injury to person.
8. Do not overfill the Water Tank with water.
9. Only use water to fill the Water Tank. Do not put any other liquids or foods in the Water Tank unless instructed otherwise to clean the brewer in this manual.
10. Unplug the brewer from the outlet when not in use and before cleaning it. Allow the brewer to cool before putting on or taking off parts.
11. Plug the electrical cord into its own dedicated electrical outlet with ground to reduce the risk of an electrical shock and to prevent the fuse and circuit breaker from tripping.
12. The electrical cord comes with a grounding wire with a grounding plug to reduce the risk of electrical shock. The electrical cord must be plugged into a 3-prong properly grounded outlet.
13. If your outlet is a 2-prong wall outlet, then it is your personal responsibility and obligation to have it replaced with a properly grounded 3-prong wall outlet.
14. Consult a qualified electrician to replace a 2-prong wall outlet with a 3-prong grounded wall outlet. If the grounding instructions in this manual are not clear, then consult a qualified electrician.
15. Do NOT cut or remove the third (ground) prong from the power cord.
16. Do not run the electrical cord through high traffic area or near hot surfaces.
17. Adult supervision is necessary when the brewer is used by or near children.
18. Do not open the brewer cover when the brewer is brewing a beverage.
19. Keep the lid closed on the Water Tank unless the Water Tank is being refilled with water.
20. Do not use the brewer for other than its intended use.
21. Do not modify or alter the brewer in any way.
22. Do not place smashed or damaged Pods in the brewer.
23. Do not use modified pods in brewer. (ex. Pods that have been reused with tapes and adhesives)
24. Do not operate the brewer unattended.
25. Do not let the electrical cord hang over an edge of table or counter, or touch hot surfaces.
26. Extreme caution must be used when moving the brewer containing hot liquids.
27. To unplug the brewer, turn OFF the brewer first, then unplug the electrical cord from the outlet.

SAVE THESE INSTRUCTIONS

Warning to users and parents

1. Brewer injects **EXTREMELY HOT WATER!** DO NOT let children use the brewer without adult supervision.
2. After brewing cocoa or soluble, **IMMEDIATELY RUN** an 8 oz. brew cycle without the Pod in the brewer to rinse the brewer. This will avoid clogging up the two Needles in the Red Cup Holder.
3. Disconnect electrical cord immediately if brewer begins to malfunction.
4. Do not place fingers directly under the spout while brewer is operating - This may result in burning your fingers and scalding.



WARNING

CAUTION: There is one (1) sharp Needle underneath the Cover, and two (2) sharp Needles inside the Red Cup Holder. Do not put your fingers in the Red Cup Holder.

CAUTION: **EXTREMELY HOT WATER** is injected into the Red Cup Holder during the brewing process. DO NOT lift the Cover during the brewing process.

CAUTION: Keep the brewer in its upright position and place the brewer on a dry surface.

CAUTION: 120V 60Hz / 12.5A / 1500W

EXTENSION CORD INSTRUCTIONS: In the event that a longer extension cord is necessary: make sure (1) the marked electrical rating of the extension cord exceeds or meets the electrical rating of the brewer; (2) arrange the cord so that it does not drape over the countertop and it cannot be pulled on by children or tripped over unintentionally; and (3) the extension cord has a 3-prong grounding plug.

THIS PRODUCT IS FOR HOUSEHOLD USE ONLY. c



WARNING

THIS PRODUCT CONTAINS CHEMICALS, INCLUDING LEAD, WHICH IS KNOWN TO THE STATE OF CALIFORNIA TO CAUSE CANCER, BIRTH DEFECTS OR OTHER REPRODUCTIVE HARM.



WARNING

RISK OF FIRE OR ELECTRIC SHOCK, DO NOT OPEN.

TO REDUCE THE RISK OF FIRE OR ELECTRIC SHOCK, DO NOT REMOVE THE BOTTOM COVER. NO USER SERVICEABLE PARTS ARE INSIDE. REPAIR SHOULD BE DONE BY AUTHORIZED SERVICE PERSONNEL ONLY.

TABLE OF CONTENTS

Using Touch's T526S Brewing System

PART 1. SET-UP

Helpful Hints	5
Unpacking Instructions	5
Product Features	6

PART 2. BREWING A CUP

Setting Up Your Brewer	7
Ready to Brew Your First Cup	9
Stopping the Brew Process	11
Brewing Iced Beverages	11
Purging the Brewer	11
Adding Water	12

PART 3. BREWING A CARAFE

Brew Your Family Size Coffee	13
------------------------------------	----

PART 4. MAINTENANCE

Cleaning External Parts	14
Cleaning the top needle	14
Cleaning the Red Cup Holder	15
Cleaning the two bottom needles	15
Cleaning the Water Tank & Water Tank Lid	16
De-scaling Your Brewer	17

PART 5. TROUBLESHOOTING

19

PART 6. WARRANTY

21

PART 1. SET-UP

Helpful Hints

1. Plug the brewer's electrical cord into its own grounded outlet. If the same outlet is used with another electrical appliance, then the electrical circuit may be overloaded causing the fuse or the circuit breaker to trip.
2. Filtered or bottled water is recommended for best tasting coffee, tea or hot cocoa.
3. Use K-Cup® pack to brew 8-10 oz cup of coffee; use our XBold cup (packed with more coffee) to brew 10 -14 oz cup of coffee; and use our XLarge cup to brew strong 12 -18 oz cup of coffee; and use our Refill Jumbo Cup to brew strong 26 oz of coffee into the Carafe.
4. T526S model offers seven cup sizes (6 oz, 8 oz, 10 oz, 12oz, 14 oz, 16 oz, 18 oz), and one (CARAFE for 26 oz) family size for use with the Reill Jumbo Cup and Carafe.
5. Remove the Pod from the Red Cup Holder after each use.

CAUTION: POD IS HOT!

6. De-scale the brewer regularly. Please see pages 18 and 19 for instructions.

Unpacking Instructions

1. Place the brewer box on a large steady surface (such as a table or countertop) or on the floor. Open the box.
2. Remove the enclosed literature. Turn the box on its side with front of the box face down.
3. Reach into the box and grasp the plastic bag that contains the brewer.
4. Carefully pull the plastic bag (and packaging materials) toward you and out of the box. The brewer will still be encased in the styrofoam and be on its side.
5. Remove the top styrofoam packaging material.
6. Carefully lift the brewer off of the bottom styrofoam and place it upright on a flat, steady surface.
7. Lift plastic bag off of the brewer.
8. Record the serial number for this brewer. The serial number can be found on the bottom of the brewer.
9. Place the brewer upright on a flat, steady surface.

We recommend you save all packing materials in case future shipping of the product is necessary.

WARNING: Keep all plastic bags away from children.

Touch Coffee & Beverages is NOT affiliated with Keurig, Inc. Keurig® and K-Cup® are register trademarks of Keurig, Inc.

PART 1. SET-UP

Product Features

T526S Brewer parts

- A** Cover
- B** Cover Handle
- C** Red Cup Holder
- D** Deep Well
- E** Housing
- F** Power Cord
- G** Drip Tray Slots
- H** Drip Plate
- I** Drip Tray
- J** Water Tank
- K** Water Tank Lid
- L** Refill Jumbo Cup
- M** Carafe

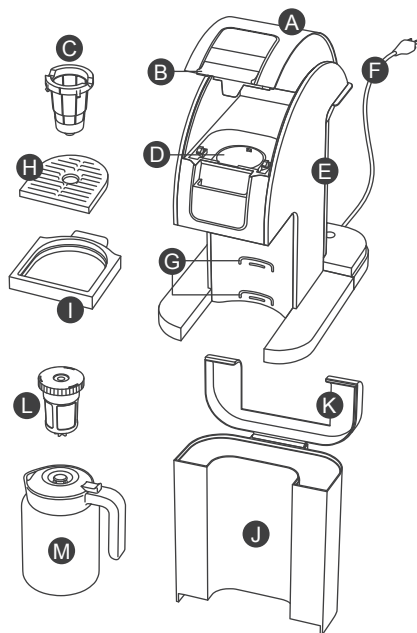

Controls and Indicators

- N** Power Button
- O** Low Water Indicator
- P** Brewing Indicating Light
- Q** 6 oz Button
- R** 8 oz Button
- S** 10 oz Button
- T** 12 oz Button
- U** 14 oz Button
- V** 16 oz Button
- W** 18 oz Button
- X** Carafe Button
- Y** Latch
- Z** MAX & MIN Fill Line

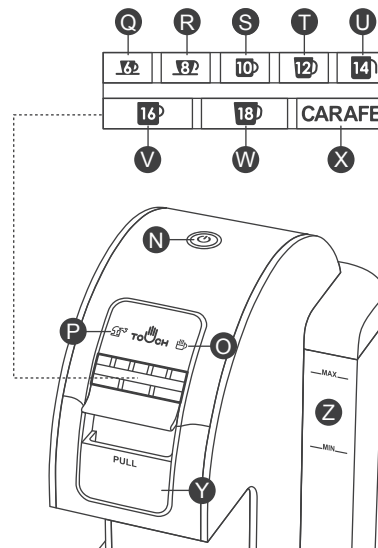

PART 2. BREWING A CUP

Setting Up Your Brewer

IMPORTANT: DO NOT use the brewer until it has been set-up for its first use.

NOTE: If the brewer has been exposed to temperatures below freezing, allow the brewer at least two hours to reach room temperature before using it. A frozen or extremely cold brewer may not operate properly.

1. Unwrap the electrical cord and remove all pieces of adhesive tapes.
2. Remove the Water Tank from the brewer (Fig. 1) by Tilting and Lifting away from the brewer. (it may be tight)
3. Rinse the Water Tank with fresh water. Fill the Water Tank with bottled or filtered water but NOT beyond the MAX Fill Line. (Fig. 2)
4. Return the Water Tank back into the rear side of the brewer and be sure the Water Tank sits properly on the rear base of the brewer.
5. Place a large mug or cup (12 oz minimum) on the Drip Tray. (Fig. 3)
6. Plug the brewer into a 3 prong-grounded outlet. (Fig. 3)
7. Press the Power Button on top of the brewer. The blue Power Light will illuminate. (Fig. 3)

NOTE: DO NOT insert a Pod into the Red Cup Holder at this time.

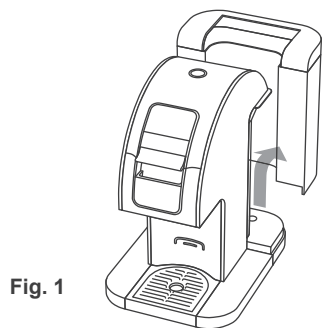

Fig. 1

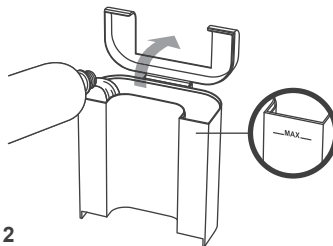

Fig. 2

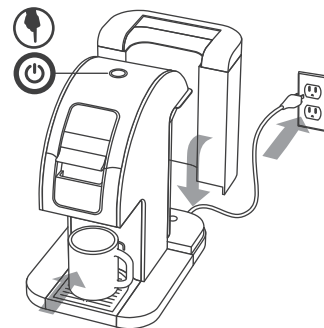

Fig. 3

PART 2. BREWING A CUP

Setting Up Your Brewer (Continued)

CAUTION: DO NOT pull the Latch to open the Cover during the brewing period. (Fig. 4)

CAUTION: Extremely Hot Water! (Fig. 5)

8. With the cover closed, press the 10 oz Button to start the brewing cycle. (Fig. 5) The brewing indicating light on the upper right corner will stay ON while the brewer is warming up. Note that the brewer will pump the water to the Water Tank while warming up. This is normal and it may take up to 30 seconds to warm up from a cold start. The brewing indicating light will start to blink when the brewing cycle starts.

CAUTION: DO NOT remove the mug until the brewing indicating light stops blinking.

9. Once the brewing is done, remove the mug and pour the hot water into the sink. Discard the hot water and repeat cleansing by repeating the brewing cycle at least two (2) more times. (Fig. 6)
10. The one-time set-up process is now complete and the brewer is now ready.

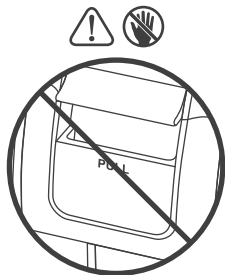

Fig. 4

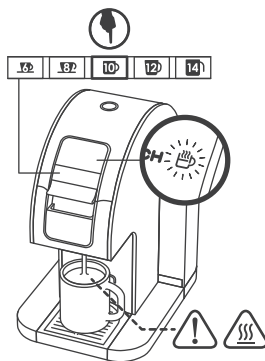

Fig. 5

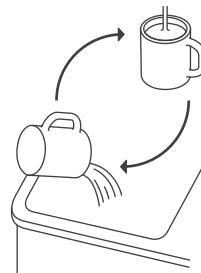

Fig. 6

PART 2. BREWING A CUP

Ready to Brew Your First Cup

1. Make sure the brewer is powered ON. Place a cup or mug on the Drip Tray.
2. Pull on the Latch to open the Cover. (Fig. 7) Insert a desired Pod into the Red Cup Holder. (Fig. 8)

NOTE: DO NOT remove the foil lid or puncture the Pod. (Fig. 8) When using a smaller cup, the Drip Tray may be inserted into the Upper Slot to minimize splattering of coffee. (Fig. 7)

CAUTION: There are three sharp Needles that puncture the Pod: a top Needle underneath the Cover and two bottom Needles in the Red Cup Holder. To avoid risk of injury, do not put your fingers in the Red Cup Holder. (Fig. 8)

3. Close the Cover by pressing down on the Cover Handle. (Fig. 9)
4. Press on the desired cup button (6, 8, 10, 12, 14, 16, or 18). (Fig. 9) Recommendation: Use 6-10 cup size with regular K-Cup® portion pack; use 10-14 cup size for our XBold cups; use 14-18 cup size for our XLarge cups; and use Carafe button with our Refill Jumbo Cup and Carafe.

Touch Coffee & Beverages is NOT affiliated with Keurig, Inc. Keurig® and K-Cup® are register trademarks of Keurig, Inc.

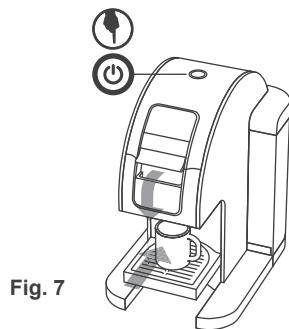

Fig. 7

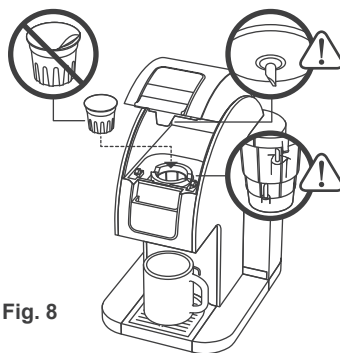

Fig. 8

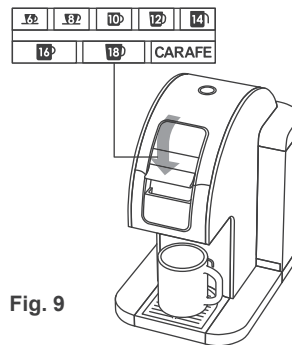

Fig. 9

PART 2. BREWING A CUP

Ready to Brew Your First Cup (Continued)

NOTE: If you do not push a cup size button to start brewing within 60 seconds, the brewer will be disabled to prevent accidental activation. Re-activate the Brewer by pulling on the Latch and Closing the Cover again.

5. The upper right brewing indicating light will stay ON during warm up, and the light will BLINK during the brewing cycle. (Fig. 10)

CAUTION: The brewer will heat the water EXTREMELY HOT during the brewing process. To avoid risk of injury, do not pull on the Latch or open the Cover while brewing. Contents will be EXTREMELY HOT! (Fig. 10)

6. If the brewer has been OFF for some time before turning ON the brewer, there may be a short pause up to 30 seconds before the brewing process starts.

At the end of the brewing process, the brewer will pump water to the Water Tank and a burst of air to purge the Pod of remaining liquid.

7. Enjoy your cup of coffee, tea or hot cocoa! (Fig. 11)

8. Pull the Latch and dispose of the used Pod. (Fig. 12)

CAUTION: Pod will be HOT! (Fig. 12)

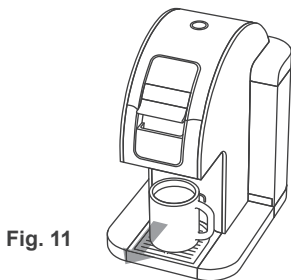
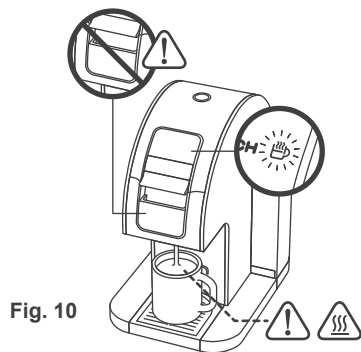

PART 2. BREWING A CUP

Stopping the Brew Process

If you need to stop the brewing process for any reason, then press on the Power Button to turn OFF the brewer.

NOTE: If the brewer is turned ON after terminating the previous brewing process, the next brewing cycle may NOT brew a full cup. We recommend performing a brewing cycle without the POD, and then restart the brewing cycle with a POD in the Red Cup Holder.

Brewing Iced Beverages

Place a tall cup filled with ice on the Drip Tray (the Drip Tray Assembly can be removed to accommodate taller cups), choose your favorite Pod and press the desired cup size button.

Purging the Brewer

If your brewer has not been used for more than one week, we recommend emptying the water in the Water Tank and brew one cup without the POD. Then start a brewing cycle with a Pod.

CAUTION: Extremely Hot Water!

PART 2. BREWING A CUP

Adding Water

The upper left blue Low Water Light will blink when the water level in the Water Tank is low or if the Water Tank has been removed. (Fig. 13) The brewer will not allow you to brew while the blue Low Water light is blinking. The brewer will shut off automatically if the Water Tank is not refilled within about 2 minutes. The Water Tank can be filled in two ways.

1. Open the Water Tank Lid and pour water directly into the Water Tank up to the MAX Fill Line while the Water Tank is still attached to the brewer. (Fig. 14) After the Water Tank is filled with water, close the Lid.
2. Remove the Water Tank from brewer by tilting and lifting away from the Water Tank away from the brewer. Open the Lid, and fill the Water Tank with water but not more than the MAX Fill Line. Place the Water Tank back on to the rear base of the brewer and close the Lid. (Fig. 15)

IMPORTANT: DO NOT remove the Water Tank during the brewing process.

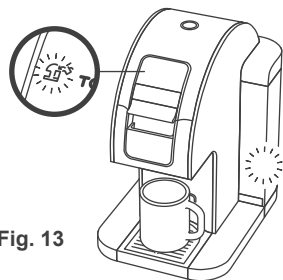

Fig. 13

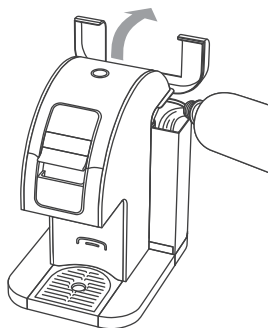

Fig. 14

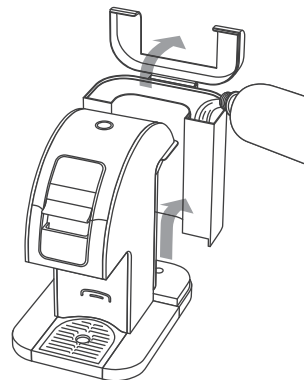

Fig. 15

PART 3. BREWING A CARAFE

Brew Your Family Size Coffee

1. Twist the Lid off from the Refill Jumbo Cup.
2. Pack a desire amount of your own grind coffee into the Refill Jumbo Cup.

NOTE: To fill a Travel Mug, pack just above the Minimum Fill Line, and use the 16 or 18 oz button. To fill a Carafe, pack up to the Maximum Fill Line, and use the Carafe button. (Fig. 16)

3. Twist back on the Lid to the Refill Jumbo Cup.
4. Open the Cover and remove the Red Cup Holder from the Brewer, and insert the Refill Jumbo Cup in its place. (Fig. 17)
5. Remove the bottom Drip Tray (Fig. 17), and place the Carafe in its place. (Fig. 18)
6. Press the Carafe Button to start brewing. (Fig. 18)
7. Once the brewing is done, open the Cover and remove the Refill Jumbo Cup and clean it for later use.

CAUTION: DO NOT overpack. Refill Jumbo Cup will be HOT!

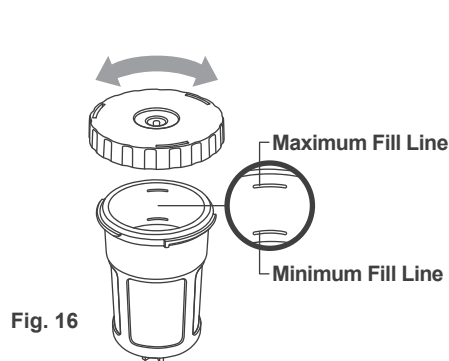

Fig. 16

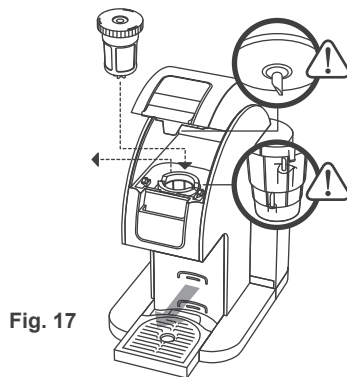

Fig. 17

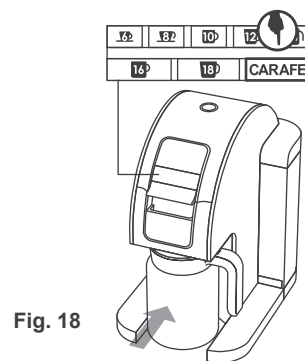

Fig. 18

PART 4. MAINTENANCE

Cleaning External Parts

We recommend regularly cleaning the brewer's external components.

CAUTION: Only use a moist cloth and if necessary a mild detergent (never use abrasive or aggressive detergents). Do not wash machine parts in the dishwasher. (Fig. 19)

1. Use damp non-abrasive cloth for cleaning the exterior of the brewer. Never immerse the brewer in water or use a dishwasher to clean the brewer. (Fig. 19)
2. The Drip Tray can accumulate up to 6 oz. of overflow. To drain the Drip Tray, remove the Drip Tray by pulling on it and discard the liquid. (Fig. 20) Use damp non-abrasive cloth to clean the Drip Tray. (Fig. 20) DO NOT use a dishwasher to clean the Drip Tray.

Cleaning the top Needle

1. Double check the top Needle underneath the Cover (Fig. 21) to see if it is clear of coffee grind.
2. If the top Needle is clogged, then use a paper clip or tooth brush to clean the Needle. (Fig. 21) DO NOT insert the paper clip to deep inside the needle.

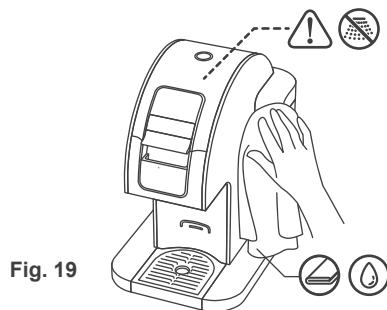

Fig. 19

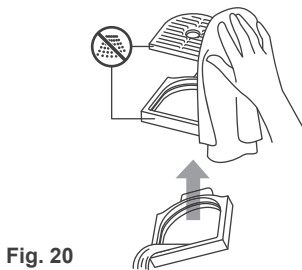

Fig. 20

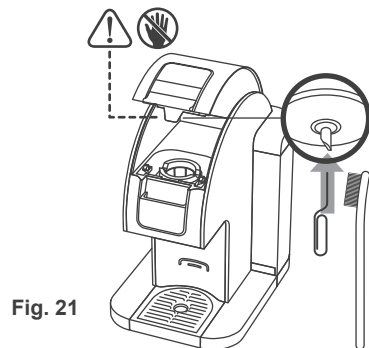

Fig. 21

PART 4. MAINTENANCE

Cleaning the top Needle (Continued)

CAUTION: Top Needle is very sharp. To avoid risk of injury, do not directly touch this Needle with your finger. (Fig. 21)

Cleaning the Red Cup Holder

1. Open the Cover, and remove the Red Cup Holder from the brewer by pulling on it. (Fig. 22)
2. Immerse the Red Cup Holder in to hot water for five (5) minutes (Fig. 23), and rinse with warm water.
3. Insert the Red Cup Holder back into the brewer.

Cleaning the two bottom Needles

1. There are two bottom Needles inside the Red Cup Holder. Pull down the bottom funnel from the top Holder. (Fig. 24)
2. Check to make sure the two Needles are not clogged.
3. If the two bottom Needles are clogged, then use a paper clip or tooth brush to clean the Needles, and rinse with warm water. (Fig. 25)

CAUTION: There is a sharp Needle underneath the Cover and two sharp Needles inside the Red Cup Holder. To avoid risk of injury and do not put your fingers in the Red Cup Holder. (Fig. 25)

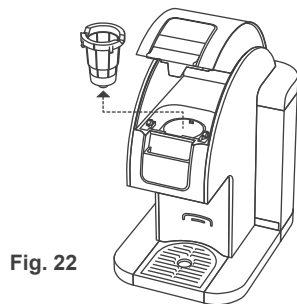

Fig. 22

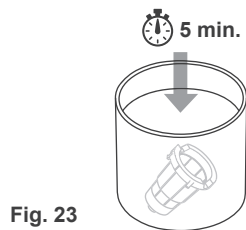

Fig. 23

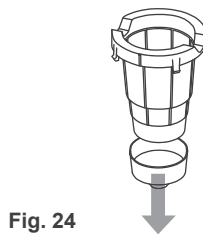

Fig. 24

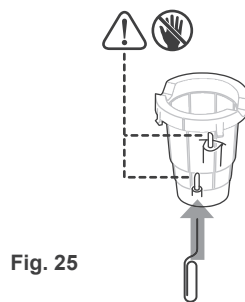

Fig. 25

PART 4. MAINTENANCE

Cleaning the Water Tank & Water Tank Lid

CAUTION: DO NOT use a dishwasher to clean the Water Tank and its Lid.

1. Remove the Water Tank from brewer by tilting and lifting away from the Water Tank away from the brewer. (Fig. 26)
2. Open the Lid, and clean with a damp non-abrasive cloth and rinsed thoroughly. (Fig. 27)
3. To clean the Filter Screen at the base of the Water Tank. (Fig. 27) Empty the Water Tank and spray the filter screen with high pressure water. (Fig. 28)
4. Place the Water Tank back on to the brewer and close the Lid.

NOTE: If a water filtering system is being used inside the Water Tank, remove the water filtering system before cleaning.

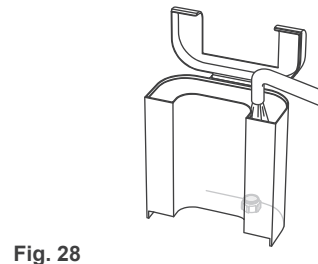
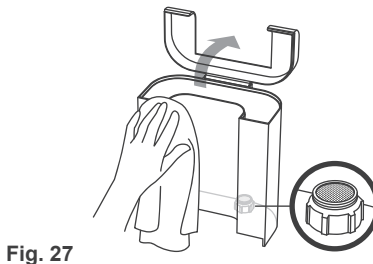
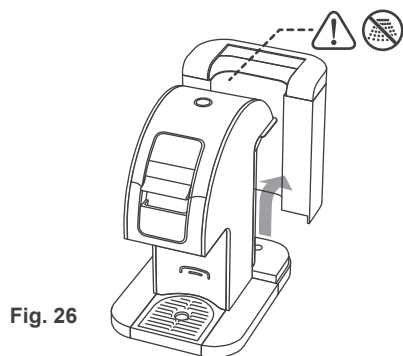

PART 4. MAINTENANCE

De-scaling Your Brewer

Depending on the quality of your water supply, calcium and scale may build up inside the brewer. Scale is non-toxic but build up of scale can hinder brewer performance. We recommend de-scaling the brewer every 3-6 months depending on the brewer usage. Follow these instructions for de-scaling:

ITEMS NEEDED: large ceramic mug (do not use a paper cup), fresh water, 58 oz. of vinegar, and access to a sink.

STEP 1: DE-SCALING SOLUTION RINSE

1. Turn the brewer OFF and empty the Water Tank.
2. Pour 58 oz. of white vinegar into the Water Tank. (Fig. 29) Turn ON the Brewer.
3. Place a large mug on the Drip Tray and run a brewing cycle by pressing on the 14 oz Button. Do not use a Pod. (Fig. 30) Throw away the vinegar in the mug into the sink. (Fig. 31)
4. Repeat the same 14 oz brewing cycle process 2 more times. Let the brewer stand for at least 3 hours.
5. Throw away remaining vinegar in the Water Tank. Rinse the water tank thoroughly.

Fig. 29

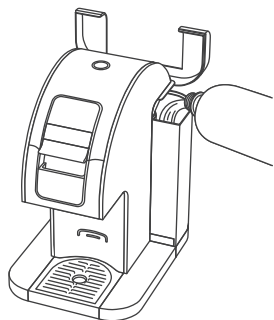

Fig. 30

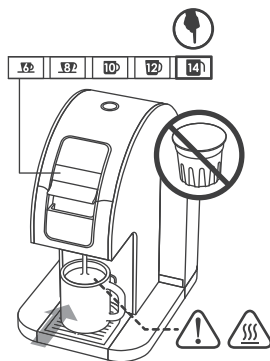
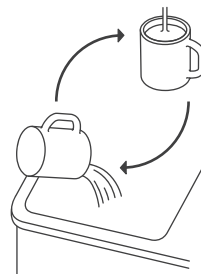

Fig. 31



PART 4. MAINTENANCE

De-scaling Your Brewer

STEP 2: FRESH WATER RINSE

1. Fill the Water Tank with fresh water but not beyond the MAX Fill Line. (Fig. 32)
2. Place a large mug on the Drip Tray and press the 14 oz button without a Pod. (Fig. 33) Throw away the heated water into the sink. (Fig. 34)
3. Repeat the brewing process until you have completed at least 10 brewing cycle using the 14 oz Button. You may need to refill the Water Tank several times during this process.
4. Turn OFF and unplug the brewer. If there are any de-scaling solution in the Water Tank, discard the solution, rinse the Water Tank thoroughly and refill with fresh water.
5. Plug the brewer back into the electrical socket, turn ON the power. The brewer should begin to function normally as the solution is rinsed out and the scale is removed.

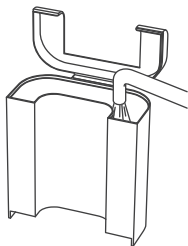

Fig. 32

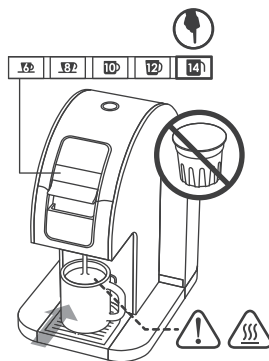

Fig. 33

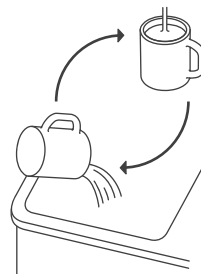

Fig. 34

PART 5. TROUBLESHOOTING

Brewer does not have power.

- Plug the brewer into an independent outlet.
- Check to be sure that it is plugged in securely.
- Plug into a different outlet.
- Reset your home's circuit breaker, if necessary.
- Make sure that the Power Button has been turned ON and the Power Light is illuminating.

Brewer will not brew.

- If the upper left blue Low Water Light is blinking, then add water to the Water Tank. Make sure the Water Tank is seated and secured in properly on its base.
- If the blue Low Water light continues to blink after refilling the Water Tank, double check to make sure the Water Tank is secured properly behind the brewer.
- Double check the top needle underneath the cover to see if it is clear of coffee grind. If the top needle is clogged use a paper clip or tooth brush to unclog the top needle.
- Check to make sure Pod is not damaged.

Brewing a partial cup.

- Double check the top needle to see if it is clogged. If so, unclog the top needle using a paper clip or a tooth brush.
- Double check the Red Cup Holder to see if the two bottom needles are clogged. If they are clogged, then use a paper clip or a tooth brush to clean the two bottom needles.
- De-scale the brewer using the steps in PART 4.
- If you have repeated the de-scale procedure on your brewer two times and it is still only brewing a partial cup, contact Customer Service.

Brewer shuts off automatically.

- The brewer is designed to automatically turn OFF after 30 minutes of non-use to conserve power.
- If the blue Low Water Light is blinking, then add water to the Water Tank. Make sure the Water Tank is secured properly on its base.
- Double check the top needle underneath the cover to see if it is clear of coffee grind. If the top needle is clogged use a paper clip or tooth brush to unclog the top needle.

PART 5. TROUBLESHOOTING

- On a rare occasion, the brewer may shut OFF while brewing. This may happen if the water in the water tank is too hot. This is done to protect the heating mechanism in the brewer. If this happens, let the brewer cool down and replace the water in the water tank with room temperature water. If the brewer continues to shut OFF while brewing after replacing the water, please contact the customer service.

Water appears in the Brewer base with the Water Tank removed.

- It is normal for a small amount of water to collect if the Water Tank is not sitting properly on the brewer. This will not affect the operation of the brewer. If excessive amount of water continues collect underneath the Water Tank, then contact Customer Service.
- Remove the Water Tank from the Brewer.
- Use clean cloth or paper towel to dry the base of the brewer.
- Return the Water Tank back to the rear of the brewer

The Brewed Water is not Hot Enough.

- The water temperature can depend on the water temperature inside the Water Tank. If you recently filled the Water Tank with cold water, then brewed water may not seem hot as usual. Pour some warm water into the Water Tank so that water temperature is about 24°C or 75°F.
- If the room temperature is cold such as during the winter, then the water temperature in the Water Tank may be too cold. Pour some warm water into the Water Tank so that water temperature is about 24°C or 75°F.

If any problems persist, contact Customer Service at the number noted on the back of this manual.

PART 6. WARRANTY

Limited One Year Warranty

Touch Coffee & Beverages, LLC, warrants that your brewer will be free of defects in materials or workmanship under normal home use for one year from the date of purchase. It is recommended that you fill out and return the warranty card enclosed with the brewer so that the purchase information will be stored in our system. Touch will, at its option, repair or replace a defective brewer without charge upon its receipt of proof of the date of purchase. If a replacement brewer is necessary to service this warranty, the replacement brewer may be new or reconditioned. If a replacement brewer is sent, a new limited one year warranty will be applied to the replacement brewer.

This warranty only applies to brewers operated in the United States and Canada. This warranty gives you specific legal rights, and you may also have other rights that vary from state to state and, in the case of Canada, from province to province.

What is not covered by the Limited Warranty?

THIS WARRANTY DOES NOT COVER CONSEQUENTIAL OR INCIDENTAL DAMAGES SUCH AS PROPERTY DAMAGE AND DOES NOT COVER INCIDENTAL COSTS AND EXPENSES RESULTING FROM ANY BREACH OF THIS WARRANTY, EVEN IF FORESEEABLE. Some states or provinces do not allow the exclusion or limitations of incidental or consequential damages, so the above limitation or exclusion may not apply to you depending on the state or province of purchase.

Nor does this warranty cover damages caused by use accessories, services performed by anyone other than Touch or its authorized service providers, use of parts other than genuine Touch® parts, or external causes such as abuse, misuse, inappropriate power supply or acts of God.

Other Limitations

THIS WARRANTY IS EXCLUSIVE AND IS IN LIEU OF ANY OTHER EXPRESS WARRANTY, WHETHER WRITTEN OR ORAL. IN ADDITION, TOUCH HEREBY SPECIFICALLY DISCLAIMS ALL OTHER WARRANTIES WITH RESPECT TO THE TOUCH'S BREWER, INCLUDING ANY IMPLIED WARRANTY OF MERCHANTABILITY OR FITNESS FOR ANY PARTICULAR PURPOSE. Some states or provinces do not allow disclaimers of such implied warranties or limitations on how long an implied warranty lasts, so the above limitation may not apply to you depending on the state or the province of purchase.

PART 6. WARRANTY

Limited One Year Warranty

How do you obtain warranty service?

Touch® brewers are high-quality appliances and, with proper care, are intended to provide years of satisfying performance. However, should the need arise for warranty servicing, simply call Touch's Customer Service number provided on back of this manual. Please do not return your brewer for servicing without first speaking to Touch Customer Service to obtain a Return Merchandise Authorization (RMA) number. Touch brewers returned without an RMA number will be returned to the sender without servicing.

Touch is committed to your satisfaction. If you have questions, just give us a call to have them answered quickly without leaving the comfort of your home.

Touch Coffee & Beverages, LLC
15312 E. Valley Blvd. City of Industry, CA. 91746 U.S.A
www.touchbeverages.com

PART 6. WARRANTY

Warranty / Registration

Serial Number

The serial number can be found on the bottom of the brewer and on the side of color box.

Date of Purchase

Where did you purchase your brewer?

Mr./ M./Sr.

First Name

Last Name

Address

State

State

Zip Code

Phone Number

E-mail Address

☐

I would like to receive product news and information and special offer as described in your Privacy Policy at [www.touchbeverages.com / privacy-policy](http://www.touchbeverages.com/privacy-policy).

Mail the Warranty and Registration Card to:

Touch Coffee & Beverages, LLC

15312 E. Valley Blvd. City of Industry, CA. 91746 U.S.A



For Household Use Only

To learn more about Touch, visit www.touchbeverages.com or Call Toll-Free: 844-20TOUCH (844-208-6824)

© 2014 Touch, Incorporated All rights reserved