

**Galaxy**



**Aqua 3500M**

**Electric Shower**

**The ideal replacement electric shower, loaded with many enhanced features including lime scale protection...**

- **Multiple connection possibilities**
  - 8 cable entry points
  - 6 water entry points
  - Twin terminal block positions
  - Dual water inlet positions
- **Stop/Start button**
- **ScaleCheck™ reduces lime scale build up**
- **Cold, eco and high power settings**
- **TempSure™ water temperature and pressure regulation**
- **Chrome Showerhead - 6 spray patterns**
- **SlideFit™ riser rail kit and soap dish**
- **1.25 metre anti-kink chrome hose**
- **2-Year guarantee**
- **Made in Britain**

# Galaxy

## Aqua 3500M



**MADE IN BRITAIN**



**Aqua 3500M**  
Electric Shower

## SPECIFICATION OVERVIEW



**MADE IN BRITAIN**



**2year**  
warranty

# SIMPLE OPERATION - EASY TO USE CONTROLS



## • Three Power Settings:

Cold: Ideal for rinsing

Eco: Uses half power, ideal during summer months for even lower running costs

High: Full power when cold winter months.

## • Temperature Dial:

Turn the dial to control the flow of water and adjust the temperature of the water.

## • Stop/Start Button:

The quick and convenient way to start your electric shower, retaining the settings selected by the previous user.

# Galaxy

MADE IN  
BRITAIN



## DID YOU KNOW?

*Galaxy showers are designed and built in Britain and have been for over 15 years. We are showering experts, making products specifically designed for our customers to better cope with installation challenges and in use issues. Galaxy showers provide perfect solutions for invigorating, refreshing and enjoyable showering every time...*

## Aqua 3500M

Electric Shower

# PERFECT TEMPERATURE SHOWERING COMFORT

*Galaxy has over 15 years experience of designing and manufacturing electric showers in the UK.*

***TempSure™** is a feature which we now include on several of our Galaxy showers. It ensures a safe and comfortable shower for all the family. Temperature fluctuations are minimised by constantly compensating for changes in water pressure whilst a thermal cut out will stop water heating should the temperature become unsafe.*



**Galaxy TempSure™ is an additional fully automatic temperature control system, located inside the shower, to ensure a comfortable showering experience time after time...**

# Galaxy



**Peace  
of Mind**

*Galaxy showers are built to exceed our own rigorous standards. All of our showering products leave our factory in Peterborough with our TWO YEAR GUARANTEE as standard.*

*In the unlikely event that anything should need looking at our customer support team is second to none. Our Customer Support Helpdesk at our Peterborough Office is on hand, along with our network of service engineers. We'll keep you shower working just as originally intended.*

**2year  
warranty**

**Aqua 3500M**  
Electric Shower

# IS HARD WATER RUINING YOUR SHOWER?

## Do you live in a hard water area?

Have you experienced problems with lime scale? Much of the UK has medium to hard water and can suffer from scale problems. You might see signs of scale build up around your home, in your kettle or around your taps for instance.

Scale can also build up unseen on the inside of many showers, covering the heating elements, which affects shower performance and over time can bring your shower to a premature end.

Galaxy **ScaleCheck™** is advanced thermal management which reduces the chance of lime scale build up within the shower system, clearing all of the heated water from inside the shower after use, to prevent scale from building up. This prolongs both the life and the efficiency of your electric shower.

Choose the **Galaxy Aqua 3500M** for Scale Protection

## UK: Hard Water Area Map

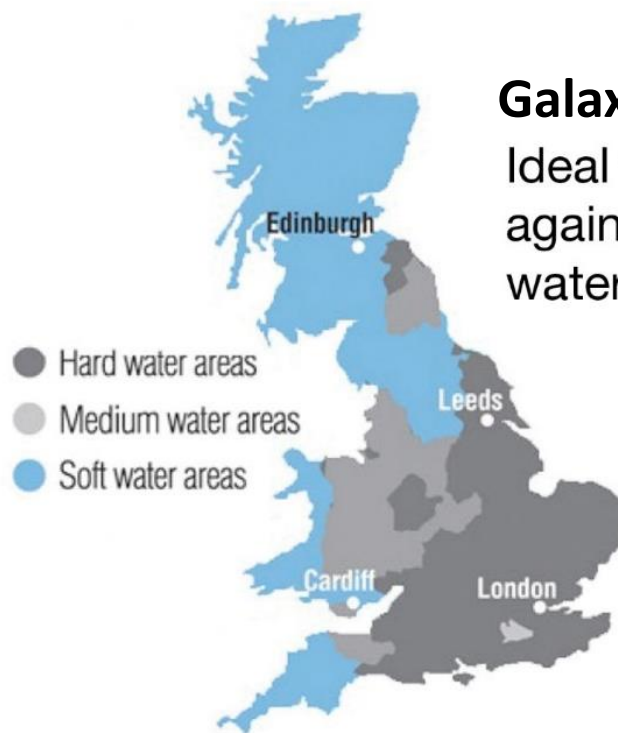

## Galaxy ScaleCheck™

Ideal for protection against scale in hard water areas



**Galaxy**

ScaleCheck™

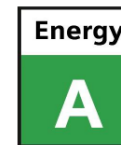

## Why choose an Electric Shower?

They provide a quick and effective solution to showering. Requiring only a permanent mains electric connection and a mains cold water supply, they are easier to install since no hot water supply is needed.

The electric shower instantly heats cold water on demand any time of day or night, so will not draw off your stored hot water supply. What's more only the water used for showering is heated, so running costs are efficient (A rated). It's good to know that should your boiler fail you can still have a hot shower with an electric shower. Galaxy showers are perfect for inclusion, whether updating a bathroom, creating a cloak room or an en-suite room.

**Aqua 3500M**  
Electric Shower

# MULTIPLE ENTRY POINTS – EASIER INSTALLATION



At Galaxy we know that replacing an existing shower can be challenging. Our Aqua 3500M has been designed to make the replacement process quick and easy.

Galaxy FlexiFit™ Technology provides a comprehensive choice of entry points for electric cable and plumbing, to match up with existing positions and connections.

There are 8 entry points for plumbing and 6 for electric cable. If existing wiring is on the left or the right hand side the Aqua 3500M can match up. It has electric terminal connections and water inlet connections on both sides!

**Easy installation and replacement with Galaxy FlexiFit™ Technology**

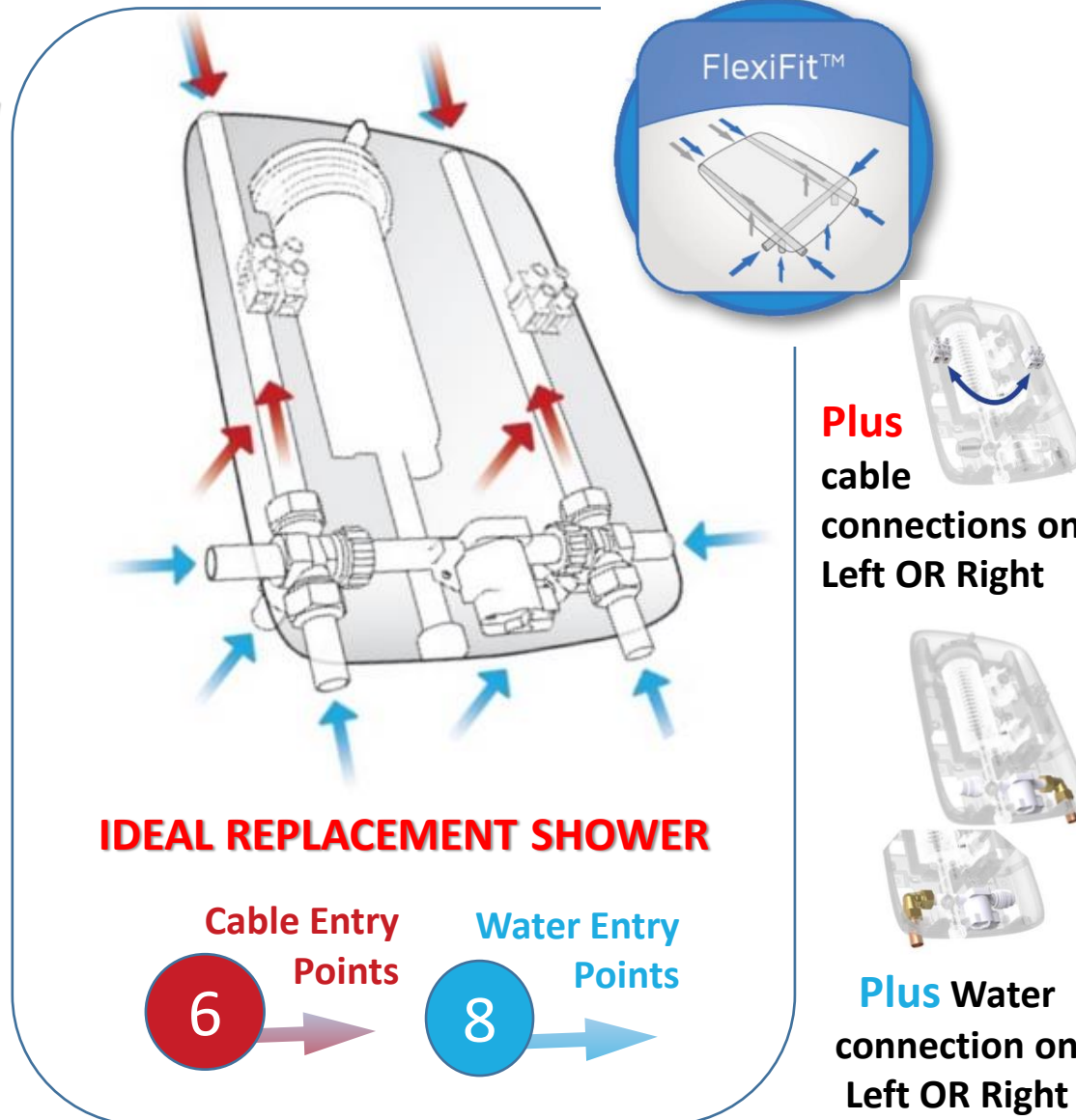

Looks great everywhere...

**Aqua 3500M**  
Electric Shower

# FLEXIBLE CONNECTION POSITIONS FOR PLUMBING & WIRING



**FlexiFit™ Technology**  
for multiple installation permutations.  
Quick and easy installation; from box to fixed on wall, in no time at all.

**Aqua 3500M**  
Electric Shower

**Electric and plumbing connections on either side of the shower!**

If you're replacing an existing shower the Galaxy Aqua 3500M is an installer's dream. The twin electric terminals allow connections to the right or to the left of the shower.

There are also twin water inlet connections, just connect to the one which matches with your existing plumbing.

So with multiple entry positions and a choice of supply connection positions, the Galaxy Aqua 3500M with **FlexiFit™ Technology** can easily replace any existing electric shower.



## FlexiFit™ Technology

### ELECTRICS

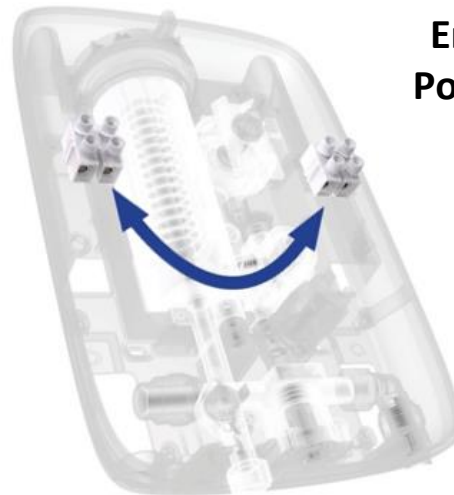

6 Cable Entry Points

**A terminal block is situated on both the left and right hand side of the shower, enabling the installer to connect the electrical wiring to either side**

### PLUMBING



8 Water Entry Points

**There are two water inlet connections, one on each side, so just connect to the one which best matches with your plumbing.**

# FLEXIBLE FIXING POSITIONS AND EASY ADJUSTMENT



## SlideFit™ Wall Bracket:

*No need to drill new holes in your bathroom to replace the riser rail kit. With the Galaxy Aqua riser rail kit the bracket at the bottom can simply be screwed into an existing wall fixing. The riser rail is then inserted into it. Finally the top bracket fixing slides over the rail and down until it meets up with the existing fixing hole in the wall/tile.*

*The Galaxy Aqua 3500M shower rail kit is quick and easy to fit; it can even re-use existing wall fixing holes for minimal disruption to your bathroom.*



## Multi-Function Showerhead:

*The extra durable rubber nozzles of the Galaxy showerhead reduce lime scale build up to keep your showerhead in full working condition. What's more there are six spray patterns to choose from to suit your own showering preferences.*

## Easy Adjust Showerhead Holder:

*A simple one handed press of the unique easy adjust showerhead holder allows movement up or down the riser rail. The showerhead bracket can be angled forward to change the projection of the water. Perfect for different showering requirements from multiple users.*

# Galaxy



- **Anti-Scale Showerhead**
- **6 Spray Patterns**  
- a choice to suit every showering mood.

**Aqua 3500M**  
Electric Shower



**A SHOWERING EXPERIENCE TO MEET WHATEVER YOUR DAY REQUIRES**



Fresh



Ecstasy



Excite



Tranquil



Sensual



Allure



Some days we require a **Fresh** boost to get us going; other days we come home and need a soothing **Tranquil** shower experience to unwind and ease the day away. The Galaxy Aqua 3500M has a 6 pattern showerhead to gives you this and much more too...

# Galaxy



**Made In Britain**

**Factory Staff and Support  
Team at Our Peterborough  
Head Office**

**Aqua 3500M**  
*Electric Shower*



**Box contents:**

- 1 x electric shower*
- 1 x riser rail kit and soap dish*
- 1 x 1.25m anti kink hose*
- 1 x single mode shower head*
- 1 x set of raw plugs*
- 1 x compression fitting*

*1 x instruction manual and user guide*

*Unit Dimensions: H:335 x W:225 x D:106mm*

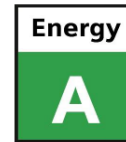

# Galaxy



Galaxy Showers,  
Newcombe House,  
Newcombe Way,  
Peterborough. PE12 6SE

01733 456789  
[www.galaxyshowers.com](http://www.galaxyshowers.com)

**Aqua 3500M**  
Electric Shower