

AIR PURIFIER

KOIOS



INSTRUCTION MANUAL

INSPIRE BRIGHTER LIVING

WARRANTY

- Your product is guaranteed by us for 12 months from your original date of purchase. If you want to extend your warranty for two more year, please do not hesitate to contact us.
- Become a KOIOS member and get access to exclusive benefits, such as updates about the latest KOIOS products.

1. Share your experience by leaving an honest review.



Please leave a review with accompanying photos or a video would be greatly appreciated!

 Add photos/video

Submit

2. CONTACT US

Please scan the QR-code to start chatting (Live chat).

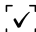

 SCAN ME

or visit: m.me/KoiosShop

or

warranty.koiosshop.com

Thank you for choosing this product. In order to understand how to properly use this product, please read this instruction manual carefully before using the product, and retain it for future use. In the event that you need assistance using the appliance, please contact our customer service.

1 WARNINGS

WARNING

- This air purifier is for indoor use only.
- Only use this appliance together with the supplied power adapter. If used with other adapters, it may not work properly or it may get damaged.
- Before connecting the appliance to a power supply, first confirm whether the voltage marked on the power adapter matches your household mains voltage.
- This product is not intended for use by children, the aged, or disabled persons.
- You must unplug the power cord when cleaning or moving the appliance.
- When removing the plug from the plug socket, always grasp the plug, and do not remove by pulling the power cord.
- Do not use this product if the power cord, plug or appliance is damaged, or if the product is not working properly.
- Do not touch the power cord with wet hands.
- Ensure the power outlet meets the electrical requirements of this product.
- Do not allow the appliance to get wet or use it in high-temperature environments.
- Do not use near fire, and do allow the inhalation of flammable gases or cigarette smoke.
- Do not disassemble the appliance by yourself. For support, contact customer service by email at: support@koiosshop.com

PURIFICATION FUNCTIONS

Removes dust, mites and pollen.

Removes smoke.

Removes allergens.

Removes decoration odors (formaldehyde, benzene etc).

Deodorizes and effectively removes indoor PM2.5 particles to purify the air and create a fresh living space.

3 SAFETY PRECAUTIONS

SAFETY PRECAUTIONS

- Do not place anything on the product.
- Do not use without filter.
- During using, please do not cover the air inlet and outlet, and do not stick your finger or place any objects into the air inlet and outlet.
- Do not let water to enter inside the unit when cleaning the product.
- Do not tip or spray any liquid or spray on the product or specialized filters.
- In order to ensure the purification effect, you should change the filter atleast once every six months. To ensure the purification efficiency, please check and replace the filter periodically according to the actual environment and conditions.
- The filter can not be washed.
- When replacing the filter, please make sure the power plug and socket are disconnected.
- This purifier filter in accordance with the relevant national environmental standards, please put the replacement filter into the returnable waste box.

Thank you for choosing KOIOS! In order to provide you excellent support, please read this user manual carefully before using this appliance, and keep it for future reference.

PRODUCT FEATURES

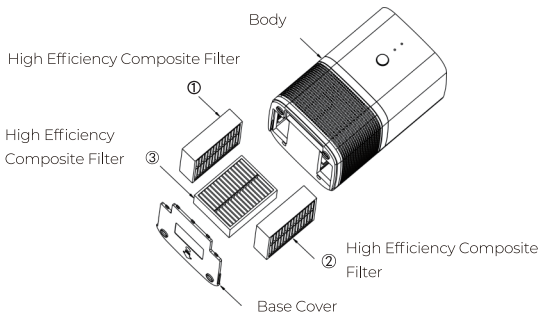

- Compact design;
- Simple operation;
- Sleek alloy button.



5 3 PURIFICATION MODULES

3 PURIFICATION MODULES



Primary filter: The primary filter is equipped with antibacterial cotton, which helps to remove dust, hair and other large particles of impurities and bacteria.

Carbon Filter: At room temperature, and by using high-quality activated carbon, it efficiently absorbs formaldehyde, benzene, VOCs, odors and other pollutants.

Efficient HEPA Filter: Removes 97% of particles above 0.3 μm microns in diameter; at the same time it removes PM2.5, gases, pollen, mites and other pollutants.

ATTENTION

1. Insert the air purifier power adaptor (DC 12V) into the power socket.
2. Do not use if the power or plug socket is damaged, or if the body of the appliance is damaged, or not working properly.
3. Do not touch the power cord with wet hands.

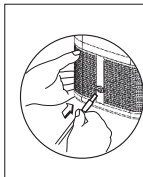

1. Insert the power adaptor connector into the air purifier.

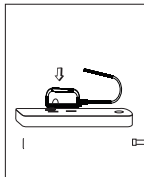

2. Plug the power adaptor into a power socket.

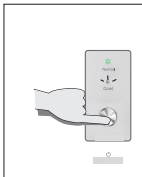

3. Tap the power button to turn on the air purifier.

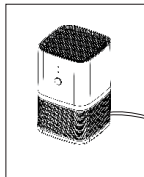

4. The air purifier is now operating.

7 OPERATION INSTRUCTIONS

POWER ON AND OFF STATE

Control panel function



POWER

1. Press the power button once and the air purifier will be in quiet mode.
2. Press again, and it will enter normal mode.
3. Press a third time, and the air purifier will turn off.

CLEANING NOTE

1. The filter can not be washed.
2. We recommend that you change the filter at least once every six months.
3. Please use a soft cloth to clean the unit.
4. Do not use water or corrosive detergents to clean the appliance.
5. The top outlet can be cleaned with a small soft brush.
6. After cleaning, reassemble all parts, plug in and then turn it on.

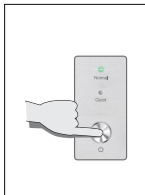

1. Tap the power button to turn off and then unplug the appliance.

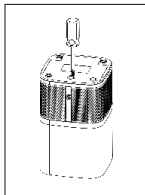

2. Use a screwdriver to remove the base cover.

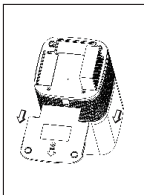

3. Slide the base cover out

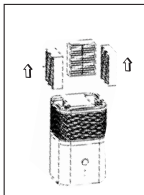

4. Remove the three filters in turn, insert the new filters, and reinstall the base cover.

9 PRODUCT INFORMATION SHEET

PRODUCT INFORMATION SHEET

	Product Model	PM1220
Specifications	Nomianal Voltage	12V ===
	Nominal Power	3.5W
	Net Weight	1.7Kg (including adapter)
	Unit Size	160*160*262 (mm)

Executive Standard:

GB4706.1-2005 Safety of household and similar electrical appliances - Part

1: General requirements

GB 4706.45-2008 Safety of household and similar electrical appliances -

Particular requirements for air purifiers

GB/T 18801-2008 Air purifiers

Manufacturers statement:

This appliance's appearance and configuration may differ from what is described in this manual.

TROUBLESHOOTING

Problem	Resolution
The appliance doesn't turn on	<ul style="list-style-type: none">• Check that the appliance is connected to the power supply.• Check that the appliance power cord is connected properly.• Make sure that the appliance is turned on.• Check the filter cover is installed properly.
Fan not operating properly	<ul style="list-style-type: none">• Check if the power cord is connected properly.• Check the body of the appliance to determine no objects are blocking the air inlet/outlet.• Replace the filters if they are dirty or in a poor condition.• Contact customer service if you still cannot resolve the issue.
Power button cannot sense touch	<ul style="list-style-type: none">• Check that the appliance is properly connected to power• .Contact customer service if the problem still cannot bere solved.

11 TROUBLESHOOTING

Replacement filter issues	<ul style="list-style-type: none">• Check the model number on the filter to see if this is the correct filter for this air purifier.• Please make sure the filter is inserted correctly.• Please make sure there are no foreign objects clogging the filter openings.
The air output is significantly low	<ul style="list-style-type: none">• Please check the body of the appliance to check that no objects are blocking the air inlet/outlet.• Please confirm the condition of the filter. If the filter is too dirty, replace with a new filter.
Base cover cannot be installed properly	<ul style="list-style-type: none">• Please check that the rear cover is installed in the correct way.

This device complies with part 15 of the FCC Rules. Operation is subject to the following two conditions: (1) This device may not cause harmful interference, and (2) this device must accept any interference received, including interference that may cause undesired operation.

CUSTOMER SERVICE

Our customer service team is standing by to assist you if you have any questions or concerns.



Scan the QR-code to start chatting (live chat):



Scan QR Code & Start Chatting



SCAN ME

Or visit:

m.me/KoiosShop



**24/7 LIVE CHAT
SUPPORT**

1-855-888-2111

support@koiosshop.com

www.koiosshop.com



koiosshop.com



Made in China